

Plat of Survey

of

Lot 30 of Glen Oaks of Delavan,

a subdivision located in the Southwest 1/4 of the Northeast 1/4 of Section 13,
Town 2 North, Range 15 East, City of Delavan, Walworth County, Wisconsin.

Surveyed for: **Henry Keizer**
W7942 Creek Road
Delavan, Wisconsin. 53115

Survey Date: May 13, 2020.

Revisions:

Scale in Feet
1" = 20'



45 South Wisconsin Street | P.O. Box 322
Elkhorn, Wisconsin. 53121
Telephone: (262) 723-3434
Facsimile: (262) 723-8044
Email: doug@olsonsurveying.com
Website: www.olsonsurveying.com



Legend of Symbols & Abbreviations	
N	North
S	South
E	East
W	West
B	Bearings
M	Minutes
S	Seconds
F	Feet
I	Inches
Found County Section Corner	
Found Iron Pipe, 2" dia.	
Found Iron Pipe, 1" dia.	
Recorded Information	
Utility Pedestal	Light Pole
Catch Basin	Manhole
Water Valve	Hydrant
Asphalt Surface	Concrete Surface

Sheet 1 of 1 Sheets
Drawing Name
Job Reference Number
2020.039

2020.039

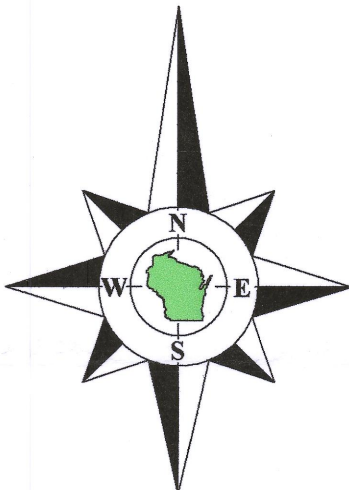

Bearings referenced to the South line of the Northeast 1/4 of Section 13-2-15,
recorded as N87°25'38"E in the Wisconsin State Plane Coordinate System,
South Zone, (NAD-27).

Coordinates are referenced to the Wisconsin State
Plane Coordinate System, South Zone, (NAD-27).

Copyright ©2020 by Olson Land Surveying, LLC.

All rights reserved. No part of this survey plat may be reproduced or transmitted in
any form by any means - graphic, electronic, or mechanical, including photocopying,
tracing, or information storage and retrieval systems - without permission in writing
from Douglas G. Olson, Olson Land Surveying, LLC.

I hereby certify that I have surveyed the above described property in compliance
with Chapter A-E 7 of the Wisconsin Administrative Code and that the map hereon is
correct to the best of my professional knowledge and belief and shows the size and
location of the property, its exterior boundaries, the location and dimensions of all
visible structures thereon, boundary fences, apparent easements and roadways and
visible encroachments, if any.

This survey is made for the exclusive use of the present owners of the property,
and also those who purchase, mortgage or guarantee title thereto, within one year from
the date hereof.

Douglas G. Olson
Wisconsin Professional Land Surveyor - 2093

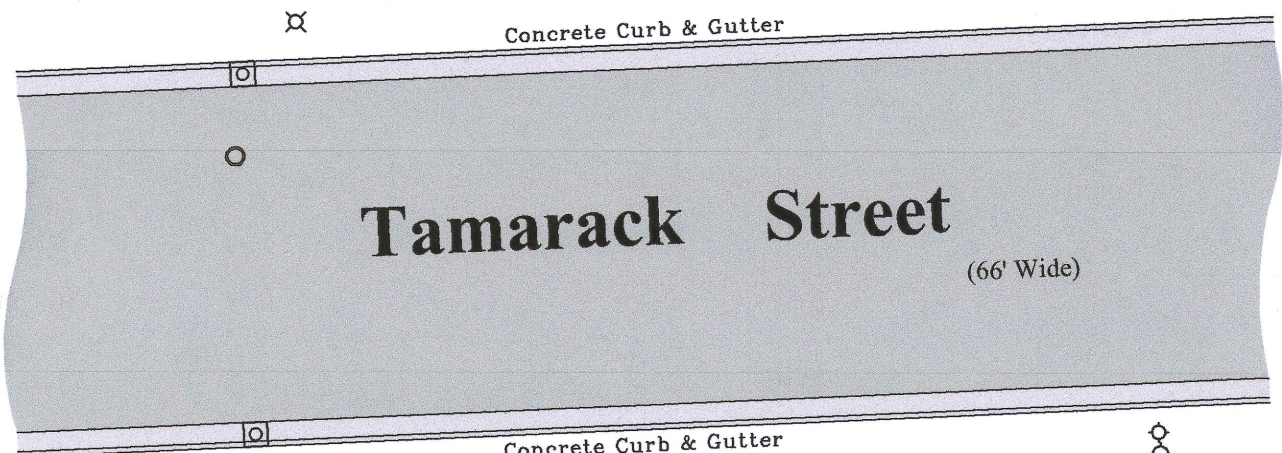

recorded as(N87°25'57"E 1382.84')
N87°25'57"E 1383.03'

923.67'
(923.48')

recorded as(N87°25'57"E 94.40')
N87°25'57"E 94.40'

Sidewalk

recorded as(N2°34'22"W 122.00')
N2°32'05"W 122.01'

Lot 30
Tax Parcel
XGLE 00030
0.264 Acre
11,514 Sq.Ft.

recorded as(S2°30'48"E 122.00')
S2°30'48"E 122.00'

Timber 1.1'
W. of line

Utility Easement
As shown on the plat of
Glen Oaks of Delavan

12'

49.98'
S87°25'38"W 94.35'
recorded as(S87°25'38"W 94.40')

44.37'

N87°25'38"E 2617.28'
recorded as(N87°25'38"E 2617.25')State Plane

East 1/4 Corner
Section 13-2-15
N. 233,555.19
E. 2,360,882.26

Lot 1
C.S.M. 4435

W. Gordon
Yadon Park

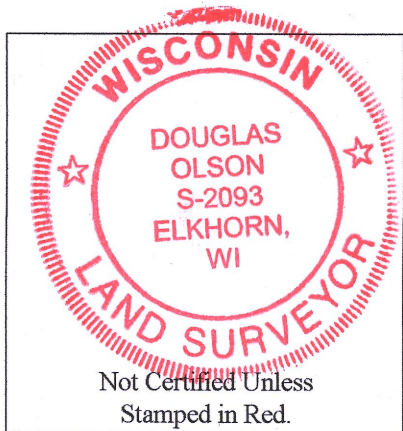

Notes:

- 1) This Plat of Survey is not certified unless signed and sealed in red ink.
- 2) This survey is subject to Wisconsin lien laws. This Plat of Survey is the notice of intent to file lien. Lien waiver required.
- 3) The Survey Date shown on this Plat of Survey is the completion date of the field work.

Whispering pines

XGLE-20

002-2704