

Plat of Survey

of

Lot 29 of The Fields of Delavan West,

a subdivision located in the Northwest 1/4 of the Southwest 1/4 of Section 13,
Town 2 North, Range 15 East, City of Delavan, Walworth County, Wisconsin.

Surveyed for: **Allison Murray**
W3776 Kelly Road
Lake Geneva, Wisconsin. 53147

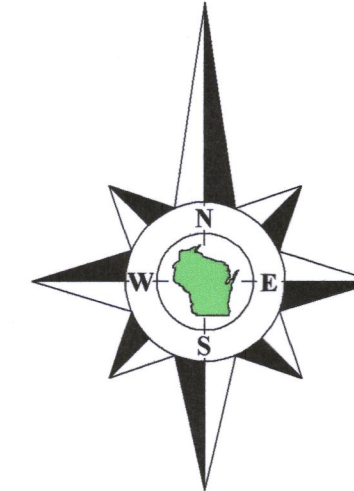

Bearings referenced to the West line of Cedar Avenue, recorded as N1°19'38"W on the plat of The Fields of Delavan West, which is recorded as being in the Wisconsin State Plane Coordinate System, South Zone, (NAD-27).

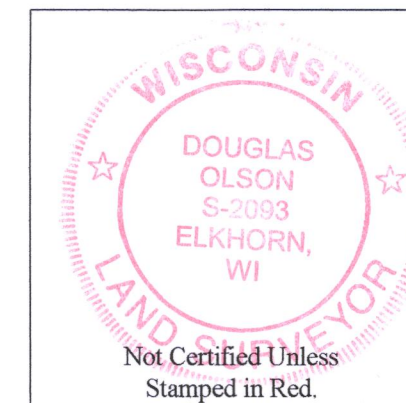

Notes:

- 1) This Plat of Survey is not certified unless signed and sealed in red ink.
- 2) This survey is subject to Wisconsin lien laws. This Plat of Survey is the notice of intent to file lien. Lien waiver required.
- 3) The Survey Date shown on this Plat of Survey is the completion date of the field work.
- 4) House and setback dimensions are measured to the siding which overhangs the foundation.

Copyright ©2018 by Olson Land Surveying, LLC.

All rights reserved. No part of this survey plat may be reproduced or transmitted in any form by any means - graphic, electronic, or mechanical, including photocopying, tracing, or information storage and retrieval systems - without permission in writing from Douglas G. Olson, Olson Land Surveying, LLC.

I hereby certify that I have surveyed the above described property in compliance with Chapter A-E 7 of the Wisconsin Administrative Code and that the map hereon is correct to the best of my professional knowledge and belief and shows the size and location of the property, its exterior boundaries, the location and dimensions of all visible structures thereon, boundary fences, apparent easements and roadways and visible encroachments, if any.

This survey is made for the exclusive use of the present owners of the property, and also those who purchase, mortgage or guarantee title thereto, within one year from the date hereof.

Douglas G. Olson
Wisconsin Professional Land Surveyor - 2093



Tax Parcel
BD 1300006

Survey Date: March 2, 2020.
Revisions:

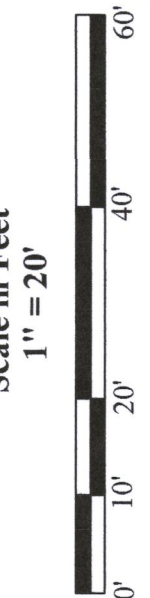

45 South Wisconsin Street | P.O. Box 322
Elkhorn, Wisconsin. 53121
Telephone: (262) 723-3434
Facsimile: (262) 723-8044
Email: doug@olsonsurveying.com
Website: www.olsonsurveying.com

OLSON
LAND SURVEYING, LLC
Rural | Residential | Commercial

Legend of Symbols & Abbreviations

Found Iron Rod, 1-3/16" dia.	N	North
Found Iron Rod, 3/4" dia.	E	East
Set Wood Stake, 08-19-18	S	South
Light Pole	W	West
Utility Pole	B	Bearing
Utility Pedestal	M	Minutes
Fire Hydrant	S	Seconds
Utility Warning Sign as noted	F	Feet
Asphalt Surface	I	Inches
Concrete Surface		

Sheet 1 of 1 Sheets
Drawing Name:
Job Reference Number
2018.098

2018.098