

GEORGE T. DUNHAM
SURVEYING & SUBDIVIDING
DELAVER, WISCONSIN

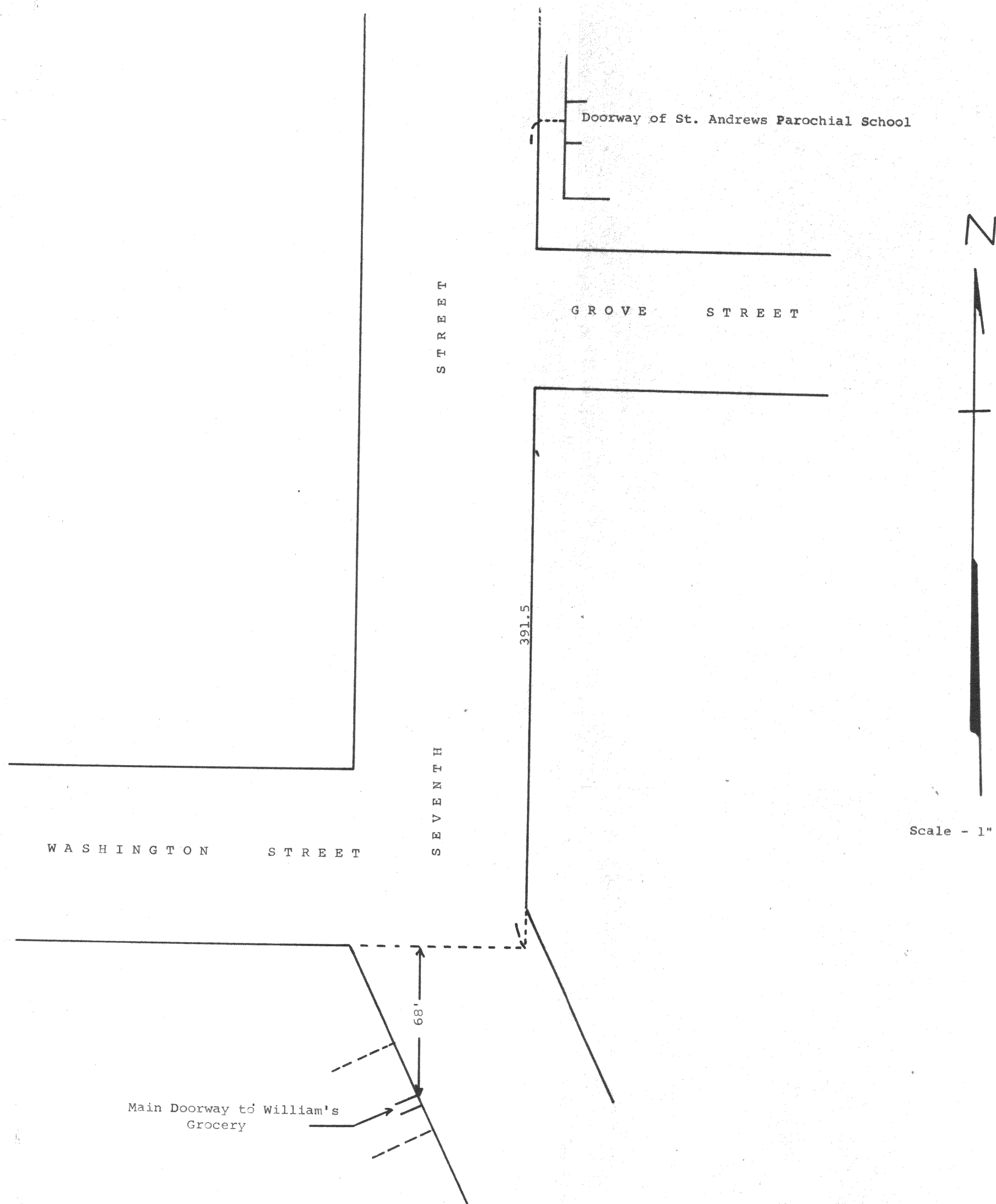

Sketch showing the approximate distances between William's Grocery located in Block 8 of Passage, Aram, & Downie Addition to the City of Delavan and St. Andrews Parochial School located in the Subdivision of Block 16 of Passage, Aram, & Downie Addition to the City of Delavan, Walworth County, Wisconsin. February 26, 1966

George T. Dunham
George T. Dunham, Wis. Land Surveyor No. S-306