

# ALTA/ACSM Land Title Survey

Lot 6 in Delavan Crossings, a subdivision of part of the Southwest quarter and part of the Southeast quarter of Section 16, all in Township 2 N., Range 16 E., City of Delavan, County of Walworth, State of Wisconsin pursuant to the plat thereof recorded as Document No. 489594 with the Recorder of Walworth County, Wisconsin. Also easements contained in the "ECR" recorded as Document No. 493771, as amended by the First Amendment to Easements with Covenants and Restrictions Affecting Land dated as of June 30, 2003 and recorded on July 1, 2003 as Document No. 563742, and the Second Amendment to Easements with Covenants and Restrictions Affecting Land dated September 16, 2003 and Recorded November 11, 2003 as Document No. 583408, and the Third Amendment to Easements with Covenants and Restrictions Affecting Land dated January 27, 2005 and Recorded January 27, 2005 as Document No. 630012.

7. Easement from George W. Borg to Wisconsin Power and Light Company dated June 24, 1958 and recorded in the office of the Register of Deeds for Walworth County, Wisconsin on February 5, 1959 in Volume 535 of Deeds on page 479 as Document No. 506993.                      SHOWN

9. Sewer Main Easement by and between Bank of Wisconsin, Trustee of the Harold W. Ziilisch Revocable Trust dated July 18, 1984 and the Village of Williams Bay, a municipal corporation dated December 13, 1985 and recorded in the Register of Deeds Office in and for Walworth County, Wisconsin on May 6, 1986 in Vol. 367 of Records on page 269 as Document No. 128285. Said easement assigned to Walworth County Metropolitan Sewerage District by document recorded August 4, 1988 in Vol. 436 of Records on page 115 as Document No. 166141.

11. Easement from Airport 43 Limited Partnership, an Illinois limited partnership to Wisconsin Bell, Inc., dated June 17, 1992 and recorded in the office of the Register of Deeds for Walworth County, on January 8, 1993 in Volume 606 of Records on page 800 as Document No. 249310. SHOWN

13. Development Agreement by and between the City of Delavan, a municipal corporation, and Household Finance Corporation, III, a Delaware corporation, dated October 9, 2001 and recorded in the office of the Register of Deeds for Walworth County, Wisconsin on November 21, 2001 as Document No. 490207. Existing improvements & drives on and adjacent to subject parcels SHOWN

15. Easements with Covenants and Restrictions Affecting Land made by and among Wal-Mart Real Estate Business Trust, a Delaware business trust, Kohl's Department Stores, Inc., a Delaware corporation, Household Financial Corporation, a Delaware corporation, and Delavan Crossings Association Inc., a Wisconsin corporation, recorded December 20, 2001 as Document No. 493771, as amended by the First Amendment to Easements with Covenants and Restrictions Affecting Land dated as of June 30, 2003 and recorded on July 1, 2003 as Document No. 563742 and the Second Amendment to Easements with Covenants and Restrictions Affecting Land dated September 16, 2003 and Recorded November 11, 2003 as Document No. 583408, and the Third Amendment to Easements with Covenants and Restrictions Affecting Land dated January 27, 2005 and Recorded January 27, 2005 as Document No. 630012. Existing improvements & drives on and adjacent to subject parcels SHOWN

17. Restrictive Covenant Agreement by and between Household Finance Corporation III, a Delaware corporation, and Chili's of Wisconsin, Inc., a Wisconsin corporation, recorded in the office of the Register of Deeds for Walworth County, Wisconsin on September 16, 2003 as Document No. 575830. NOT PLOTTABLE

19. Reciprocal Easement Agreement by and between Household Finance Corporation III and J.G. Properties, L.L.P., an Iowa limited liability partnership, recorded in the office of the Register of Deeds for Walworth County, Wisconsin on May 16, 2005 as Document No. 639999. Existing improvements & drives on and adjacent to subject parcels SHOWN

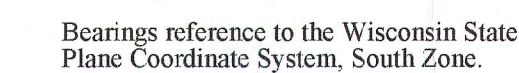
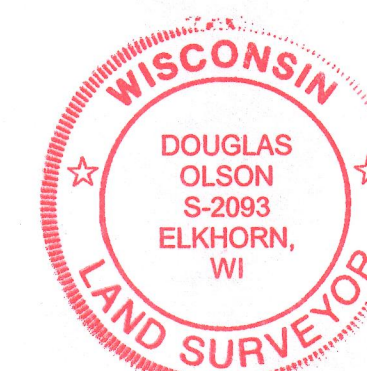

1. According to Flood Insurance Rate Map (FIRM) No. 55127C0190D for the City of Delavan, Effective date: October 2, 2009, this site falls in Zone X: Areas determined to be outside the 0.2% annual chance floodplain.

- To: 1905 Geneva, LLC, an Illinois limited liability company  
Chicago Title Insurance Company  
Schaumburg Bank & Trust Company N.A. it's successors and or assigns

February 11, 2016.

Xdc-6

002-2606

# Olson Land Surveying, LLC

Wisconsin Street \* P.O. Box 322 \* Elkhorn, Wisconsin. 53121  
Telephone: (262) 723-3434 \* Facsimile: (262) 723-8044  
Email: [doug@olsonsurveying.com](mailto:doug@olsonsurveying.com)

## Legend

■	Found Iron Rod	M.U.E.	Municipal Utility Engineering
×	Found Chiseled Crosscut	P.U.E.	Public Utility Engineering
□	Recorded Information	B	Basement
□	Utility Postal on Transformer		
□	Catch Basin	○	Manhole
□	Fire Hydrant	○	Water Valve
□	Asphalt Surface	○	Valver
□	Concrete Surface	○	Water
□	Brick Pavers	○	Utility Sign
□	Stand Pipe		

Name: \_\_\_\_\_

Sheet 1 of 1 Sheets

**Job Reference Number**  
**2016.008**

2016.008