

Plat of Survey

of

Lot 8 of Wright's Subdivision,

located in the Northeast 1/4 of Section 17, Town 2 North, Range 16 East, City of Delavan, Walworth County, Wisconsin.

Surveyed for: **The Rauland Agency, Inc.**

118 Kenosha Street
Walworth, Wisconsin. 53184

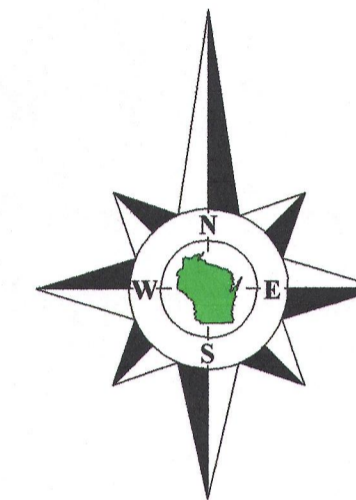

Bearings reference to the plat
of Wright's Subdivision.

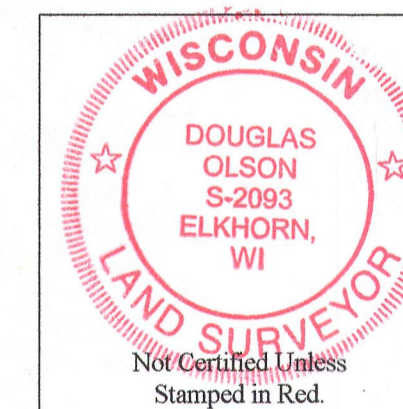
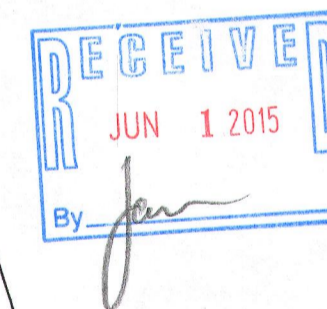

Notes:

- 1) This survey plat is not certified unless signed and sealed in red ink.
- 2) This survey is subject to Wisconsin lien laws. This Plat of Survey is the notice of intent to file lien. Lien waiver required.

Copyright 2014 by Jensen & Olson Land Surveying, LLC.

All rights reserved. No part of this survey plat may be reproduced or transmitted in any form by any means - graphic, electronic, or mechanical, including photocopying, tracing, or information storage and retrieval systems - without permission in writing from Douglas G. Olson, Jensen & Olson Land Surveying, LLC.

I hereby certify that I have surveyed the above described property and the map hereon is correct to the best of my professional knowledge and belief and shows the size and location of the property, its exterior boundaries, the location and dimensions of all visible structures thereon, boundary fences, apparent easements and roadways and visible encroachments, if any.

This survey is made for the exclusive use of the present owners of the property, and also those who purchase, mortgage or guarantee title thereto, within one year from the date hereof.

Douglas G. Olson
Wisconsin Registered Land Surveyor - 2093

Survey Date: September 17, 2014
Revisions:

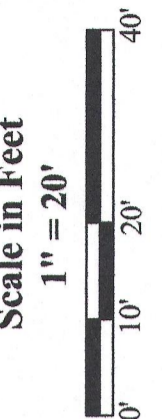

Jensen & Olson Land Surveying, LLC

45 South Wisconsin Street * P.O. Box 322 * Elkhorn, Wisconsin. 53121
Telephone: (262) 723-3434 * Facsimile: (262) 723-8044
Email: jensen.olson@elknet.net

Legend
 Found Concrete Monument
 Found Iron Pipe
 Recorded Information
 Utility Pole
 Utility Box or Pedestal
 Manhole
 Catch Basin
 Asphalt Surface
 Concrete Surface

Sheet 1 of 1 Sheets
 Drawing Name:
 Job Reference Number
2014.107

2014.107

xw8-8 002-2579