

Plat of Survey

of
A parcel of land described in a Sheriff's Deed recorded April 21, 2014 as Document No. 883552, as shown below:

A parcel of land located in Lots 22 & 23, Block 14 of the Original Plat, City of Delavan, Walworth County, Wisconsin described as follows: Beginning at the Northwest corner of Lot 22, thence East along North line 96.15 feet, thence South 66 feet to a point on the North line of Lot 23, located 76.40 feet East of the Northwest corner of Lot 23, thence continue South 66 feet to a point on South line of Lot 23, thence West 56.65 feet to the East line of Terrace Street; thence Northwesterly along the East line of Terrace Street 137.68 feet to the place of beginning.

Surveyed for: **Walworth State Bank**
105 North Highway 67
Walworth, Wisconsin. 53184

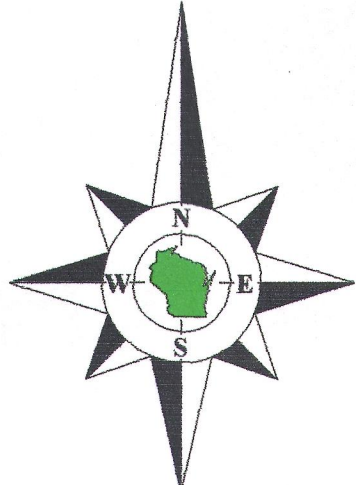

Bearings reference to the South line of Lot 23 recorded as S89°57'W on previous surveys of record.

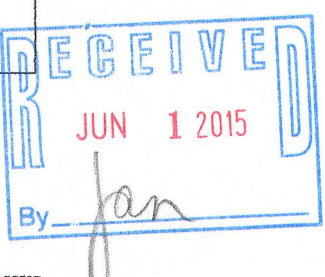
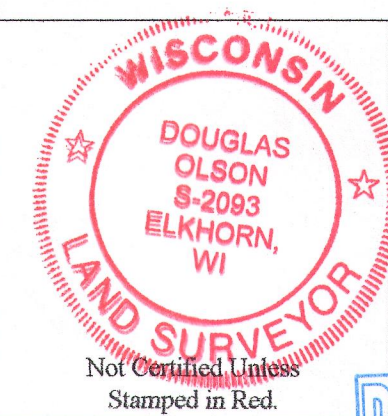

- Notes:**
- 1) This survey plat is not certified unless signed and sealed in red ink.
 - 2) This survey is subject to Wisconsin lien laws. This Plat of Survey is the notice of intent to file lien. Lien waiver required.

Copyright 2014 by Jensen & Olson Land Surveying, LLC.

All rights reserved. No part of this survey plat may be reproduced or transmitted in any form by any means - graphic, electronic, or mechanical, including photocopying, tracing, or information storage and retrieval systems - without permission in writing from Douglas G. Olson, Jensen & Olson Land Surveying, LLC.

I hereby certify that I have surveyed the above described property and the map hereon is correct to the best of my professional knowledge and belief and shows the size and location of the property, its exterior boundaries, the location and dimensions of all visible structures thereon, boundary fences, apparent easements and roadways and visible encroachments, if any.

This survey is made for the exclusive use of the present owners of the property, and also those who purchase, mortgage or guarantee title thereto, within one year from the date hereof.

Douglas G. Olson
Wisconsin Registered Land Surveyor - 2093

Survey Date: July 30, 2014.
Revisions:

Scale in Feet
1" = 20'
0' 10' 20' 40'

Jensen & Olson Land Surveying, LLC

45 South Wisconsin Street * P.O. Box 322 * Elkhorn, Wisconsin. 53121
Telephone: (262) 723-3434 * Facsimile: (262) 723-8044
Email: jensen.olson@elknet.net

Sheet 1 of 1 Sheets
Drawing Name: C:\16-2014079-201407999at.dwg

Job Reference Number
2014.079

Legend
Found Concrete Monument
Found Iron Pipe
Found Iron Rod
X Set Chiselled Crosscut
() Recorded Information
X Utility Pole
Asphalt Surface
Concrete Surface
Gravel

2014.079

XOP-157 002-2576