

EXISTING LEGAL DESCRIPTION FOR PARCEL NO. XWUP 00103A

EXISTING LEGAL DESCRIPTION FOR PARCEL NO. XWUP 00103B

LEGAL DESCRIPTION FOR LAND TO BE ADDED TO PARCEL NO. XWUP 00103A AND EXCEPTED FROM XWUP 00103B

SURVEY FOR: RENE MENAGER

SURVEY ADDRESSES: 601 & 607 E. WALWORTH AVENUE, DELAVAN, WI 53115

BELL'S SUBDIVISION

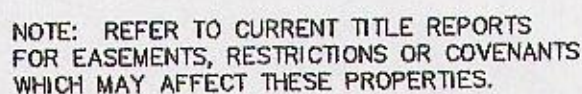

BEARINGS HEREON RELATE TO THE NORTH
RIGHT-OF-WAY LINE OF WALWORTH AVENUE
LYING BETWEEN THE EAST LINE OF FIFTH STREET
AND THE WEST LINE OF SEVENTH STREET.
ASSUMED BEARING OF WEST AS DEEDED.

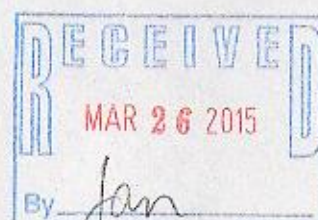
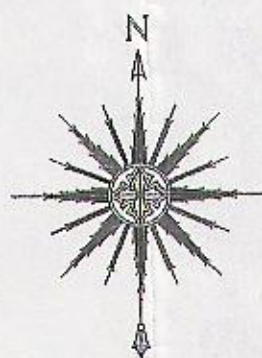

THIS IS NOT AN ORIGINAL PRINT
UNLESS THIS SEAL IS RED.

Thomas Z. Satter

"I HEREBY CERTIFY THAT I HAVE SURVEYED THE ABOVE DESCRIBED PROPERTY AND THAT THE ABOVE MAP IS A CORRECT REPRESENTATION THEREOF AND SHOWS THE SIZE AND LOCATION OF THE PROPERTY, ITS EXTERIOR BOUNDARIES AND ROADWAYS."

"THIS SURVEY IS MADE FOR THE USE OF THE PRESENT OWNERS OF THE PROPERTY, AND THOSE WHO PURCHASE, MORTGAGE, OR GUARANTEE THE TITLE THERETO WITHIN ONE YEAR FROM DATE HEREOF."

SATTER SURVEYING, LLC
LAND SURVEYS, MAPPING AND PLANNING
272 ORIGIN STREET
BURLINGTON, WI 53105
262-661-4239

0 20' 40' 80'

SCALE: 1" = 40'

MARCH 6, 2015
DATE

021510
JOB NUMBER

XWUP-103A

XWUP-103B

002-2570