

ALTA ASCM SURVEY  
PART OF LOT 2 OF C.S.M. 972  
LOCATED IN PART OF SE 1/4 OF SECTION 17,  
TOWN 2 NORTH, RANGE 16 EAST,  
CITY OF DELAVAN, WALWORTH COUNTY, WISCONSIN

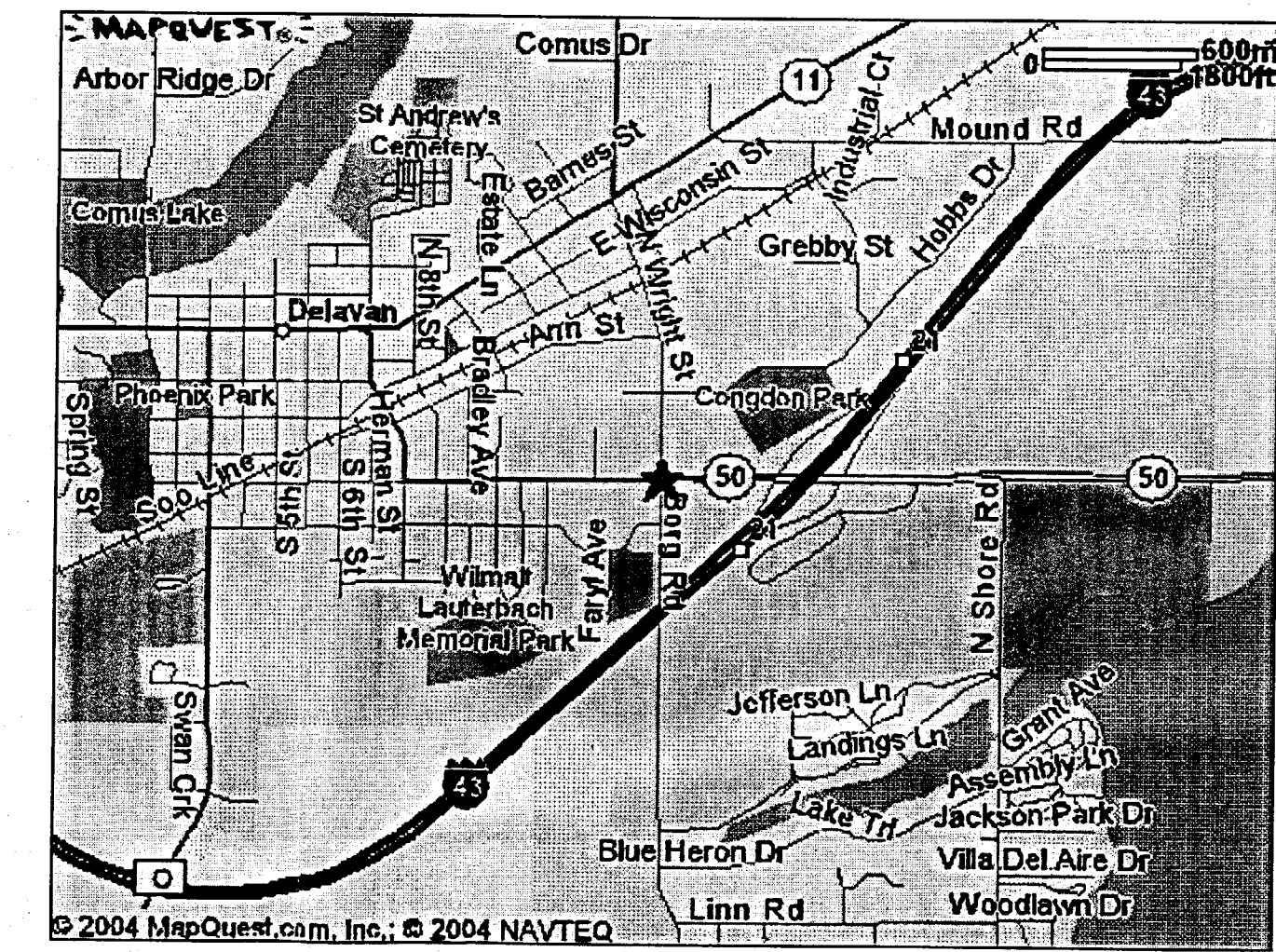

RECEIVED  
SEP 22 2004

3. The land referred to in the Commitment is described as follows:  
A parcel of land located in the Southeast 1/4 of Section 17, Town 2 North, Range 16 East, City of Delavan, Walworth County, Wisconsin containing part of Lot 2 of Certified Survey Map No. 972, said parcel being more particularly described as follows: Commencing at an iron stake found marking the Northwest corner of Lot 1 of Certified Survey Map No. 972; thence S 1° 19' E 887.14 feet along the East right of way line of Wright Street to the point of beginning; thence continue S 1° 19' E along said right of way 213.25 feet to an iron pipe stake found marking the Southwest corner of said Lot 2 of Certified Survey Map No. 972; thence S 82° 15' E along the southerly right of way line of Geneva Street (State Highway 50) 201.27 feet; thence N 1° 19' W 190.70 feet; thence S 88° 41' W 200.00 feet to the point of beginning, and together with an easement for ingress and egress as described in a basement agreement recorded in Vol. 465 of Records on pages 21-31 as Document No. 182193.  
Tax Key No. XA 97200002A

SURVEYOR'S CERTIFICATION

The undersigned hereby certifies to:  
Delavan Partners, LLC  
Chicago Title Insurance Company,

that (a) this plot of survey and the survey on which it was based were made in accordance with "Minimum Standard Detail Requirements for ALTA/ACSM Land Title Surveys" jointly established and adopted by the American Land Title Association and the American Congress on Surveying and Mapping in 1999; meets the accuracy requirements of an urban survey, as defined therein; and includes items 1, 2, 3, 4, 5, 6, 7 (a) and (b)(1)(2), 8, 9, 10, and 11 (a) and (b) of Table A thereof; and (b) this plot of survey and the property description set forth hereon ("Property") was prepared by me, a registered land surveyor in the State of Wisconsin and was actually made upon the ground. In addition, the undersigned hereby certifies that (1) the information, courses and distances shown on this survey are correct, (2) the size, location and type of improvements are shown hereon and are located within the boundaries of the Property and set back from the Property lines the distances indicated, (3) there are no encroachments of any improvements on adjoining property onto the Property, (4) all recorded easements and other exceptions, as noted in the Chicago Title Insurance Company Commitment No. 409217 / ELK, effective date May 11, 2004 have been correctly plotted hereon; (5) the Property constitutes one contiguous parcel without gaps or gaps, and (6) the Property is not located in a 100-Year Flood Plain or in an identified "flood prone area", as defined by the U.S. Department of Housing and Urban Development, pursuant to the Flood Disaster Protection Act of 1973, as amended, as reflected by Flood Insurance Rate Map Panel # 50463 0002E, which such map panel covers the area in which the Property is situated, and (7) proper field procedures, instrumentation, and adequate survey personnel were employed in order to achieve results comparable to those outlined in the Minimum Angle, Distance, and Closure Requirements for Survey Measurements Which Control Land Boundaries for ALTA/ACSM Land Title Surveys.

AUGUST 25, 2004

Dated

PETER S. GORDON  
Registration No. 2101



LEGEND

- = FOUND IRON REBAR STAKE
- = FOUND IRON PIPE STAKE
- ✕ = FOUND CHISELED "X" IN PAVEMENT
- (XXX) = RECORDED AS

SURVEYOR'S NOTES

- 1) DIGGERS HOTLINE WAS REQUESTED TO PROVIDE UNDERGROUND UTILITY FLAGGING PRIOR TO COMMENCEMENT OF THE FIELD SURVEY. THERE WERE NO UTILITY FLAGS EVIDENT ON THE DATE OF THE FIELD SURVEY. HOWEVER A COPY OF RECORD GAS LINE LOCATION WAS PROVIDED. A COPY OF SAID MAP IS ATTACHED AS EXHIBIT "A".
- 2) A PRIOR SURVEY BY ROBERT FARRIS DATED 1989 SHOWED A CITY OF DELAVAN SIGN WHICH IS NO LONGER IN PLACE.
- 3) ADJUST ELEVATIONS +744.41 FEET FOR USGS 1928ADJ VERTICAL DATUM.

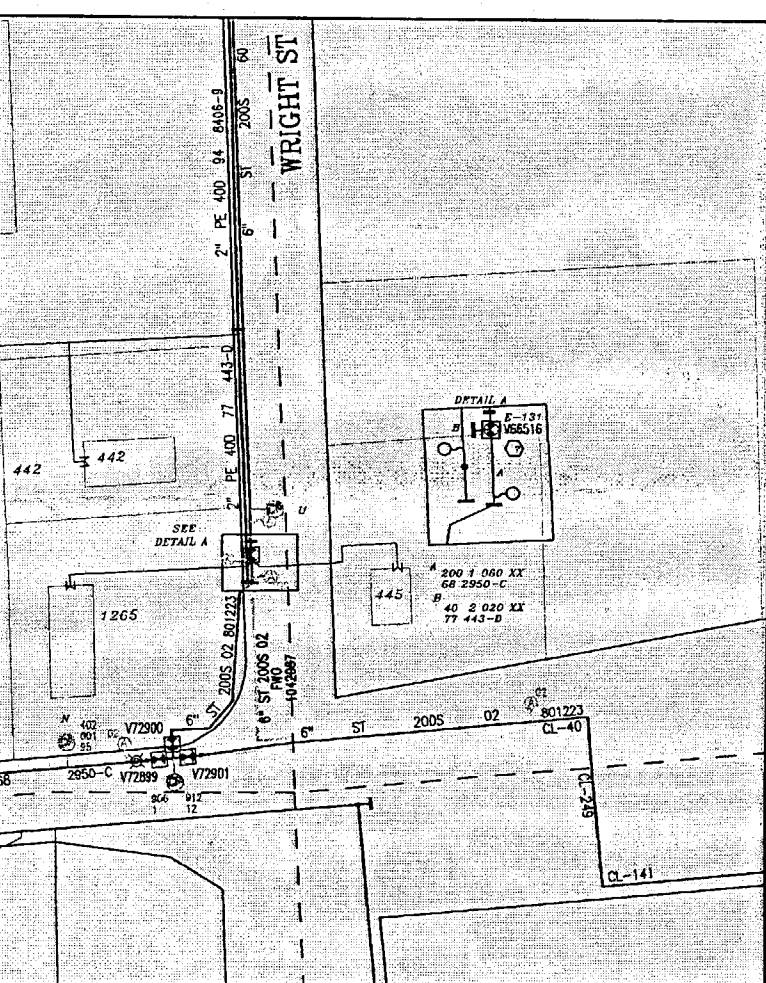

EXHIBIT "A"

