

# PLAT OF SURVEY

LOT 1 OF CERTIFIED SURVEY M.P. 3416  
RECORDED AS DOC. NO. 505584 IN VOL. 9 ON PG. 279-280  
LOCATED IN THE NE 1/4 OF SECTION 18,  
TOWN 2 NORTH, RANGE 16 EAST,  
CITY OF DELAVAN, WALWORTH COUNTY, WISCONSIN

LOT 3  
C.S.M. 3416

LOT 2  
C.S.M. 3416

LOT 1  
C.S.M. 869

LOT 1  
27,137 S.F.

UNPLATTED LANDS

EXISTING  
RESIDENCE

PAVEMENT

THIRD STREET  
82.5' WIDE R.O.W.

WORK ORDERED BY -  
DAVE REDDY  
P.O. BOX 937  
DELAVER, WI 53115

FARRIS, HANSEN & ASSOCIATES, INC.  
ENGINEERING - ARCHITECTURE - SURVEYING  
7 RIDGWAY COURT P.O. BOX 437  
ELKHORN, WISCONSIN 53121  
OFFICE: (262) 723-2098 FAX: (262) 723-5886

REVISIONS  
10/28/2003  
REV. SITE,  
GRADING,  
DRAINAGE &  
EROSION  
CONTROL PLAN

PROJECT NO.  
5183.01  
DATE:  
09/30/03  
SHEET NO.  
1 OF 1

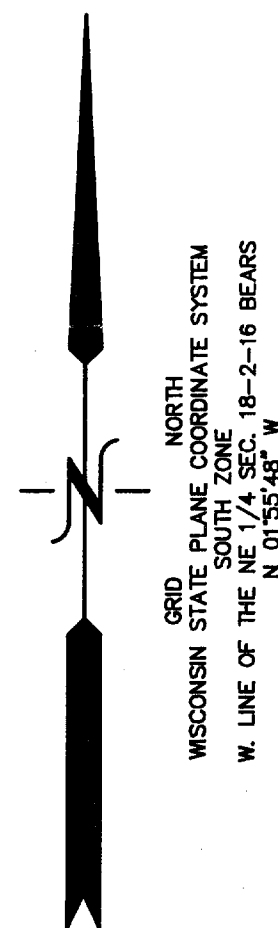

- LEGEND
- = FOUND IRON PIPE STAKE
  - = FOUND IRON REBAR STAKE
  - (XXX) = RECORDED AS

LINE	BEARING	DISTANCE
L1	N 01°37'16" W	4.98
L2	N 88°18'56" E	4.03

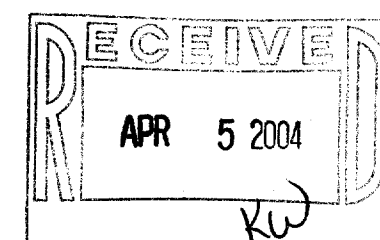
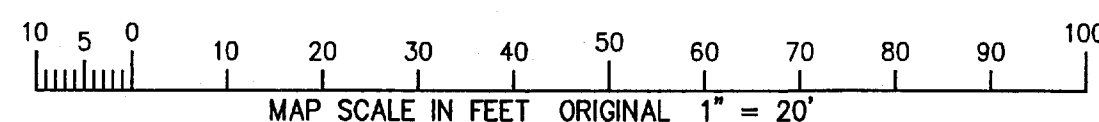

NOTE: COPIES OF THIS MAP TO WHICH THE FOLLOWING CERTIFICATE WILL APPLY SHOW THE SURVEYOR'S ORIGINAL SEAL AND SIGNATURE IN RED INK. COPIES BY ANY OTHER MEANS MAY HAVE ALTERATIONS WHICH DO NOT REPRESENT THE SURVEYOR'S WORK PRODUCT.

I HEREBY CERTIFY THAT THE ABOVE DESCRIBED PROPERTY HAS BEEN SURVEYED UNDER MY DIRECTION AND THAT THE ABOVE MAP IS A TRUE REPRESENTATION THEREOF AND SHOWS THE SIZE AND LOCATION OF THE PROPERTY AND ITS EXTERIOR BOUNDARIES. THIS SURVEY IS MADE FOR THE USE OF THE PRESENT OWNERS OF THE PROPERTY, AND ALSO THOSE WHO PURCHASE, MORTGAGE, OR GUARANTEE THE TITLE THERETO WITHIN ONE YEAR FROM THE DATE HEREOF.

DATED: OCTOBER 28, 2003

PETER S. GORDON R.L.S. 2101

REVISED 03-19-2004  
TO SHOW SIZE &  
LOCATION OF  
ASBUILT RESIDENCE

002-2212