

GEORGE T. DUNHAM
SURVEYING & SUBDIVIDING
DELAVER, WISCONSIN

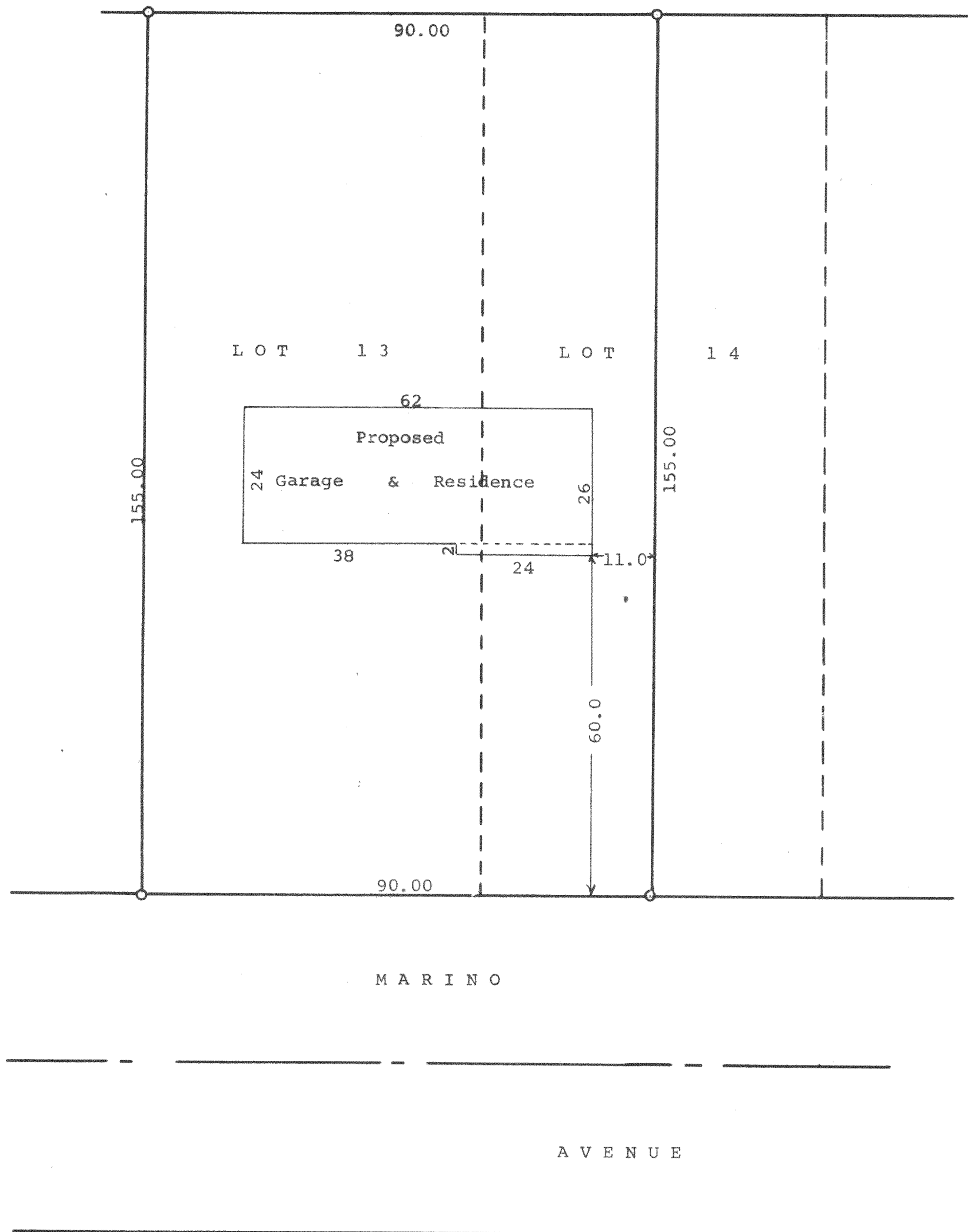

Scale - 1" = 20'
O = Iron Pipe



STATE OF WISCONSIN)
WALWORTH COUNTY) SS

I, George T. Dunham, Surveyor, do certify that I have surveyed the property described as follows,
Lot 13 and the West $\frac{1}{2}$ of Lot 14 of Mar-Del Estates Subdivision located in the City of Delavan, Walworth County, Wisconsin

and that the plat shown above is an accurate survey and a true representation thereof and correctly shows the exterior boundary lines and the location of the proposed residence.
October 1, 1963

George T. Dunham
George T. Dunham, Surveyor