

Northwest corner of Block 3, Sarah A.
Phoenix Addition to the City of Delavan

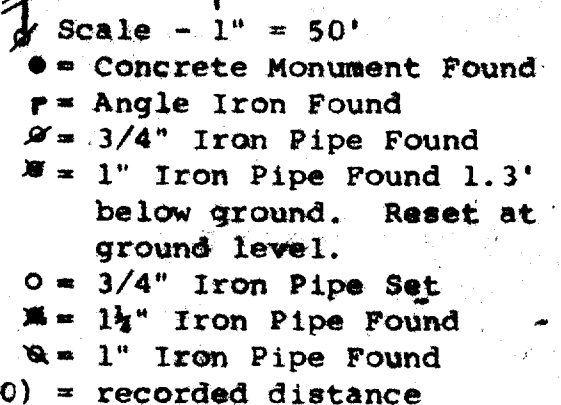

Survey ordered by:
Century 21, Skandia Realty
312 South 7th Street
Delavan, WI 53115

and that the plat shown hereon is a correct representation thereof and shows the size and location of the property, its exterior boundaries, the location of all visible structures and dimensions of all principal buildings thereon, boundary fences, apparent easements, roadways and visible encroachments, if any, and that I have surveyed the property hereon described, according to the official records, to the best of my knowledge and belief.

May 12, 1993

WISCONSIN
LAND SURVEYOR
GEORGE T. DUNHAM
S-306
DELAN VAN
WIS.

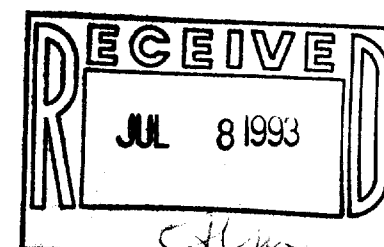

XS-16
X8-16C
XWUP-159

002-1265