

**FURVETTING & SINGDIVIDING
DELAVER, WISCONSIN 53115**

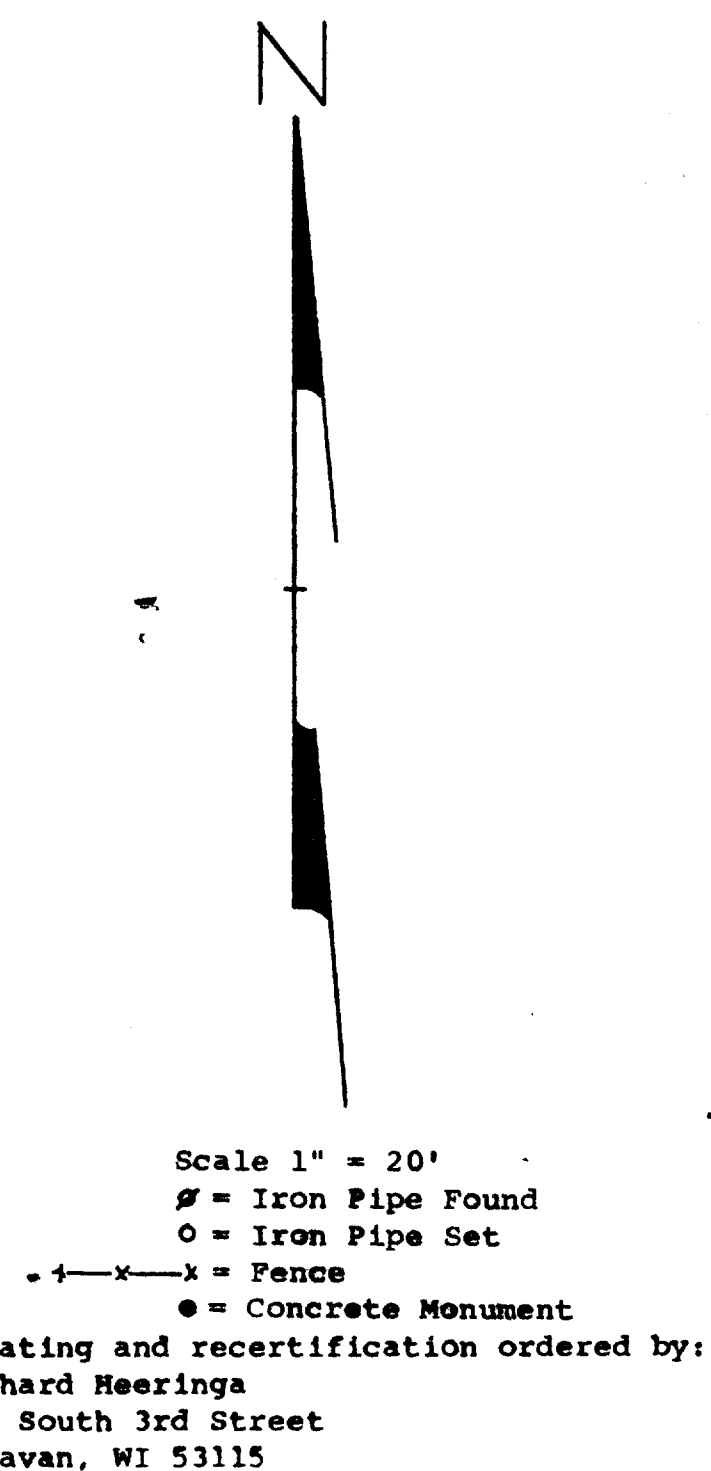

I, George F. Dunham, Surveyor, certify that I have surveyed the property described as follows,
A parcel of land located in Outlot 1 in the Village (now City) of Delavan, Walworth County, Wisconsin, described as follows: Commencing at a concrete monument located at the Northwest corner of Third Street and Phoenix Street in said City of Delavan; thence N0°15'E, on the West line of said Third Street, 87.25 feet to the place of beginning; thence continue N0°15'E, along the West line of Third Street, 98.85 feet to a point located 347.80 feet south of the South line of Geneva Street; thence N89°52'W, 166.81 feet; thence South, 100.62 feet to a point located 85.29 feet north of the North line of Phoenix Street; thence N89°12'W, 166.38 feet to the place of beginning, and that the above map is a true representation thereof and shows the size and location of the property, its exterior boundaries, the location of all visible structures and dimensions of all principal buildings thereon, boundary fences, apparent easements, roadways and visible encroachments, if any. This survey is made for the use of the present owners of the property, and also those who purchase, mortgage, or guarantee the title thereto within one (1) year from date hereof.
December 10, 1981.
Updated & recertified this
30th Day of June, 1989

George F. Dunham
George F. Dunham, Surveyor

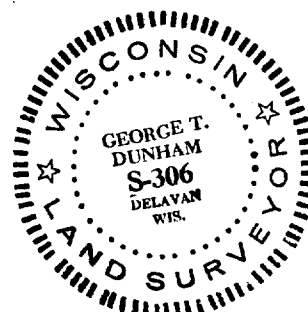
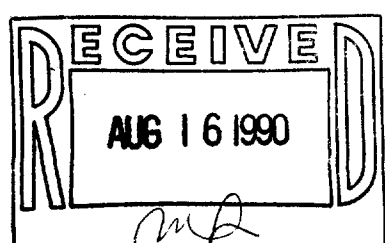

Survey # 002-1023

TAX KEY# XOP 00276