

ABELL SURVEYING & MAPPING

1140 SEQUOIA STREET • DELAVAN, WISCONSIN 53115
262-728-6737

LOT 34

LOT 35

AREA 0.31 ACRES

LOT 13

LAUREL HEIGHTS

BEARINGS ARE REFERENCED TO THE RECORDED SUBDIVISION PLAT.



SCALE 1" = 20'

LEGEND

- IRON PIPE FOUND
- CONCRETE MONUMENT FOUND
- ARBOR
- RAIL FENCE
- UTILITY POLE
- UTILITY PED.
- OVERHEAD UTILITY LINES
- STORM DRAIN GRATE
- GUY WIRE
- RECORDED AS

NOTE: THE LOT CORNER FOR LOTS 34 AND 35 ARE SHOWN ON THE ORIGINAL SUBDIVISION PLAT OF LAUREL HEIGHTS ADDITION AS BEING S 89°59' W 0.42' FROM THE POINT OF CURVATURE.

CH=S 78°32'18" W 0.35' (0.42')
A=0.35' R=135.00'

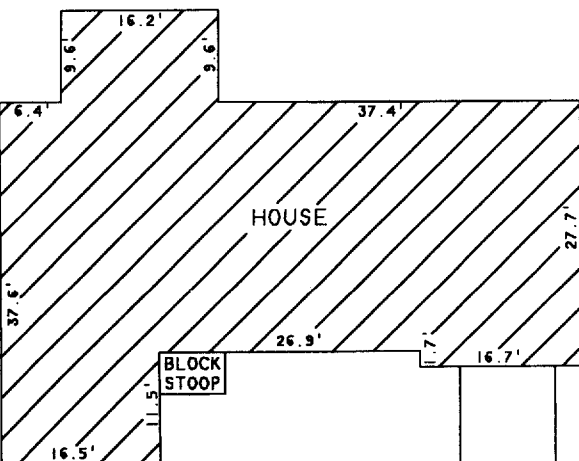

RAY STREET
75 FEET WIDE

PLAT OF SURVEY OF

LOT 35, LAUREL HEIGHTS ADDITION, LOCATED IN THE CITY OF DELAVAN, WALWORTH COUNTY, WISCONSIN.

I HEREBY CERTIFY THAT I HAVE SURVEYED THE ABOVE DESCRIBED PROPERTY AND THAT THE ABOVE MAP IS A TRUE REPRESENTATION THEREOF AND SHOWS THE SIZE AND LOCATION OF THE PROPERTY, ITS EXTERIOR BOUNDARIES, THE LOCATION OF ALL VISIBLE STRUCTURES AND DIMENSIONS OF ALL PRINCIPAL BUILDINGS THEREON, BOUNDARY FENCES, APPARENT EASEMENTS, ROADWAYS AND VISIBLE ENCROACHMENTS, IF ANY, TO THE BEST OF MY KNOWLEDGE AND BELIEF.

JUL 5

Kw

THIS SURVEY IS MADE FOR THE USE OF THE PRESENT OWNERS OF THE PROPERTY, AND ALSO THOSE WHO PURCHASE, MORTGAGE, OR GUARANTEE THE TITLE THERETO WITHIN ONE (1) YEAR FROM DATE HEREON.

David F. Abell

ORDERED BY: KEEFE REAL ESTATE
1155 E. GENEVA STREET
DELAVAN, WI 53115

DAVID F. ABELL
WISCONSIN REGISTERED LAND SURVEYOR, S-1596

May 18, 2004

DATE: _____ JOB NUMBER - 04055
NOTE: THIS IS NOT A CERTIFIED COPY UNLESS SEALED.

XLHA 00013

002-2224