

North 1/4 Corner
Section 27-2-15
(N. 225,090.72)
(E. 2,347,862.21)

Plat of Survey

of

Lots 5 & 6 in Block 13 of Stone & Topping's Addition to the Village of Darien,

a subdivision located in the Southwest 1/4 of the Northeast 1/4 of Section 27,
Town 2 North, Range 15 East, Village of Darien, Walworth County, Wisconsin.

Surveyed for: **Caleb Square**
223 Second Street
Darien, Wisconsin. 53114

N89°45'10"E 182.26'

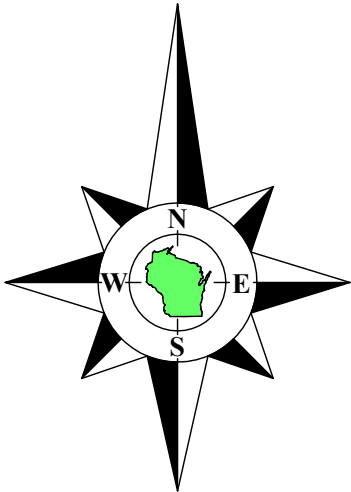

Bearings referenced to the East line of 2nd Street, recorded as N28°05'W on the plat of Stone & Topping's Addition to the Village of Darien which produces a bearing of N0°14'50"W on the West line of the Northeast 1/4 of Section 27-2-15, A rotation of 1°26'45" from the Wisconsin State Plane Coordinate System, South Zone, (NAD-27).

Coordinates are referenced to the Wisconsin State Plane Coordinate System, South Zone, (NAD-27).

Copyright © 2023 by Olson Land Surveying, LLC.

All rights reserved. No part of this survey plat may be reproduced or transmitted in any form by any means - graphic, electronic, or mechanical, including photocopying, tracing, or information storage and retrieval systems - without permission in writing from Douglas G. Olson, Olson Land Surveying, LLC.

I hereby certify that I have surveyed the above described property in compliance with Chapter A-E 7 of the Wisconsin Administrative Code and that the map hereon is correct to the best of my professional knowledge and belief and shows the size and location of the property, its exterior boundaries, the location and dimensions of all visible structures thereon, boundary fences, apparent easements and roadways and visible encroachments, if any.

This survey is made for the exclusive use of the present owners of the property, and also those who purchase, mortgage or guarantee title thereto, within one year from the date hereof.

Douglas G. Olson
Wisconsin Professional Land Surveyor - 2093

Center 1/4 Corner
Section 27-2-15
(N. 222,447.61)
(E. 2,347,940.33)

N61°30'27"E 641.02'

Jackson Street
(66' Wide)

Overhead Wires
recorded as (N61°55'E 132)
N61°46'30"E 132.07'

Lot 5

Garage

Movable
Tarp Shed
17' x 10'

Lot 4

Tax Parcel
QS&T 00004
0.500 Acre
21,788 Sq.Ft.

Driveway

House
No. 223

Lot 6

Shed

Lot 4

North 2nd Street
(66' Wide)
(2nd Avenue)

N28°05'00"W 165.02'
recorded as (N28°05'W)

Deck

S61°44'32"W 132.05'
recorded as (N61°55'E 132)

Found 2nd Pipe
0.42' S61°44'32"W

N27°55'51"W 164.98'

Notes:

- 1) This Plat of Survey is not certified unless signed and sealed in red ink.
- 2) This survey is subject to Wisconsin lien laws. This Plat of Survey is the notice of intent to file lien. Lien waiver required.
- 3) The Survey Date shown on this Plat of Survey is the completion date of the field work.

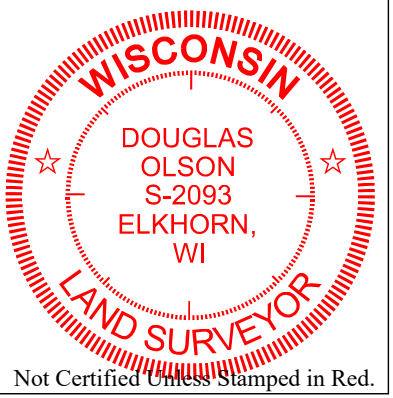

Survey Date: May 18, 2023.
Revisions:

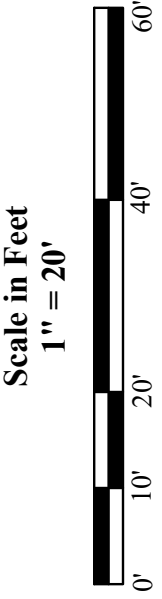

45 South Wisconsin Street | P.O. Box 322
Elkhorn, Wisconsin. 53121
Telephone: (262) 723-3434
Facsimile: (262) 723-8044
Email: doug@olsonsurveying.com
Website: www.olsonsurveying.com

OLSON
LAND SURVEYING, LLC
Rural | Residential | Commercial

Legend of Symbols & Abbreviations
N North
S South
E East
W West
P Found County Section Corner
I Found Iron Pipe
P Found Iron Pipe
R Red
I Recorded Information
O Utility Pole
H Fire Hydrant
X Asphalt Surface
Q Water Valve
C Concrete Surface
G Gravel Surface
S Surface
I Inches

Sheet 1 of 1 Sheets
Drawing Name:
Job Reference Number
2023.035
2023.035