

of

Lots 9, 11 and a strip of land 1' wide off the North side of Lot 12, all in Block 22 of the Map of Frey's Addition to the Village of Darien, Walworth County, Wisconsin.

Property Address: 20 N. Wisconsin Street

11. Covenants, conditions and restrictions but omitting any covenants or restrictions, if any, including but not limited to those based upon race, color, religion, sex, sexual orientation, familial status, marital status, disability, handicap, national origin, ancestry, source of income, gender, gender identity, gender expression, medical condition or genetic information, as set forth in applicable state or federal laws, except to the extent that said covenant or restriction is permitted by applicable law, as set forth in the document recorded on January 4, 1999, as Document No. 403503. SEE NOTE 3 BELOW

1. According to Flood Insurance Rate Map (FIRM) No. 55127C0277E for Walworth County, Wisconsin and Incorporated Areas, Effective date: October 2, 2007, Map revised: September 3, 2014, this site falls in Zone X: Areas determined to be outside the 0.2% annual chance floodplain.
2. There are no marked parking spaces on this site.
3. Lot 9, Block 22 Frey's Addition is shown on this survey. Note that DAVID JOHN DIETRICH is the current owner of Lot 12, Block 22 Frey's Addition. Lydia Z. Moronec conveyed Lot 12, Block 22 Frey's Addition to Christopher J. Valenti by Warranty Deed, Doc. No. 649943, recorded August 12, 2005.

This is to certify that this map or plat and the survey on which it is based were made in accordance with the 2016 Minimum Standard Detail Requirements for ALTA/NSPS Land Title Surveys, jointly established and adopted by ALTA and NSPS, and includes items 1, 2, 3, 4, 7(a), 8, 9, 11, 13 and 16 of Table A thereof.

December 14, 2018

Douglas G. Olson
Wisconsin Professional Land Surveyor - 2093

$$1'' = 500'$$

Southwest 1/4 of Section 27-2-15.

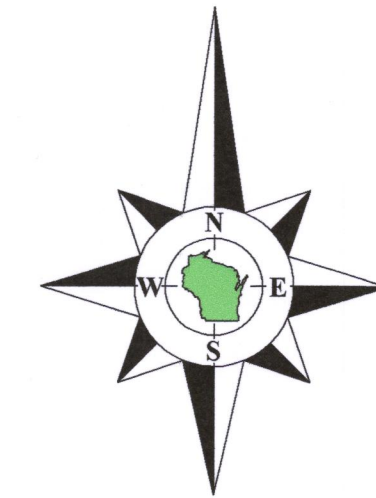
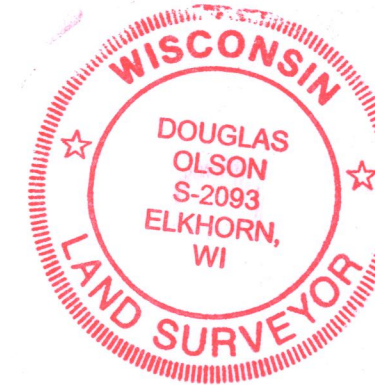
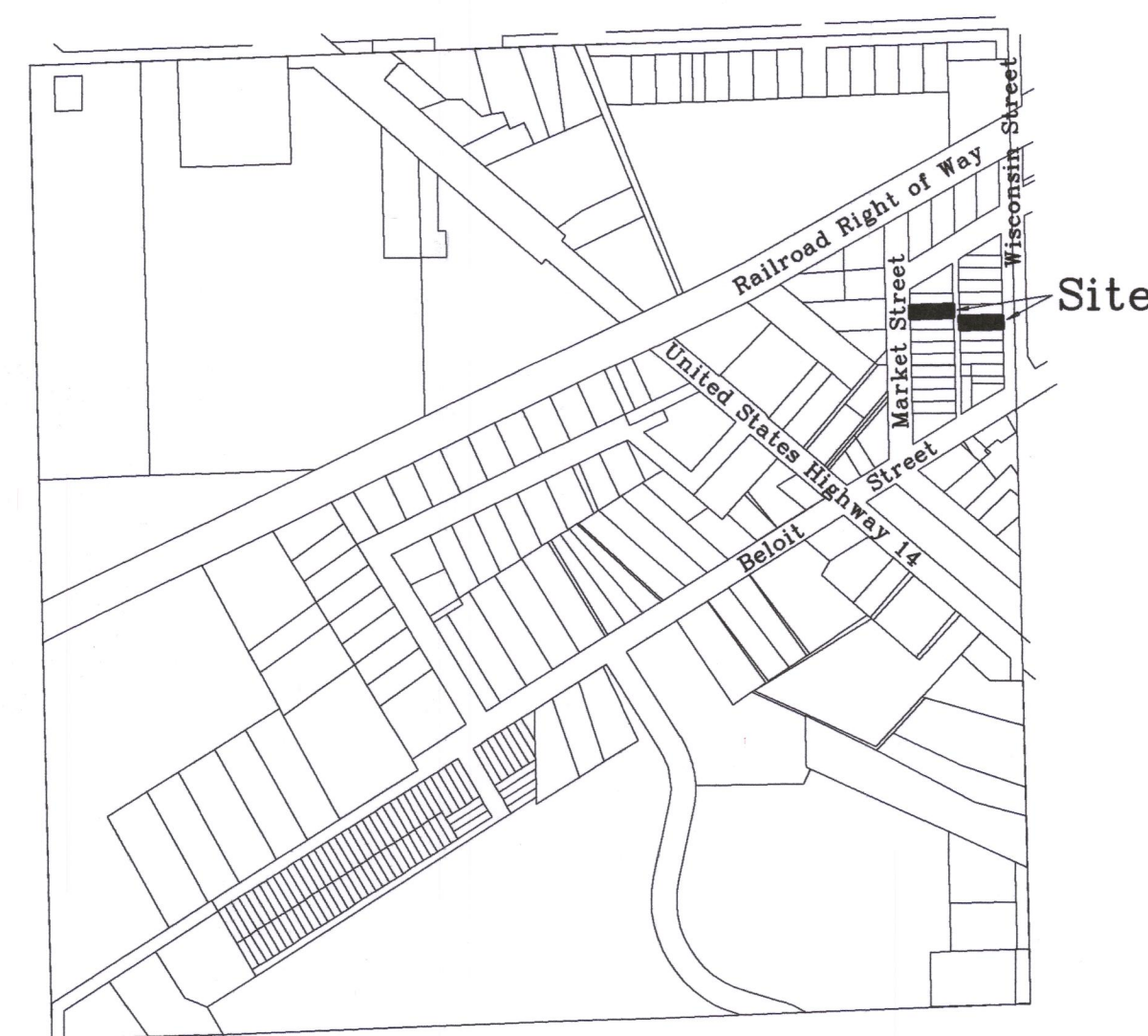

Coordinates are referenced to the Wisconsin State Plane Coordinate System, South Zone, (NAD-27).

Survey date: December 14, 2018.
Revisions:

Scale in Feet
1" = 15'

45 South Wisconsin Street | P.O. Box 322
Elkhorn, Wisconsin, 53121
Telephone: (262) 723-3434
Facsimile: (262) 723-8044
Email: doug@olsonsurveying.com
Website: www.olsonsurveying.com

OLSON
LAND SURVEYING, LLC
Rural | Residential | Commercial

Legend

■ Found County Section Corner
● Found on Pipe
● Found on Rod
● Set Mag Nail 1 dia.
● Set Mag Nail
● Set Cat Cross
● Recorded Information
○ Light Pole
○ Water Valve
○ Manhole
○ Catch Basin
○ Asphalt Surface
○ Gravel Surface
○ Gravel Surface
○ Gravel Surface

N North
S South
E East
W West
In Bearing
In Feet
In Minutes
In Seconds
In Tenth Seconds
In Feet
No. Number
N North
N North
Dm Diameter
Dia. Diameter

Sheet 1 of 1 Sheets

Reference Number
2018.165

2018.165

