

# Plat of Survey

FOR: CARNAHAN MORTGAGE - MICHAEL J. & LINDA S. BERGSMA  
PROPERTY ADDRESS: 128 Jefferson Street; Darien, Wisconsin 53114

DESCRIPTION: The West 1/2 of Lot 11 and the East 1/2 of Lot 12, Block 16,  
STONE & TOPPINGS ADDITION TO THE VILLAGE OF DARIEN, according to the  
recorded plat thereof. Said land being in the Village of Darien,  
Walworth County, Wisconsin.

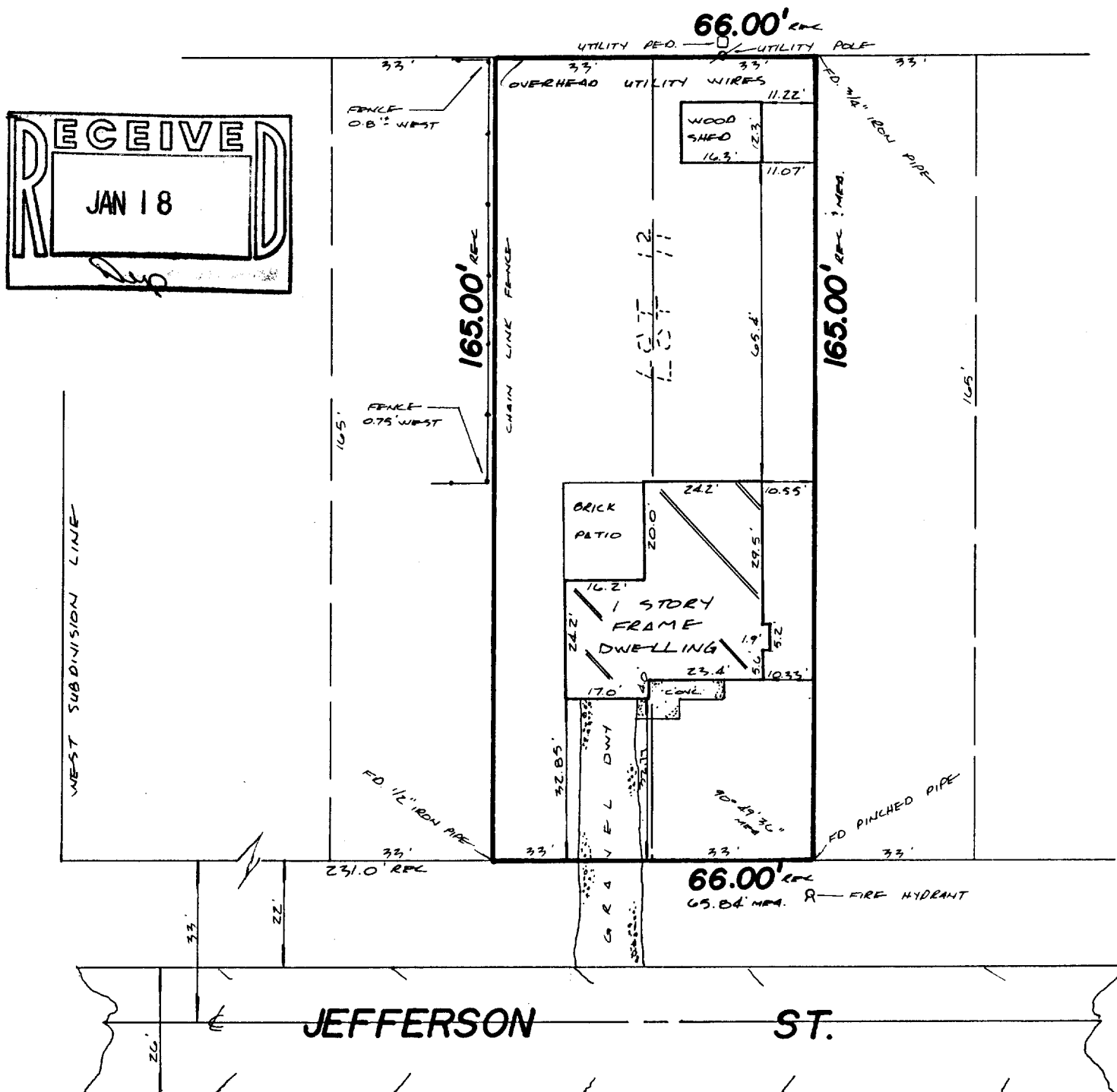

## CERTIFICATE

STATE OF WISCONSIN )  
WAUKESHA COUNTY ) SS

I CERTIFY THAT I HAVE SURVEYED THE ABOVE DESCRIBED PROPERTY, AND THE ABOVE MAP IS A TRUE REPRESENTATION THEREOF AND SHOWS THE SIZE AND LOCATION OF THE PROPERTY, ITS EXTERIOR BOUNDARIES, THE LOCATION AND DIMENSIONS OF ALL STRUCTURES THEREON, FENCES, APPARENT EASEMENTS AND ROADWAYS AND VISIBLE ENCROACHMENTS, IF ANY.

THIS SURVEY IS MADE FOR THE EXCLUSIVE USE OF THE PRESENT OWNERS OF THE PROPERTY, AND ALSO THOSE WHO PURCHASE, MORTGAGE, OR GUARANTEE THE TITLE THERETO, WITHIN ONE (1) YEAR FROM DATE HEREOF.

THIS SURVEY IS COPYRIGHTED AND THE REPRODUCTION THEREOF, IS PROHIBITED.

MONUMENTATION OF MISSING BOUNDARY CORNERS HAS (NOT) BEEN WAIVED BY THE ABOVE CLIENT AS PER CHAPTER A-E-501(b) OF THE WISCONSIN ADMINISTRATIVE CODE.

REGISTERED LAND SURVEYOR

DATE

**TERRA TECHNOLOGY, Inc.**

Land Surveyors - Land Planners

909 Blackstone Avenue

Waukesha, WI 53186

(414) 549-1111

JOB NUMBER: 5090

SCALE: 1" = 30'

