

GEORGE T. DUNHAM
SURVEYING & SUBDIVIDING
DELAVAN, WISCONSIN

N

Scale - 1" = 20'
o = Iron Pipe

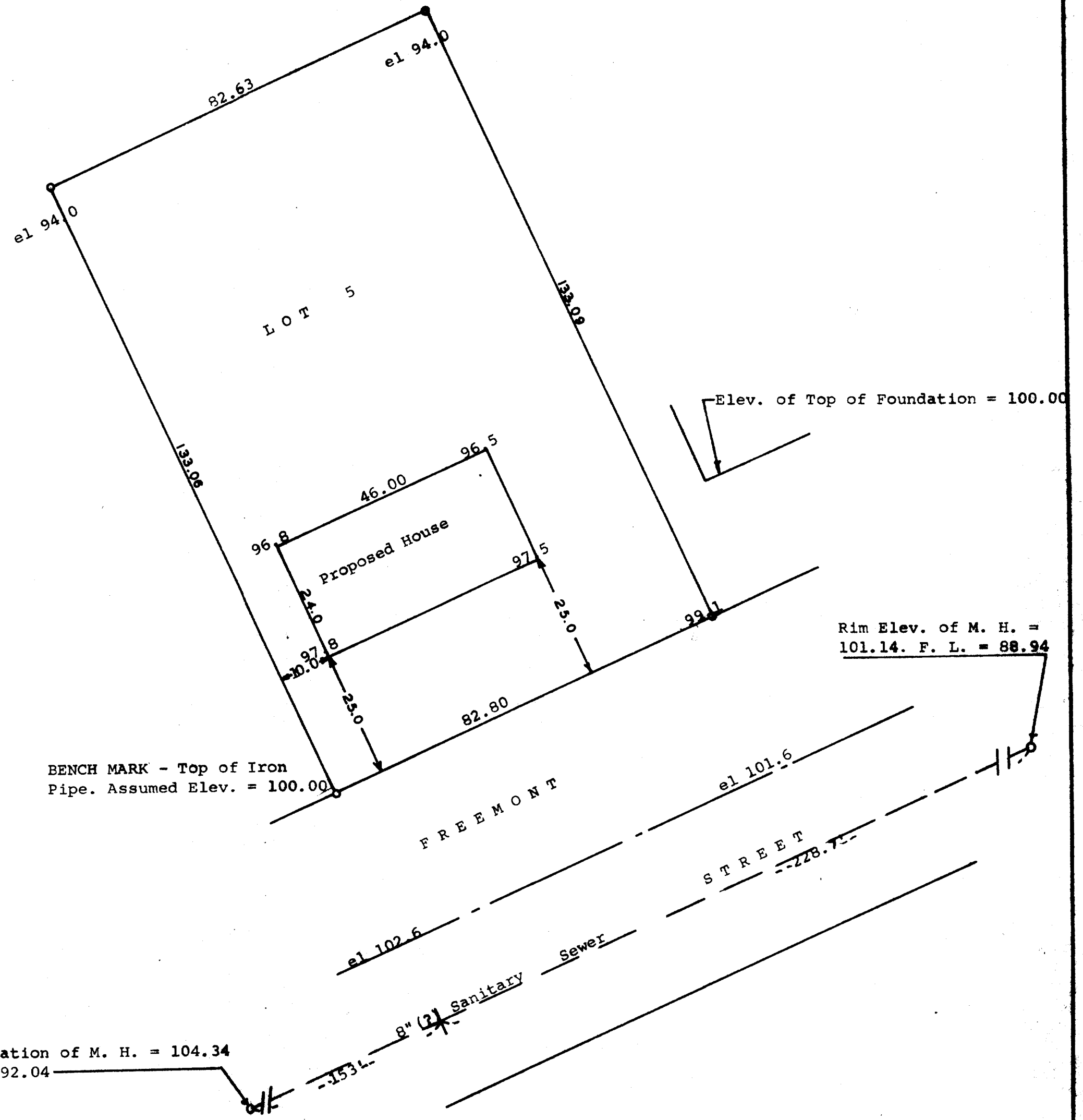

Rim Elevation of M. H. = 104.34
F. L. = 92.04

Rim Elev. of M. H. = 101.14. F. L. = 88.94

STATE OF WISCONSIN) SS
COUNTY OF WALWORTH)

I, George T. Dunham, Surveyor, certify that I have surveyed the property described as follows,
Lot 5 in Block 23, John Bruces Addition to the Village of Darien, Walworth County, Wisconsin,
and that the above plat is an accurate survey and a true representation thereof and correctly shows the exterior boundary lines and that there are no buildings on said lot at this time and that we did stake a foundation for a house with the dimensions as shown above.
March 7, 1974

George T. Dunham
George T. Dunham, Surveyor

