

COUNTRYSIDE SUBDIVISION

A Subdivision located in the Southeast 1/4 and the Southwest 1/4 of the Northwest 1/4 of Section 3, Town 3 North, Range 16 East, Town of Sugar Creek, Walworth County, Wisconsin.

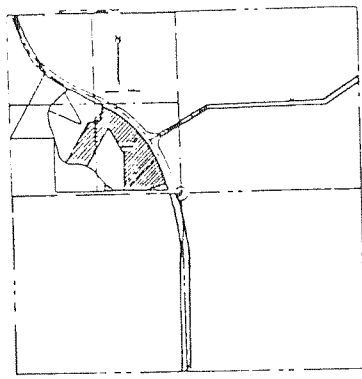

LOCATION SKETCH - NOT TO SCALE
SECTION 3, T 3 N, R 16 E



BEARINGS REFERENCED TO C.S.M. 1587

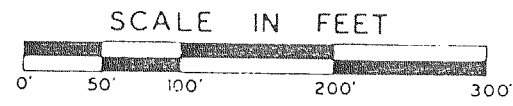

LEGEND

- - FOUND IRON PLUG
- ⊗ - FOUND IRON PIPE
- - TELEPHONE PEDESTAL AT PROPERTY CORNER
- - SET IRON PIPE 1" DIA., 24" LONG, WEIGHING AT LEAST 113 LBS/LIN FT
- () - RECORDED AS DIMENSION.

ACCESS RESTRICTION:

As owner, I hereby restrict Lots Nos. 3 and 4, abutting lots, and Outlet A in that no owner, possessor, user, nor licensee, nor other person shall have any right of direct vehicular ingress or egress with County Trunk Highway "H" as shown on the plat of COUNTRYSIDE SUBDIVISION, it being expressly intended that this restriction shall constitute a restriction for the benefit of the public and shall be enforceable by the Walworth County Highway Department.

REVISIONS: 02/14/97

