

Lyons Hillside Subdivision

A subdivision located in part of the Northwest 1/4 of the Southeast 1/4 of Section 10, Town 2 North, Range 18 East, County of Lyons, Wisconsin.

Unplatted Lands Owned by Others

Center of Section 10-2-18
Section 10-2-18

100 YEAR FLOOD ELEVATION = 785.5'
2' ABOVE 100 YEAR FLOOD CONTOUR
ELEVATION = 787.5'

Location Sketch
Section 10-2-18
Lyons Township

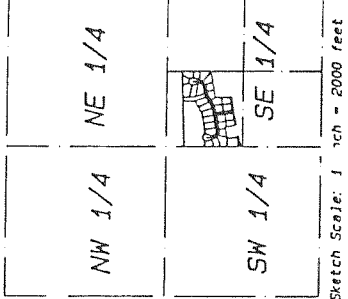

Scale: 1 inch = 2000 feet

Unplatted Lands Owned by Others



There are no objections to this plat with respect to Sects 236.15, 236.16, 236.20 and 236.21 (1) and (2), Wis. Stat.
Certified this 28th day of April 1995
JANE A. STAR
Department of Agriculture, Trade & Consumer Protection

C.S. 2875
663 A. 2

The contents of this plat are prepared for archival purposes only. No construction is to be based on this plat. The plat is subject to the provisions of Chapter SPS 10.01, Wis. Stat.

Hegeman's Subdivision
North-South 1/4
Section 10

Line Table

LINE	DISTANCE	BEARING
L1	52.36	S 18° 21' 30" W
L2	8.52	S 71° 46' 27" W
L3	33.43	S 0° 13' 00" E
L4	34.74	N 10° 00' 00" W
L5	33.00	S 10° 10' 00" E
L6	62.00	N 80° 34' 00" E
L7	33.00	S 80° 34' 00" W
L8	33.00	S 80° 34' 00" W
L9	25.42	N 79° 50' 00" E
L10	25.42	N 80° 34' 00" E
L11	62.00	N 80° 34' 00" E
L12	21.37	S 79° 50' 00" W
L13	18.60	N 79° 50' 00" E
L14	24.90	S 10° 10' 00" E
L15	30.63	N 59° 14' 00" E
L16	30.63	N 59° 14' 00" E
L17	21.62	S 20° 04' 00" E
L18	21.62	S 20° 04' 00" E

Curve Table

CURVE	ARC	DELTA	RADIUS	CHORD LENGTH
C1	254.69	121° 05' 48"	66.00	123.60
C2	46.50	42° 06' 00"	66.00	47.41
C3	157.69	136° 53' 48"	66.00	122.77
C4	47.50	42° 06' 00"	66.00	47.41
C5	157.69	136° 53' 48"	66.00	122.77
C6	182.83	160° 00' 00"	104.50	164.50
C7	240.52	100° 10' 00"	137.50	211.04
C8	102.34	42° 37' 20"	100.00	100.00
C9	53.04	22° 05' 14"	137.50	137.50
C10	85.14	35° 27' 26"	137.50	137.50
C11	66.76	10° 57' 50"	348.85	66.65
C12	111.95	18° 23' 10"	348.85	111.47
C13	178.20	29° 21' 00"	348.85	176.75
C14	195.61	29° 21' 00"	381.85	193.47
C15	412.39	59° 42' 00"	414.83	414.83
C16	106.32	14° 46' 54"	414.83	106.32
C17	106.32	14° 46' 54"	414.83	106.32
C18	104.52	14° 46' 54"	405.12	104.23
C19	66.07	9° 20' 40"	405.12	66.00
C20	42.12	5° 57' 26"	405.12	42.10
C21	212.71	30° 05' 00"	372.12	210.27
C22	195.38	30° 05' 00"	372.12	193.15
C23	178.05	30° 05' 00"	339.12	176.02
C24	161.51	27° 17' 18"	339.12	159.99
C25	16.54	2° 47' 42"	339.12	16.54
C26	112.50	80° 34' 00"	84.99	109.90
C27	112.50	80° 34' 00"	84.99	109.90
C28	35.84	13° 35' 59"	150.89	35.75
C29	79.80	30° 16' 58"	150.89	78.88
C30	75.79	28° 45' 44"	150.89	75.00
C31	204.88	7° 55' 70"	150.89	204.88
C32	254.69	121° 05' 48"	66.00	123.60
C33	33.76	29° 18' 39"	66.00	33.40
C34	66.86	59° 46' 30"	66.00	65.78
C35	70.51	61° 12' 44"	66.00	69.21
C36	72.87	63° 15' 30"	66.00	69.22
C37	72.87	63° 15' 30"	66.00	69.22
C38	8.69	7° 32' 26"	66.00	8.68

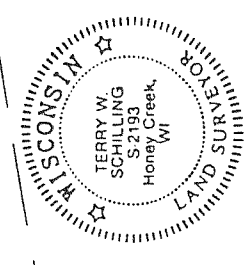

Terry A. Schilling
Wisconsin Registered
Land Surveyor
March 24, 1995

REVISED THIS 6TH DAY OF JUNE, 1995

REVISIONS : 07/21/97