

# DRIEHAUS CONDOMINIUM ADDENDUM 1

A REPLAT TO MODIFY THE DECLARED AREA

PART OF CERTIFIED SURVEY MAP NO. 3030

LOCATED IN THE NE 1/4 OF THE NW 1/4; THE SE 1/4 OF THE NW 1/4;

THE NE 1/4 OF THE SW 1/4; THE NW 1/4 OF THE NE 1/4

THE SW 1/4 OF THE NE 1/4; & THE NW 1/4 OF THE SE 1/4

SECTION 3, TOWN 1 NORTH, RANGE 17 EAST  
WALWORTH COUNTY, WISCONSIN

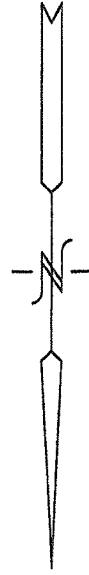

ASSIGNED EAST LINE CSM 3030  
S 00 10' 19" E

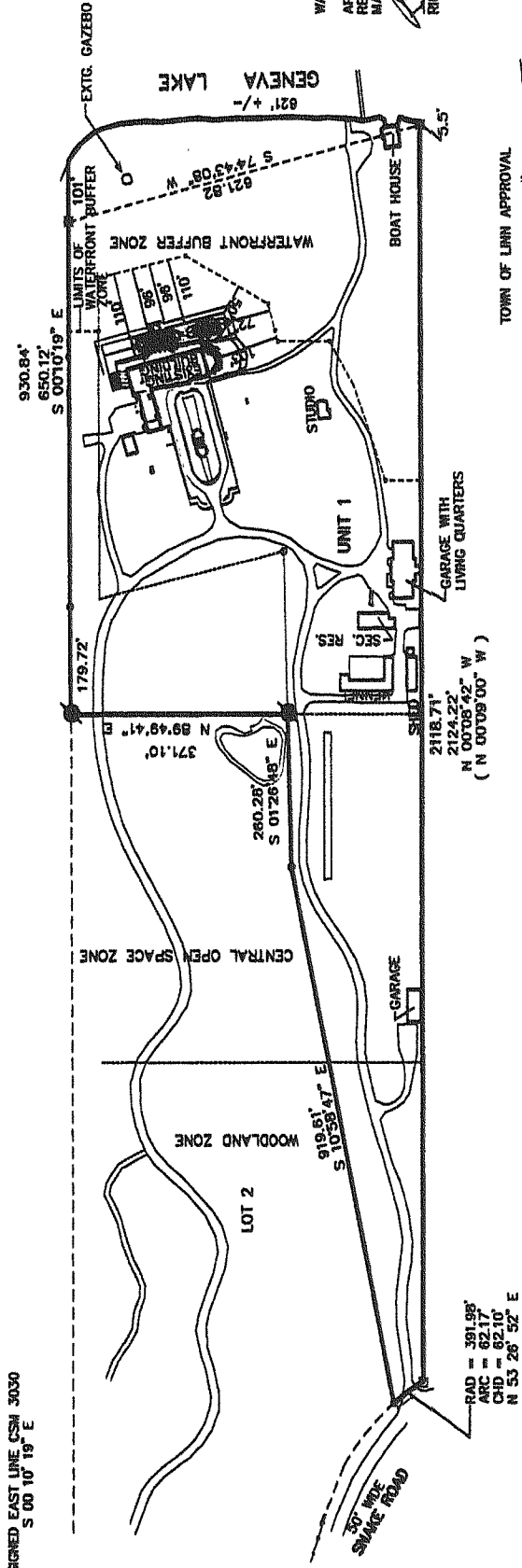

WALWORTH COUNTY APPROVAL  
APPROVED THIS 18th DAY OF July 2002 BY  
RESOLUTION OF THE WALWORTH COUNTY LAND  
MANAGEMENT COMMITTEE.

RICHARD KURANKE, SR. CHAIRPERSON

TOWN OF LINN APPROVAL  
APPROVED THIS 10th DAY OF June 2002 BY THE TOWN OF LINN, WALWORTH COUNTY,  
WISCONSIN.

AUTHORIZED SIGNATURE FOR THE TOWN OF LINN

I HEREBY CERTIFY THAT THIS PLAT IS A CORRECT REPRESENTATION OF THE CONDOMINIUM  
DESCRIBED TO THE BEST OF MY PROFESSIONAL KNOWLEDGE AND BELIEF AND THAT THE  
IDENTIFICATION AND LOCATION OF EACH UNIT AND THE COMMON ELEMENTS CAN BE DETERMINED  
FROM THE PLAT.

DATED: May 16, 2002

PETER S. GORDON R.L.S. 2101

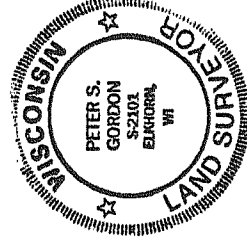

LEGAL DESCRIPTION  
DECLARED AREA  
DRIEHAUS CONDOMINIUM  
ADDENDUM 1

A PART OF CERTIFIED SURVEY MAP NO. 3030, RECORDED IN VOLUME NO. 16, ON PAGE NO. 137  
AS DOCUMENT NO. 38870 OF WALWORTH COUNTY, WISCONSIN, LOCATED IN THE NORTHEAST  
1/4 OF THE NORTHWEST 1/4, THE SOUTHWEST 1/4 OF THE NORTHWEST 1/4, THE NORTHEAST 1/4  
OF THE SOUTHWEST 1/4, THE NORTHWEST 1/4 OF THE SOUTHWEST 1/4, THE SOUTHWEST 1/4 OF  
THE NORTHEAST 1/4, AND THE NORTHWEST 1/4 OF THE SOUTHWEST 1/4, ALL IN SECTION 3, TOWN  
1 NORTH, RANGE 17 EAST, WALWORTH COUNTY, WISCONSIN, DESCRIBED AS FOLLOWS:  
BEGINNING AT A RAILROAD RAIL FOUND MARKING THE NORTHWEST CORNER OF SAID CSM 3030 ON  
THE SOUTHERLY LINE OF SWAKE ROAD; THENCE 62.17 FEET ALONG THE ARC OF A CURVE TO THE  
LEFT HAVING A RADIUS OF 391.98 FEET AND A CHORD WHICH BEARS N 53 DEG 28 MIN 52 SEC E,  
62.10 FEET; THENCE S 10 DEG 58 MIN 47 SEC E, 819.61 FEET ALONG THE LINE BETWEEN LOTS 1  
AND 2 OF SAID CSM 3030; THENCE S 01 DEG 26 MIN 48 SEC E, 260.28 FEET TO A POINT OF BEGINNING  
AND A POINT OF BEGINNING; THENCE S 01 DEG 26 MIN 48 SEC E, 260.28 FEET TO A POINT OF BEGINNING;  
THENCE S 01 DEG 26 MIN 48 SEC E, 260.28 FEET TO THE SHORE OF GENEVA LAKE; THENCE  
WESTERLY ALONG THE SHORE OF GENEVA LAKE 621 FEET MORE OR LESS TO THE SOUTHWEST CORNER  
OF SAID CSM 3030; THENCE N 00 DEG 08 MIN 42 SEC W, 2124.22 FEET TO THE POINT OF  
BEGINNING, CONTAINING 17.91 ACRES OF LAND MORE OR LESS.

## LEGEND

- O = FOUND IRON PIPE STAKE 1" DIA.
- = FOUND IRON REBAR STAKE
- = FOUND RAILROAD RAIL
- (XXX) = RECORDED AS
- ⊙ = SET IRON REBAR STAKE

MAP SCALE IN FEET ORIGINAL 1" = 200'

PROJECT 5255  
DATE: 5-14-02  
SHEET 1 OF 1

FARRIS, HANSEN, & ASSOCIATES, INC.  
ENGINEERING, ARCHITECTURE, & SURVEYING  
7 RIDGWAY COURT P.O. BOX 437  
ELKHORN, WISCONSIN 53121  
OFFICE: (414) 723-2098  
FAX: (414) 723-5886