

**SITE PLAN FOR**  
**LAKE GENEVA WOODLANDS**  
 CITY OF LAKE GENEVA  
 WALWORTH COUNTY, WISCONSIN

GROSS LAND AREA	429,066 sf.	9.85 ac.±
DEDICATED STREET AREA	57,900 sf.	1.33 ac.±
NET LAND AREA	371,166 sf.	8.52 ac.±
TOTAL UNITS	82 units	
DUPLEXES	10 units	
4-PLEXES	24 units	
8-PLEXES	48 units	
TOTAL PARKING	224 spaces	
OPEN	60 spaces	
ENCLOSED	164 spaces	
BUILDING LAND COVER	84,654 sf.	22.81%
PARKING & DRIVES AREA	32,705 sf.	8.81%
GREEN AREA	253,803 sf.	68.38%
DENSITY	8.32 units/acre gross	9.62 units/acre net

PROPOSAL FOR  
 LAKE GENEVA WOODLANDS CONDOMINIUMS,  
 BEING PART OF GENEVA HILLS  
 SUBDIVISION, PART OF THE SOUTHEAST  
 1/4 OF SECTION 26, TOWN 2 NORTH,  
 RANGE 17 EAST, LOCATED IN WALWORTH COUNTY,  
 WISCONSIN

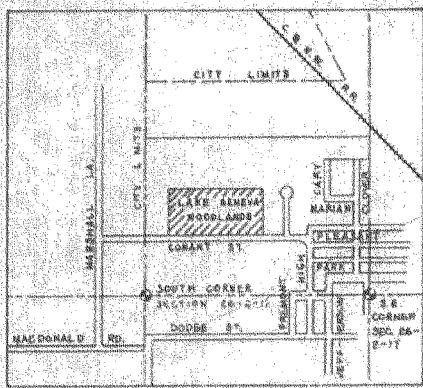

LOCATION MAP  
 SCALE: 1" = 1,000'

OWNER: JEANETTE F. THOMPSON  
 1821 CONANT ST.  
 LAKE GENEVA, WIS.

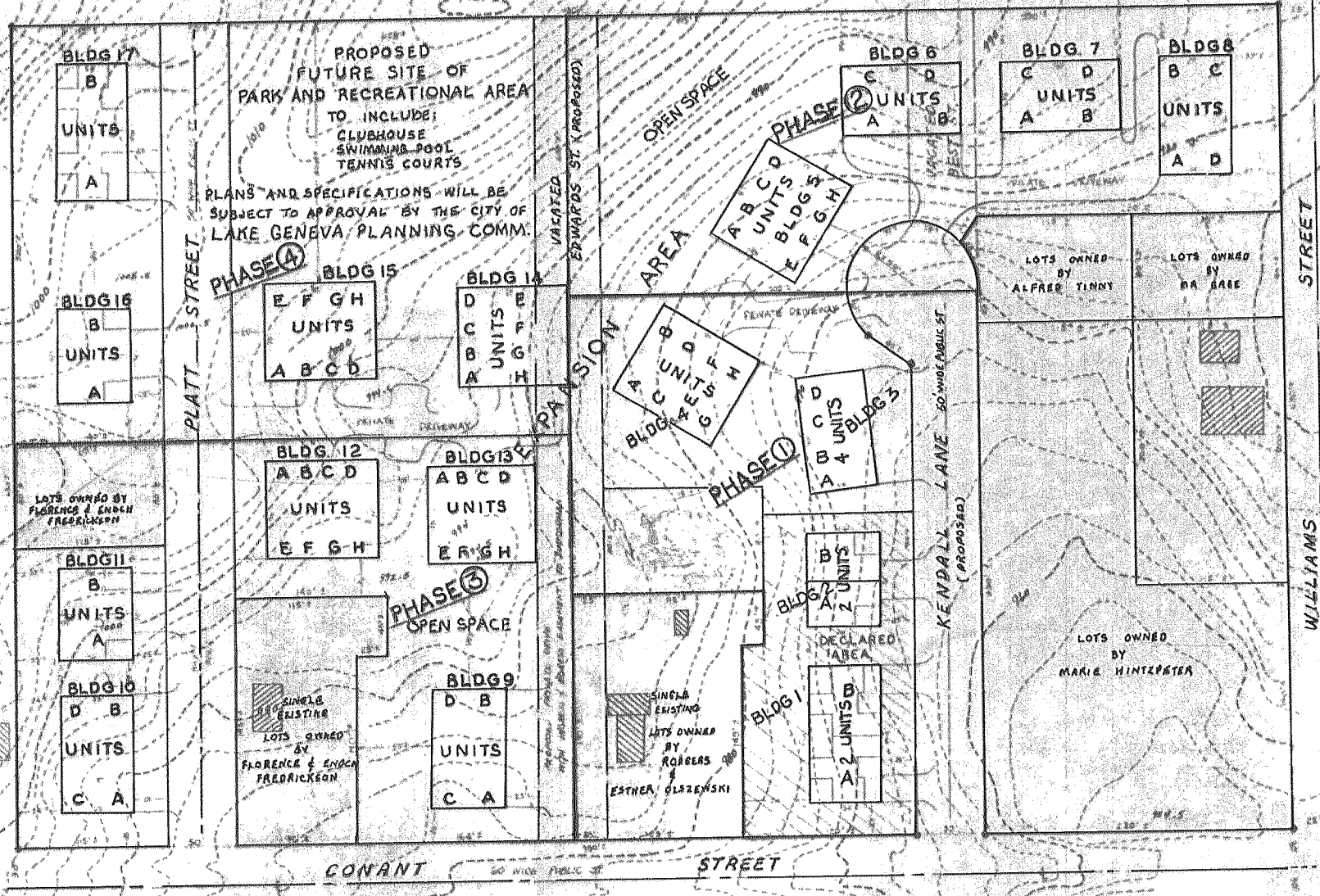

PROPOSED  
 FUTURE SITE OF  
 PARK AND RECREATIONAL AREA  
 TO INCLUDE:  
 CLUBHOUSE  
 SWIMMING POOL  
 TENNIS COURTS  
 PLANS AND SPECIFICATIONS WILL BE  
 SUBJECT TO APPROVAL BY THE CITY OF  
 LAKE GENEVA PLANNING COMM.

SCALE 1" = 100'

NOTE: CONTOURS SHOWN ON  
 THIS PROPOSAL WERE  
 TAKEN FROM CITY OF  
 LAKE GENEVA DATA



JENSEN SURVEYING & MAPPING S.C.  
 P.O. BOX 322  
 ELKHORN, WISCONSIN 53002  
 #783-3434 EXHIBIT C

REVISIONS:  
 1. 10/2/98 - 2647.0 1/1  
 2. 10/2/98 - 2647.0 1/1  
 3. 10/2/98 - 2647.0 1/1