

"HARBOR COVE CONDOMINIUM"
A CONDOMINIUM PLAT

129 A

TRACT OF LAND BEING A PART OF THE SOUTHEAST 1/4 OF SECTION 36,
TOWN 2 NORTH, RANGE 17 EAST, IN THE CITY OF LAKE GENEVA, COUNTY
OF WALWORTH, STATE OF WISCONSIN.

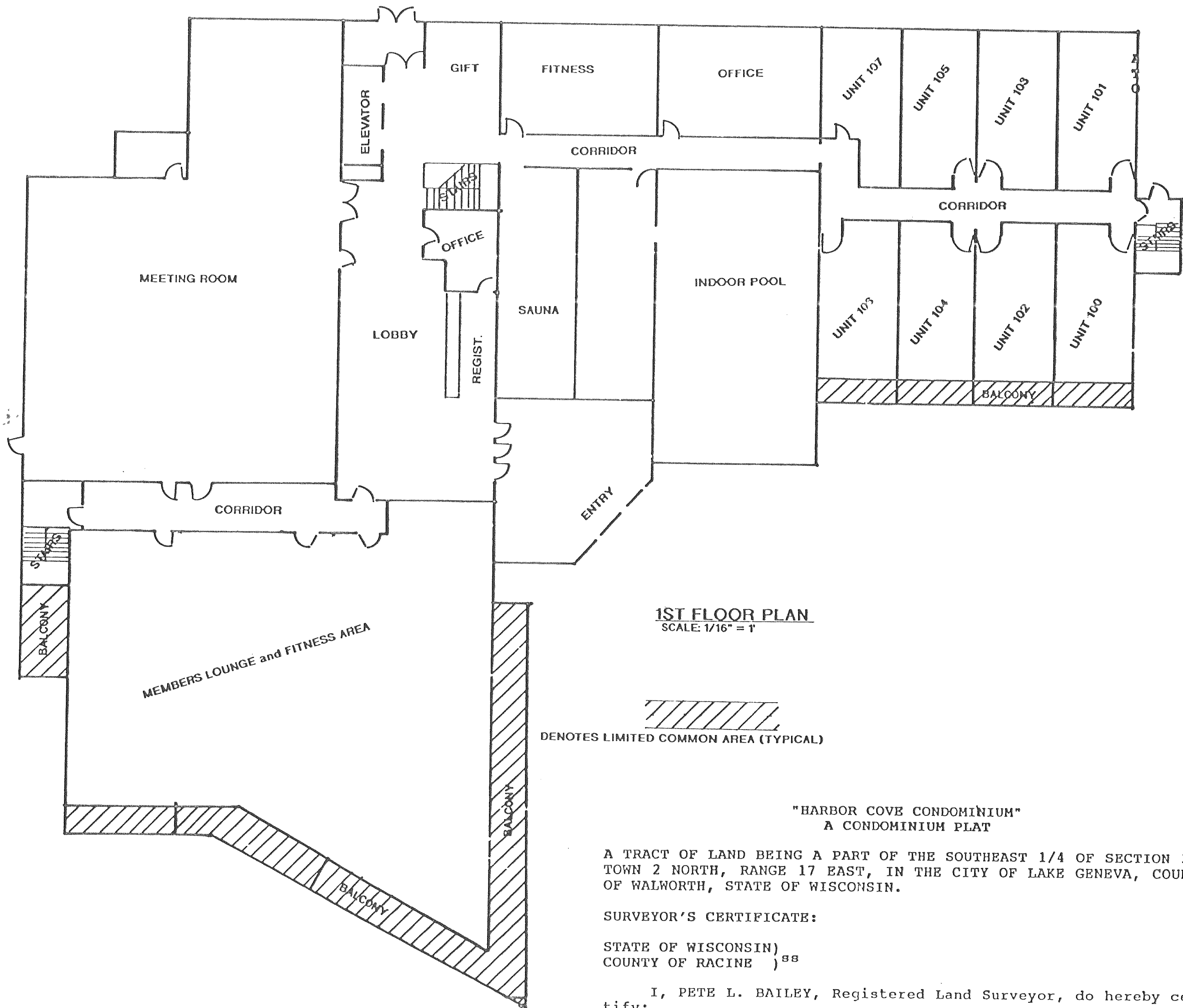

"HARBOR COVE CONDOMINIUM"
A CONDOMINIUM PLAT

A TRACT OF LAND BEING A PART OF THE SOUTHEAST 1/4 OF SECTION 36,
TOWN 2 NORTH, RANGE 17 EAST, IN THE CITY OF LAKE GENEVA, COUNTY
OF WALWORTH, STATE OF WISCONSIN.

SURVEYOR'S CERTIFICATE:

STATE OF WISCONSIN)
COUNTY OF RACINE)^{SS}

I, PETE L. BAILEY, Registered Land Surveyor, do hereby cer-
tify:

THAT I have surveyed the property described herein and that
this survey accurately represents the exterior boundary lines and
the location of improvements on said property. This plat is a
correct representation of the "HARBOR COVE CONDOMINIUM" and the
identification and location of each building, unit and common
area can be determined from the plat. This surveyor makes on cer-
tification as to the accuracy of the diagrammatical floor plans,
as to the accuracy of the dimensions of the units therein. The
dimensions shown are estimates and the actual dimensions may not
be exactly as shown.

DATED THIS 10TH DAY OF SEPTEMBER, 1995.

Pete L. Bailey

AMERICAN SURVEYING COMPANY, INC.
PETE L. BAILEY, RLS NO. 1398
REV: This 18th day of September, 1995.

REVISIONS :