

THE COVE OF LAKE GENEVA

CONDOMINIUM PLAT

123F

CITY OF LAKE GENEVA

UNIT REFERENCE

UNIT NUMBER:	UNIT TYPE:
432	"B"
434	"B" (REV)
436	"B"
437	"B" (REV)
438	"D" (REV)
439	"B"
440	"D"
441	"B" (REV)
442	"B" (REV)
443	"D"
444	"B"
445	"D" (REV)
446	"B" (REV)
447	"B"
448	"B"
449	"B" (REV)
450	"B" (REV)
451	"B"
452	"B"
453	"B" (REV)
454	"D" (REV)
455	"B"
456	"D"
457	"B" (REV)
458	"B" (REV)
459	"D"
460	"B"
461	"D" (REV)
462	"B" (REV)
463	"B"
465	"B" (REV)
467	"B"
328	"A"
330	"A" (REV)
332	"A"
334	"C" (REV)
336	"C"
337	"A" (REV)
338	"A" (REV)
339	"A"
340	"A"
341	"A" (REV)
342	"A" (REV)
343	"C"
344	"A"
345	"C" (REV)
346	"A" (REV)
347	"A"
348	"A"
349	"A" (REV)
350	"C" (REV)
351	"A"
352	"C" (REV)
353	"A" (REV)
354	"A" (REV)
355	"A"
356	"A"
357	"A" (REV)
358	"A" (REV)
359	"C"
361	"C" (REV)
363	"A"
365	"A" (REV)
367	"A"

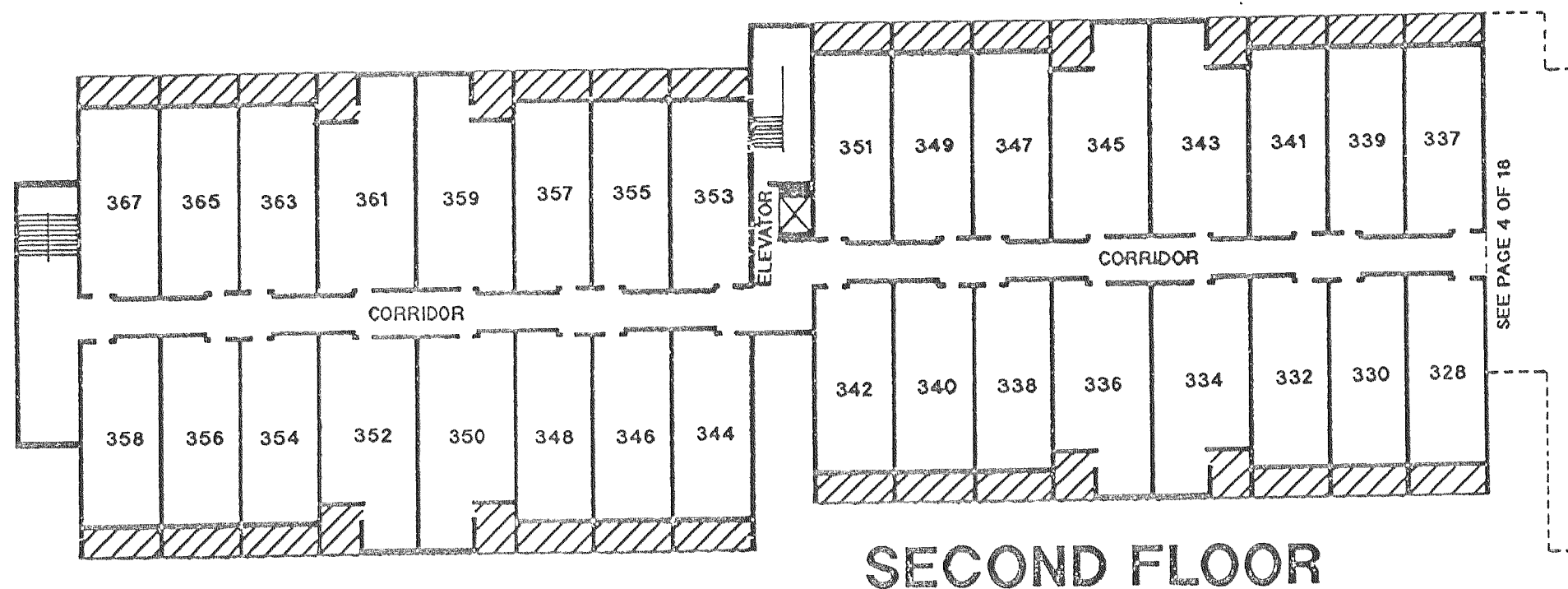

SCALE: 1"=30'

 DENOTES LIMITED COMMON AREAS, ALL OTHER AREAS ARE COMMON.

SEE PAGES 10 THRU 20 FOR UNIT TYPE FLOORPLANS.
(REV) INDICATES REVERSE PLAN.