

CERTIFIED SURVEYS 3198, 3204

TOWN OF LAGRANGE

437298

CERTIFIED SURVEY MAP NO. 3198

BEING PART OF THE SOUTHEAST 1/4 OF THE SOUTHEAST 1/4 OF SECTION 21, TOWNSHIP 4 NORTH, RANGE 16 EAST OF THE FOURTH PRINCIPAL MERIDIAN, IN THE TOWNSHIP OF LA GRANGE, WALWORTH COUNTY, WISCONSIN.

PREPARED FOR: WILLIAM J. LAWTON-TRUST
JOYCE R. LAWTON-TRUST
JOYCE R. LAWTON-TRUSTEE
1155 WEST BLACKHAWK DR. APT. 307
WHITEWATER, WI 53190-1673

PREPARED BY: B.W. SURVEYING, INC.
412 N. PINE STREET
BURLINGTON, WI 53105
(262)-767-0225
JOB NO. 4262

BEARINGS HEREON RELATE TO THE EAST LINE OF THE SOUTHEAST 1/4 OF SECTION 21-4-16, ASSUMED BEARING, NORTH.

BENCHMARK: SOUTHEAST CORNER OF SECTION 21-4-16, ASSUMED ELEVATION: 82.2.

LOCATION MAP

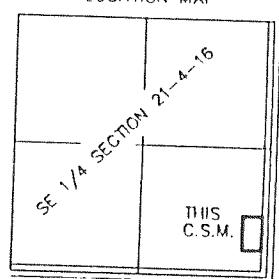

SCALE: 1" = 2000'

KETTLE MORAIN DR.

NOTE: RIGHT OF WAY TRANSFERRED PER VOLUME 567 OF DEEDS PAGE 393 AS DOCUMENT NUMBER 530930.

LEGEND

- ⊕ FOUND CONCRETE MONUMENT WITH BRASS CAP
- SET 3/4" X 24" REBAR STAKE WEIGHING 1.5 POUNDS PER LINEAL FOOT.
- SET 1" X 24" IRON PIPE WEIGHING 1.13 POUNDS PER LINEAL FOOT.
- ⊘ FOUND IRON ROD (3/4")
- △ SOIL BORING

GRAPHIC SCALE

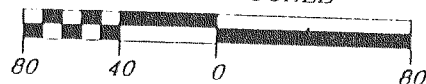

SCALE: 1" = 80'

THIS INSTRUMENT DRAFTED BY JEFFREY T. STONE

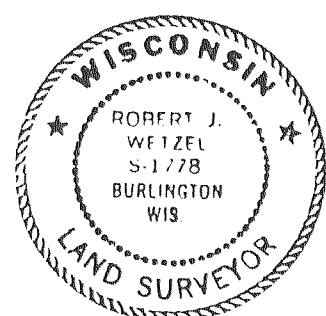

Robert J. Wetzel
ROBERT J. WETZEL S-1778
DECEMBER 21, 1999
REVISED: FEBRUARY 9, 2000

SHEET 1 OF 3

C. S. #3198

VOLUME 17 PAGE 296

CERTIFIED SURVEY MAP NO. 3204

A PARCEL OF LAND LOCATED IN THE SOUTHWEST 1/4 OF THE SOUTHWEST 1/4 OF SECTION 29, TOWN 4 NORTH, RANGE 16 EAST, WALWORTH COUNTY, WISCONSIN.

NOTE: EXISTING SANITARY SYSTEM APPEARS TO BE FUNCTIONING. NO EVALUATION BY THE WALWORTH COUNTY SANITATION DEPARTMENT AS TO MEETING REQUIREMENTS FOR REPLACEMENT SYSTEM UNDER COM-85 OF THE WISCONSIN ADMINISTRATIVE CODE.

OWNER: STERKEN FARMS, INC.
N4285 COUNTY RD M
DELAVAN, WI 53115

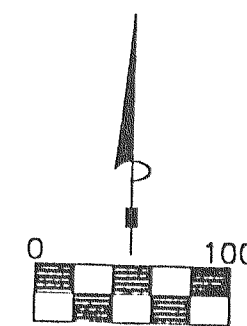

SCALE 1"=100'
BEARINGS REFERENCED TO THE WEST LINE OF THE SW 1/4 OF SECTION 29 T4N, R16E

LEGEND

- ⊕ SET 1" DIA. IRON PIPE 24" IN LENGTH WEIGHING MORE THAN 1.13 LBS. PER LIN FT.
- ⊕ 6" X 6" LIMESTONE SECTION CORNER MONUMENT WITH BRASS CAP
- ⊙ SEPTIC TANK MANHOLE
- ⊙ POWER POLE
- ⊕ OVERHEAD ELECTRIC

UNPLATTED LANDS OWNED BY PLATTER

A-1

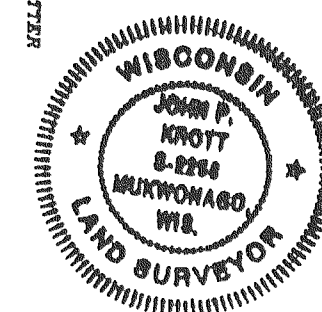

DATE: 12-9-1999

John P. Krott
JOHN P. KROTT, S-2258

INSTRUMENT DRAFTED BY JOHN P. KROTT, R.L.S. 2258

SHEET 1 OF 3

SOUTHWEST CORNER OF THE SOUTHWEST 1/4 OF SECTION 29 T4N, R16E
PATHFINDER SURVEYING
FORMERLY KOLB LAND CONSULTING
929 WILLIAMS ST. LAKE GENEVA, WI.
(262) 246-3897

C.S. #3204

VOL 17 PAGE 310

MAPPING DATE: 03/28/00