

MARINER HILLS

LOCATED IN THE SW1/4-SE1/4, SE1/4-SE1/4, SW1/4-SE1/4, SECTION 34, T4N, R16E, Town of Ladysburg, Walworth County, Wisconsin



Revised this 8th
Sept. 1985

Revised this 25th
Sept. 1985

Revised this 25th
Sept. 1985

BUBBLING
SPRINGS
SUB.

C.S.M. 10. 211

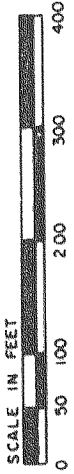

2ND ADD. TO BUBBLING SPRINGS SUB.

N 89° 45' 30" W

89° 45' 30"

200.320

FO. 3/4" RD.

442.39

N 02° 15' W 218.57

309.70

N 24° 10' E

415.97

N 85° 31' 35" W

395.83

FO. 3/4" RD.

898.2

N 18° 00' E

340

N 18° 00' E

53,140 ac

38

N 84° 53' E

163.88

N 75° 22' E

241.71

N 15° 22' E

210.06

N 65° 43' E

74.66

N 82° 00' W

143.36

N 25° 22' W

74.66

N 87° 22' W

488.51

N 10° 32' E

328.82

N 10° 32' E

23,610 ac

43

N 57° 11' E

483.40

N 79° 38' W

79,880 ac

45

N 11° 11' E

436.85

N 80° 00' E

21,740 ac

47

N 80° 00' E

132.39

N 80° 00' E

24,000 ac

48

N 80° 00' E

114.43

N 80° 00' E

10,540 ac

49

N 80° 00' E

137.95

N 89° 26' 05" E

3723.76'

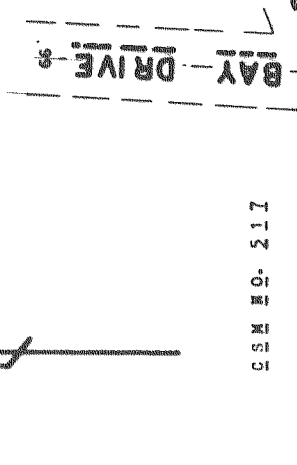

BUBBLING SPRINGS DRIVE

BAY DRIVE

MARINER HILLS CIRCLE

MARINER HILLS CIRCLE

MARINER HILLS CIRCLE

MARINER HILLS CIRCLE

MARINER HILLS CIRCLE

MARINER HILLS CIRCLE

MARINER HILLS CIRCLE

MARINER HILLS CIRCLE

MARINER HILLS CIRCLE

MARINER HILLS CIRCLE

MARINER HILLS CIRCLE

MARINER HILLS CIRCLE

MARINER HILLS CIRCLE

MARINER HILLS CIRCLE

MARINER HILLS CIRCLE

MARINER HILLS CIRCLE

MARINER HILLS CIRCLE

MARINER HILLS CIRCLE

MARINER HILLS CIRCLE

MARINER HILLS CIRCLE

MARINER HILLS CIRCLE

MARINER HILLS CIRCLE

MARINER HILLS CIRCLE

UNPLATTED LANDS

UNPLATTED LANDS

UNPLATTED LANDS

UNPLATTED LANDS

UNPLATTED LANDS

UNPLATTED LANDS

UNPLATTED LANDS

UNPLATTED LANDS

UNPLATTED LANDS

UNPLATTED LANDS

UNPLATTED LANDS

UNPLATTED LANDS

UNPLATTED LANDS

UNPLATTED LANDS

UNPLATTED LANDS

UNPLATTED LANDS

UNPLATTED LANDS

UNPLATTED LANDS

UNPLATTED LANDS

UNPLATTED LANDS

UNPLATTED LANDS

UNPLATTED LANDS

UNPLATTED LANDS

UNPLATTED LANDS

UNPLATTED LANDS

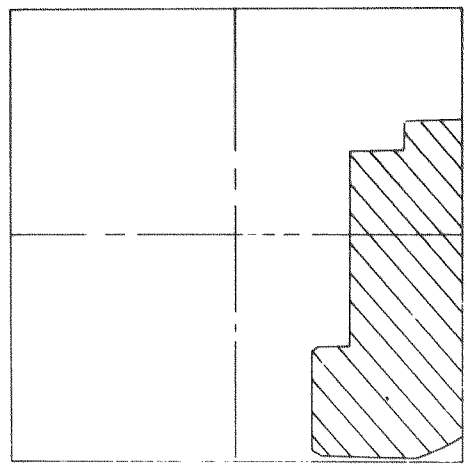

LOCATION MAP
Section 34, T4N, R16E
Scale 1"=1/4 mile

Line:

1	N1°24'03"E, 635.78'
2	N85°31'03"W, 396.10'
3	N1°02'56"W
4	N1°24'03"E, 415.52'
5	N89°47'E and N89°52.08"W
6	N88°49'E, 1373.88' and 1373.77' and N89°18'E,
7	N0°52'E and N0°23'E
8	N89°04'W and N89°33'W
9	101.44'
10	North and 950.93'
11	N13°57'20"W, 771.77'