

GENEVA NATIONAL CONDOMINIUM NO. 6

G.N. 6A

WALWORTH COUNTY, WISCONSIN

LOCATED IN THE NW 1/4 NE 1/4 AND IN NE 1/4 NW 1/4 SECTION 30, TOWN 2 NORTH, RANGE 17 EAST

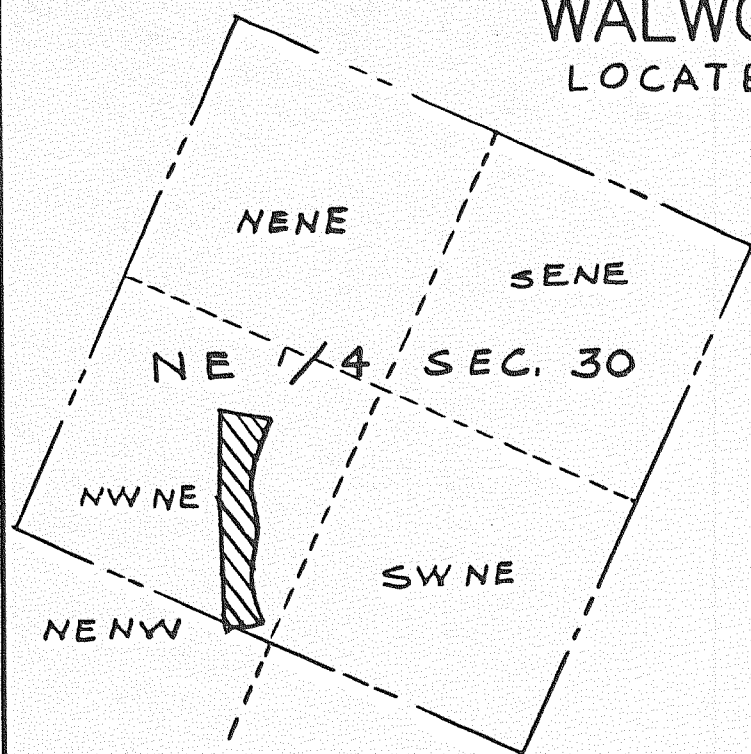

MAP SCALE IN FEET
0 = 1/2" x 18" REBAR STAKE

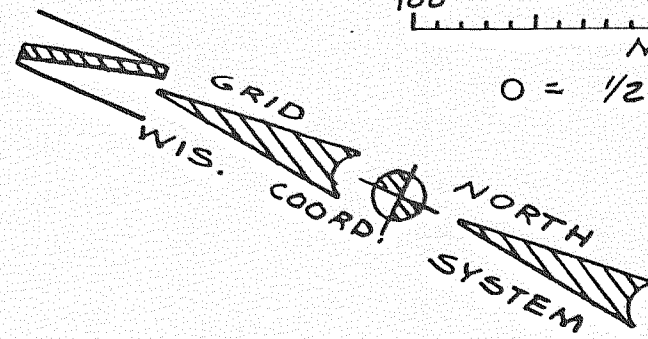

GENEVA NATIONAL CONDOMINIUM NO. 6
PHASE I
P.O.B.
S 12° 40' 46" E 243.55'

LEGAL DESCRIPTION FOR THE ADDITIONAL REAL ESTATE PARCEL

A PARCEL OF LAND LOCATED IN THE NORTHWEST 1/4 OF THE NORTHEAST 1/4 AND IN THE NORTHEAST 1/4 OF THE NORTHWEST 1/4 OF SECTION 30, TOWN 2 NORTH, RANGE 17 EAST, WALWORTH COUNTY, WISCONSIN DESCRIBED AS FOLLOWS:

COMMENCING AT A CONCRETE MONUMENT FOUND MARKING THE NORTH 1/4 SECTION CORNER OF SAID SECTION 30, SAID MONUMENT BEING LOCATED S 2DEG 04MIN 03SEC E 2105.97 FEET FROM THE U.S.G.S. TRIANGULATION STATION NAMED "GATES"; THENCE S 46DEG 55MIN 42SEC E 1337.39 FEET TO THE POINT OF BEGINNING IN THE NORTHERLY RIGHT OF WAY OF A PRIVATE ROADWAY KNOWN AS GENEVA NATIONAL AVENUE; THENCE 116.88 FEET ALONG SAID RIGHT OF WAY BEING THE ARC OF A CURVE TO THE RIGHT HAVING A RADIUS OF 766.59 FEET AND CHORD S 85DEG 38MIN 12SEC W 116.77 FEET; THENCE 390.43 FEET ALONG SAID RIGHT OF WAY BEING THE ARC OF A CURVE TO THE LEFT HAVING A RADIUS OF 638.65 FEET AND CHORD S 72DEG 29MIN 28SEC W 384.38 FEET; THENCE 186.03 FEET ALONG SAID RIGHT OF WAY BEING THE ARC OF A CURVE TO THE RIGHT HAVING A RADIUS OF 565.90 FEET AND CHORD S 64DEG 23MIN 43SEC W 185.20 FEET; THENCE 283.49 FEET ALONG SAID RIGHT OF WAY BEING THE ARC OF A CURVE TO THE LEFT HAVING A RADIUS OF 409.59 FEET AND CHORD S 53DEG 59MIN 04SEC W 277.87 FEET; THENCE 129.29 FEET ALONG THE EASTERLY RIGHT OF WAY OF A PRIVATE ROADWAY KNOWN AS TIMBER DRIVE BEING THE ARC OF A CURVE TO THE RIGHT HAVING A RADIUS OF 167 FEET AND CHORD N 32DEG 25MIN 01SEC W 126.08 FEET; THENCE 58.62 FEET ALONG SAID TIMBER DRIVE RIGHT OF WAY BEING THE ARC OF A CURVE TO THE LEFT HAVING A RADIUS OF 283 FEET AND CHORD N 16DEG 10MIN 20SEC W 58.51 FEET; THENCE N 62DEG 00MIN 30SEC E 539.41 FEET ALONG THE BOUNDARY OF GENEVA NATIONAL CONDOMINIUM NO. 31; THENCE N 66DEG 08MIN 01SEC E 469.00 FEET ALONG THE BOUNDARY OF GENEVA NATIONAL CONDOMINIUM NO. 6; THENCE S 12DEG 40MIN 46SEC E 243.55 FEET ALONG THE BOUNDARY OF GENEVA NATIONAL CONDOMINIUM NO. 6 TO THE POINT OF BEGINNING, CONTAINING 3.72 ACRES MORE OR LESS.

I HEREBY CERTIFY THAT THIS PLAT IS A CORRECT REPRESENTATION OF THE BOUNDARY DIMENSIONS OF THE ADDITIONAL REAL ESTATE PARCEL TO THE BEST OF MY PROFESSIONAL KNOWLEDGE AND BELIEF.

Robert A. Farris
ROBERT A. FARRIS RLS #1293

DATED 7/23/91

