

# GENEVA NATIONAL CONDOMINIUM NO. 53S

## CONDOMINIUM PLAT

LOCATED IN PART OF THE NW 1/4 AND SW 1/4 OF THE SW 1/4 OF SECTION 29, TOWN 2 NORTH, RANGE 17 EAST, WALWORTH COUNTY, WISCONSIN

HATCHED AREAS REPRESENT LIMITED COMMON ELEMENT (L.C.E.)

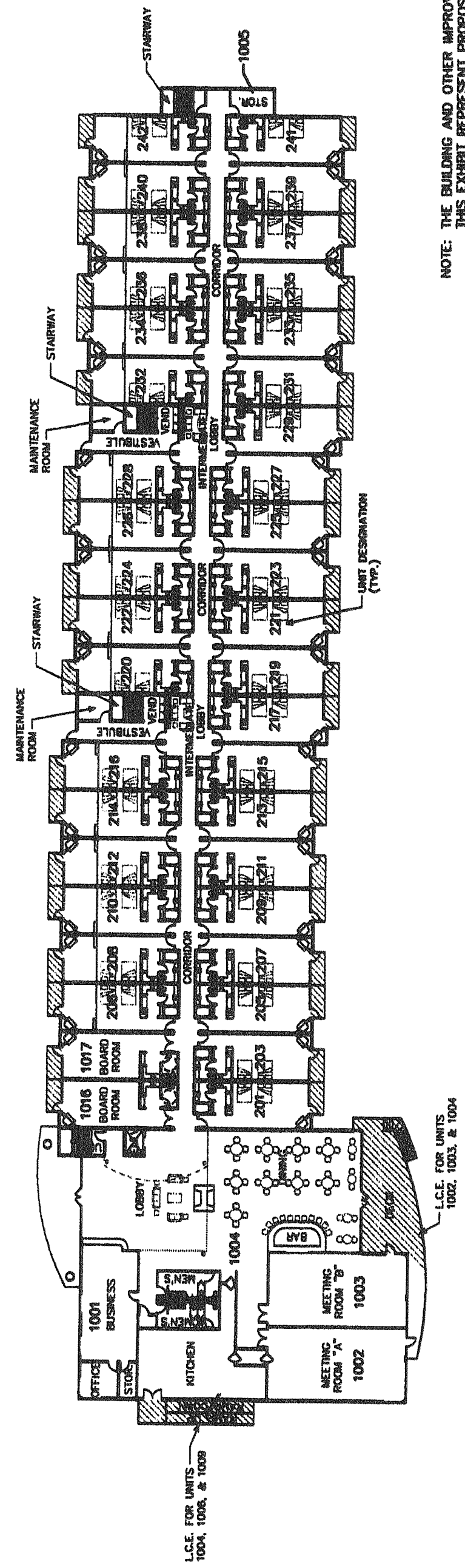

NOTE: THE BUILDING AND OTHER IMPROVEMENTS SHOWN ON THIS EXHIBIT REPRESENT PROPOSED CONSTRUCTION NOT BEGUN AS OF THE DATE HEREOF.

### SECOND LEVEL FLOOR PLAN

SCALE: 1/32" = 1'-0"  
(SEE SHEET 6 & 7 FOR INDIVIDUAL UNIT DIAGRAMS)

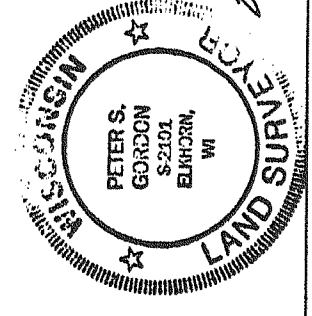

**FARRIS, HANSEN & ASSOCIATES, INC.**  
ENGINEERING - ARCHITECTURE - SURVEYING  
7 RIDGWAY COURT, PO BOX 437  
ELKHORN, WISCONSIN 53121  
PHONE: (262) 723-2098  
FAX: (262) 723-5886  
PROJ. NO. 328853 | DATE: 02/23/2001