

GENEVA NATIONAL CONDOMINIUM NO. 53S CONDOMINIUM PLAT

LOCATED IN PART OF THE NW 1/4 AND SW 1/4 OF THE SW 1/4 OF SECTION
29, TOWN 2 NORTH, RANGE 17 EAST, WALWORTH COUNTY, WISCONSIN

HATCHED AREAS REPRESENT LIMITED
COMMON ELEMENT (L.C.E.)

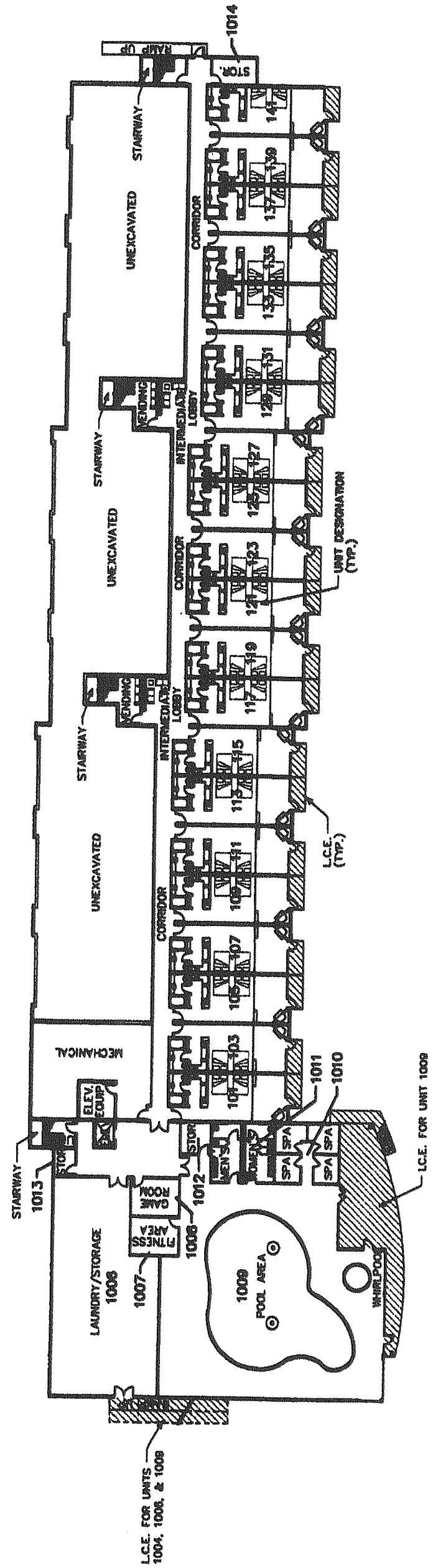

NOTE: THE BUILDING AND OTHER IMPROVEMENTS SHOWN ON
THIS EXHIBIT REPRESENT PROPOSED CONSTRUCTION
NOT BEGUN AS OF THE DATE HEREOF.

FIRST LEVEL FLOOR PLAN

SCALE: 1/32" = 1'-0"
(SEE SHEET 6 & 7 FOR INDIVIDUAL UNIT DIAGRAMS)

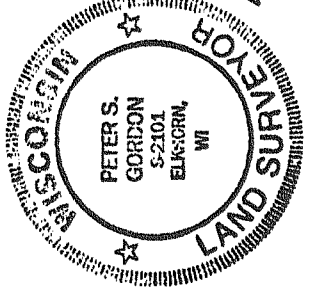

FARRIS, HANSEN & ASSOCIATES, INC.
 ENGINEERING - ARCHITECTURE - SURVEYING
 7 RIDGWAY COURT, PO BOX 437
 ELKHORN, WISCONSIN 53121
 PHONE: (262) 723-2098
 FAX: (262) 723-5886
 PROJ. NO. 326853 | DATE 02/23/2001