

**GENEVA NATIONAL CONDOMINIUM NO. 53N**  
**CONDOMINIUM PLAT**

LOCATED IN PART OF THE NW 1/4 AND SW 1/4 OF SECTION  
 28, TOWN 2 NORTH, RANGE 17 EAST, WALWORTH COUNTY, WISCONSIN

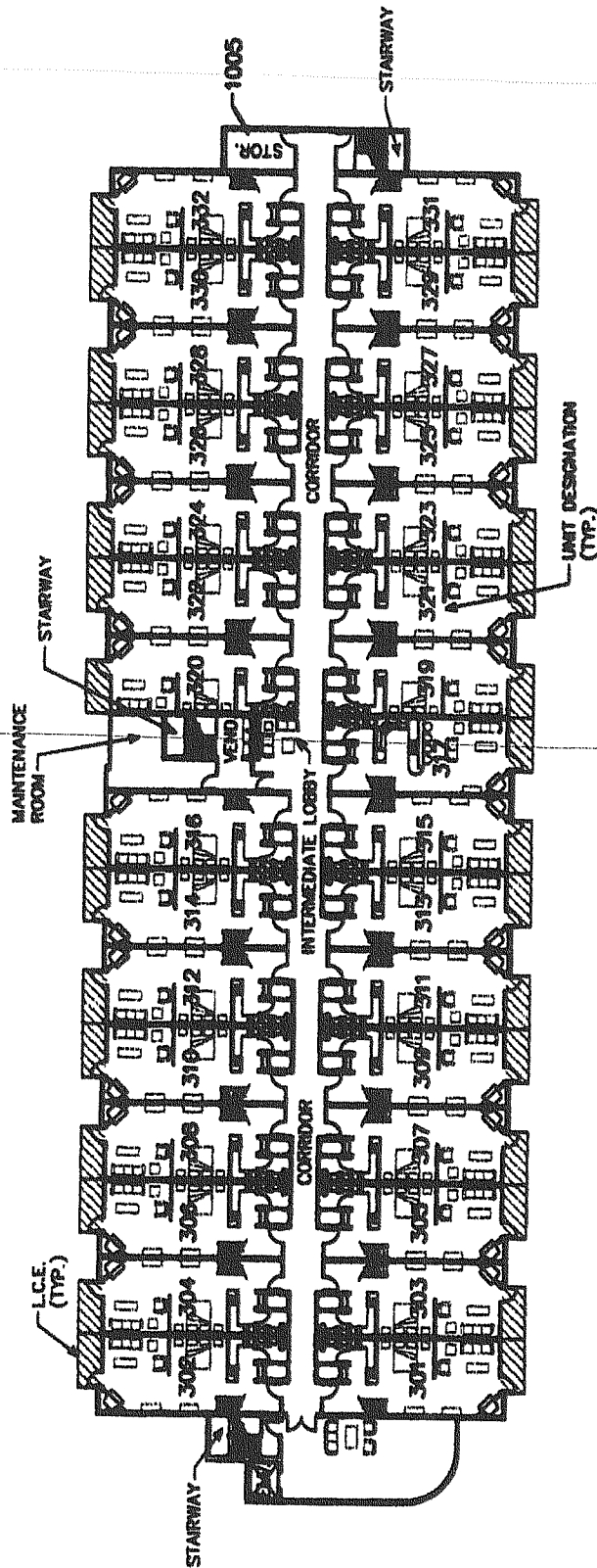

**LOFT LEVEL FLOOR PLAN**

SCALE: 1/32" = 1'-0"  
 (SEE SHEET 4 & 5 FOR INDIVIDUAL UNIT DIAGRAMS)

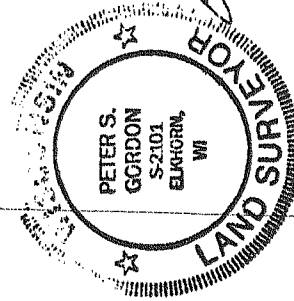

NOTE: THE BUILDING AND OTHER IMPROVEMENTS SHOWN ON  
 THIS EXHIBIT REPRESENT PROPOSED CONSTRUCTION  
 NOT BEGUN AS OF THE DATE HEREOF.

**THIRD LEVEL FLOOR PLAN**

SCALE: 1/32" = 1'-0"  
 (SEE SHEET 4 & 5 FOR INDIVIDUAL UNIT DIAGRAMS)

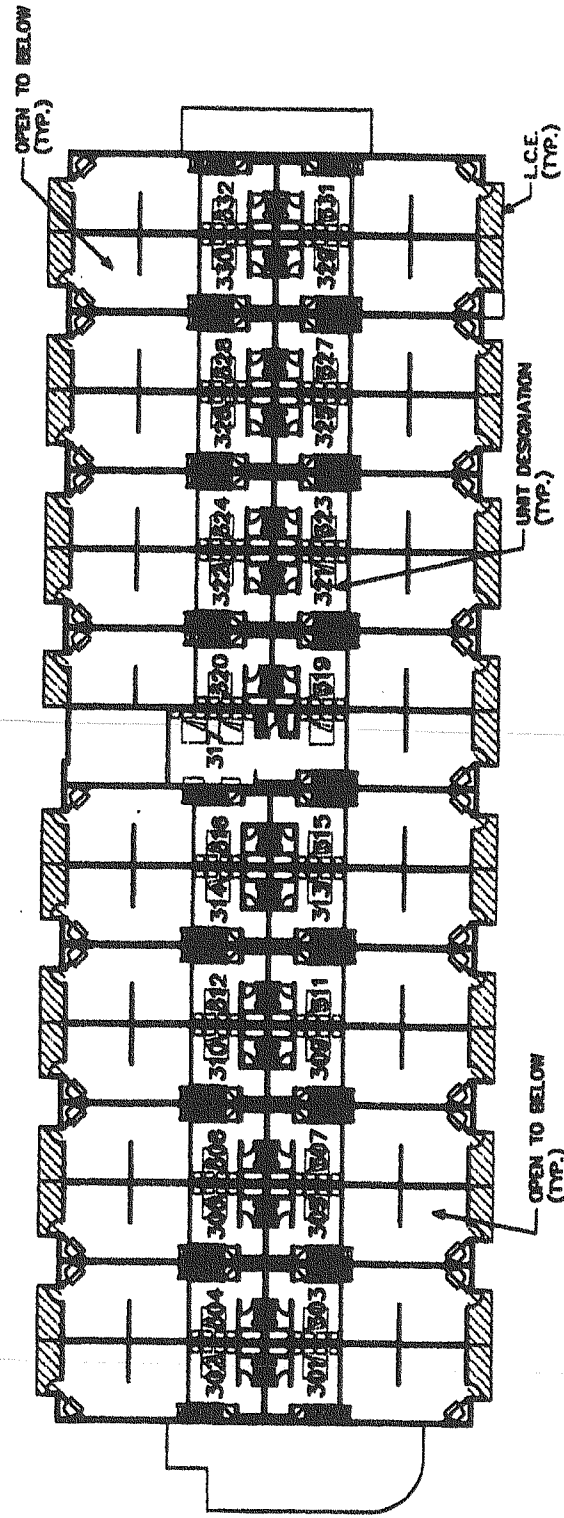

**FARRIS, HANSEN & ASSOCIATES, INC.**  
 ENGINEERING - ARCHITECTURE - SURVEYING  
 7 RIDGWAY COURT, PO BOX 437  
 ELKHORN, WISCONSIN 53121  
 PHONE: (262) 723-2088  
 FAX: (262) 723-5886  
 PROJ. NO. 3288L53 | DATE: 02/26/2001