

GENEVA NATIONAL CONDOMINIUM NO. 53N
CONDOMINIUM PLAT
 LOCATED IN PART OF THE NW 1/4 AND SW 1/4 OF THE SW 1/4 OF SECTION
 29, TOWN 2 NORTH, RANGE 17 EAST, WALWORTH COUNTY, WISCONSIN

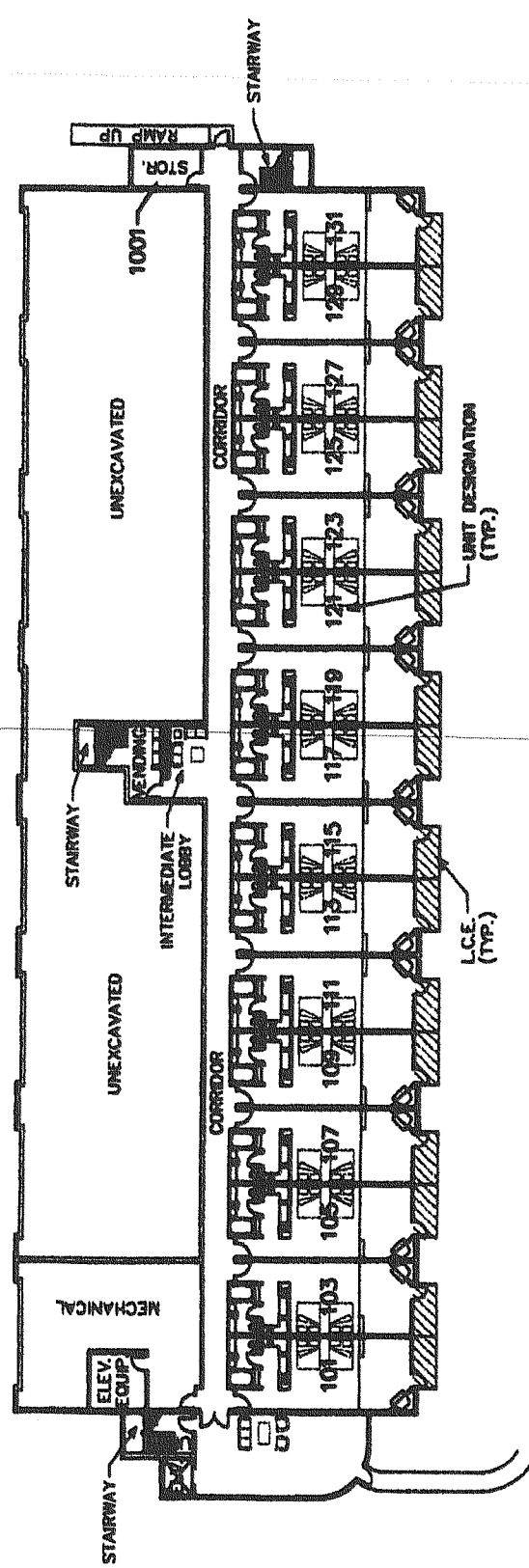

FIRST LEVEL FLOOR PLAN

SCALE: 1/32" = 1'-0"
 (SEE SHEET 4 & 5 FOR INDIVIDUAL UNIT DIAGRAMS)

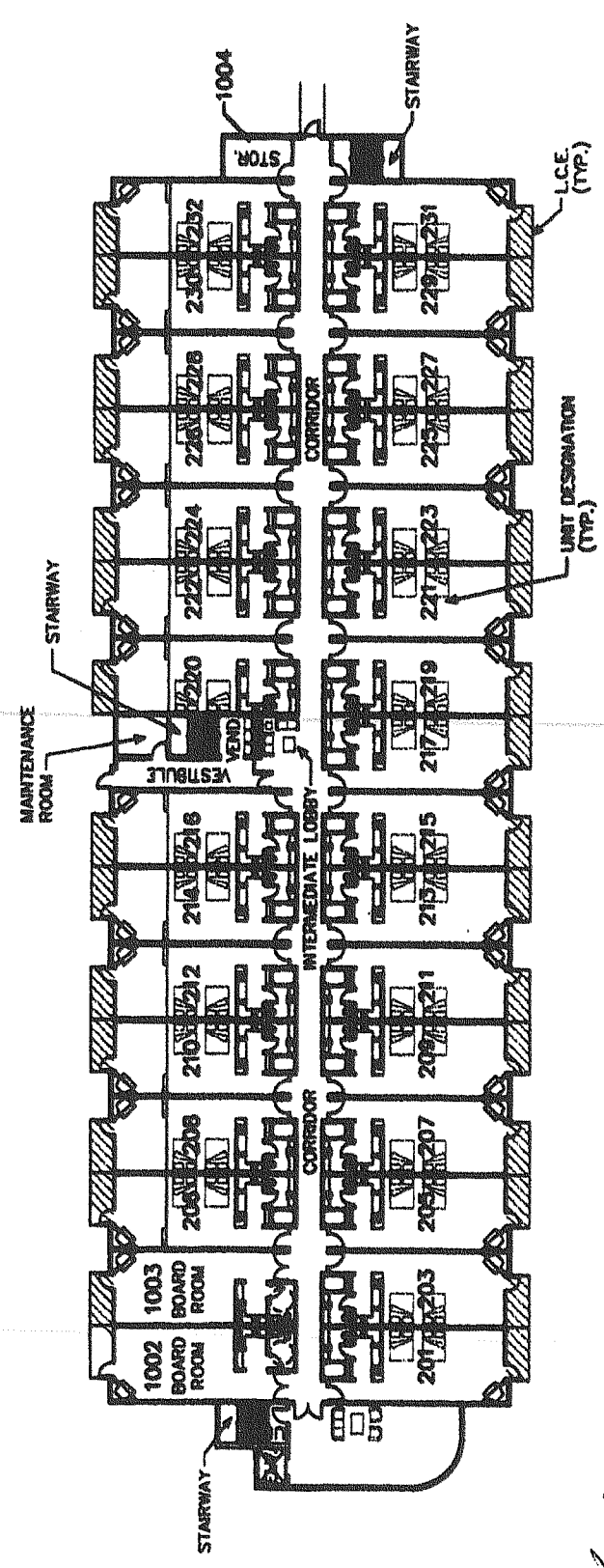

SECOND LEVEL FLOOR PLAN

SCALE: 1/32" = 1'-0"
 (SEE SHEET 4 & 5 FOR INDIVIDUAL UNIT DIAGRAMS)

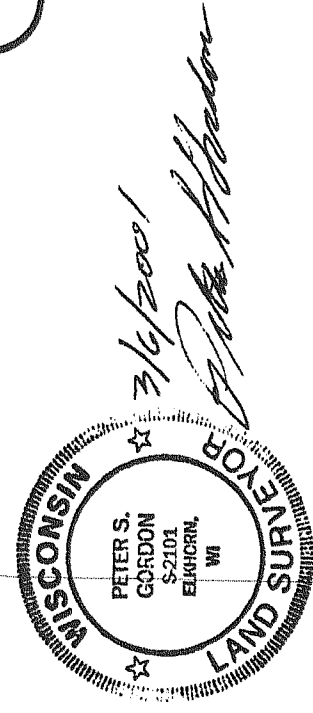

NOTE: THE BUILDING AND OTHER IMPROVEMENTS SHOWN ON
 THIS EXHIBIT REPRESENT PROPOSED CONSTRUCTION
 NOT BEGUN AS OF THE DATE HEREOF.

FARRIS, HANSEN & ASSOCIATES, INC.
 ENGINEERING - ARCHITECTURE - SURVEYING
 7 RIDGWAY COURT, PO BOX 437
 ELKHORN, WISCONSIN 53121
 PHONE: (262) 723-2098
 FAX: (262) 723-5886
 PROJ. NO. 2008.53 | DATE: 02/28/2001

HATCHED AREAS REPRESENT LIMITED
 COMMON ELEMENT (L.C.E.)