

REC'D BY DEPT. OF  
WALWORTH COUNTY WIS  
JUL 10 1992

# GENEVA NATIONAL CONDOMINIUM NO. 35 WALWORTH COUNTY, WISCONSIN

LOCATED IN THE SW 1/4 SE 1/4 & SE 1/4 SE 1/4 SEC. 19  
AND IN THE NW 1/4 NE 1/4 & NE 1/4 NE 1/4 SEC. 30  
TOWN 2 NORTH, RANGE 17 EAST

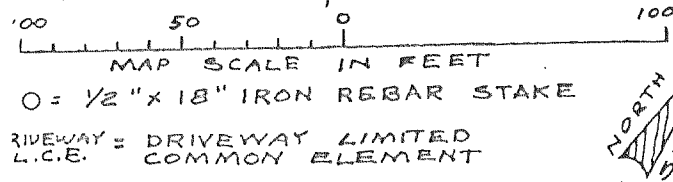

NOTE: A UNIT IS A CUBICLE OF AIR HAVING VERTICAL SIDES FORMED BY THE PLANES EXTENDING UPWARD FROM THE SURFACE BOUNDARY LINES OF THE RESIDENCE GROUNDS, HAVING A LOWER SIDE FORMED BY THE SURFACE OF SUCH RESIDENCE GROUNDS, AND HAVING AN UPPER SIDE 40 FEET ABOVE AND PARALLEL TO THE SURFACE OF SUCH RESIDENCE GROUNDS. APPURTENANT TO EACH UNIT IS AN EXCLUSIVE AND PERPETUAL RIGHT AND EASEMENT TO USE SURFACE AND SUBSURFACE IMPROVEMENTS, INCLUDING, BUT NOT LIMITED TO, BUILDINGS, DRIVEWAYS, WALKWAYS AND BUILDING FOUNDATIONS TOGETHER WITH ANY BASEMENTS CONSTRUCTED THEREWITH BY DECLARANT UPON SUCH RESIDENCE GROUNDS, FOR THE USE AND ENJOYMENT OF SUCH UNIT IN ACCORDANCE WITH THE TERMS OF THE DECLARATION OF CONDOMINIUM AND THE CCR'S.

NOTE: COMMON ELEMENTS = ALL OF THE CONDOMINIUM EXCEPT THE UNITS.

NOTE A: LOCATION OF CART PATH AND RAINAGE EASEMENT RECORDED IN VOLUME 499 OF RECORDS ON PAGE 827 & DOCUMENT NO. 200785.

NOTE B: LOCATION OF PEDESTRIAN AND GOLF CART EASEMENT AND LOCATION OF CONSTRUCTION, MAINTENANCE AND REPAIR EASEMENT GRANTED PURSUANT TO SECTION 3.11(C) AND SECTION 3.11(D) RESPECTIVELY OF THE CCR'S.

NOTE C: LOCATION OF PEDESTRIAN AND GOLF CART EASEMENT PURSUANT TO SECTION 3.11(C) OF THE CCR'S.

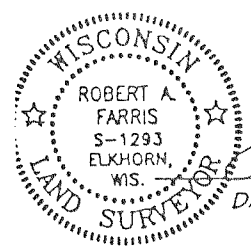

*Robert A. Farris*  
DATED: 06/23/92

ORDERED BY: GN PARTNERS, AN ILLINOIS GENERAL PARTNERSHIP

RIS, HANSEN & ASSOC. INC.  
ENGINEERING, ARCHITECTURE, SURVEYING  
7 RIDGEWAY COURT - P.O. BOX 437  
ELKHORN, WISCONSIN 53121

EXHIBIT **A** CONDOMINIUM PLAT  
SHEET 1 OF 11 SHEETS



REVISIONS: 04/30/01

