

# PLAT OF SURVEY

THE SOUTH 1/2 OF LOT 1, LOTS 2 & 3  
MCGREGOR HIGHLANDS SUBDIVISION

LOCATED IN GOV'T. LOT 2 IN  
THE SE 1/4 OF THE NE 1/4 OF FRACT. SECT. 9  
TOWN 4 NORTH, RANGE 18 EAST  
WALWORTH COUNTY, WISCONSIN

S 00° 00' 45" E 189.68'  
(SOUTH 188.56')



EAST RIGHT OF WAY LINE  
EAST SHORE DRIVE ASSIGNED  
N 09° 59' W PER SUBDIVISION PLAT

- LEGEND**
- = FOUND IRON PIPE STAKE
  - ⊙ = FOUND IRON PIPE STAKE  
IN 5" ROUND CONCRETE MONUMENT
  - = SET IRON REBAR STAKE
  - (---) = RECORDED AS

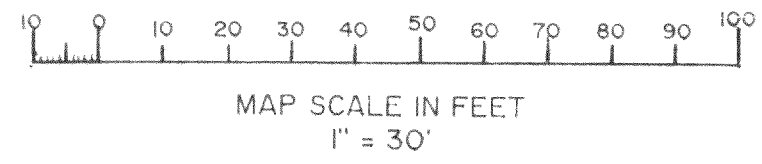

PLAT OF SURVEY  
THE S. 1/2 OF LOT 1, AND LOTS 2 & 3  
MCGREGOR HIGHLANDS SUBDIVISION  
TOWN OF EAST TROY  
WALWORTH COUNTY, WISCONSIN

**FARRIS, HANSEN & ASSOCIATES, INC.**  
Engineering, Architecture, Surveying  
7 Ridgway Court P.O. Box 437  
ELKHORN, WISCONSIN 53121  
Office: (414) 723-2098  
Fax: (414) 723-5886

REVISIONS

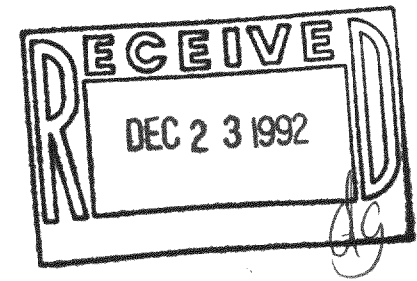
NOTE: COPIES OF THIS MAP TO WHICH THE FOLLOWING CERTIFICATE WILL APPLY ARE BLUE LINE PRINTS SHOWING SURVEYOR'S ORIGINAL SEAL AND SIGNATURE IN BLACK INK. COPIES BY ANY OTHER MEANS MAY HAVE ALTERATIONS WHICH DO NOT REPRESENT THE SURVEYOR'S WORK PRODUCT.

I HEREBY CERTIFY THAT THIS PLAT OF SURVEY IS A TRUE AND ACCURATE REPRESENTATION OF THE BOUNDARY LINES OF THE SUBJECT PARCEL AND SHOWS THE SIZE AND LOCATION OF THE PROPOSED ADDITION TO THE BEST OF MY PROFESSIONAL KNOWLEDGE AND BELIEF. THIS SURVEY IS MADE FOR THE USE OF THE PRESENT OWNERS OF THE PROPERTY, AND ALSO THOSE WHO PURCHASE, MORTGAGE, OR GUARANTEE THE TITLE THERETO WITHIN ONE YEAR FROM THE DATE HEREOF.

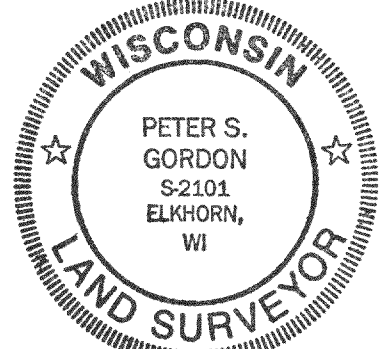

DATED: Nov. 25, 1992 *Peter S. Gordon*  
PETER S. GORDON RLS 2101

WORK ORDERED BY: DUANE SCHNEIDER

PMGH-1A  
PMGH-2  
PMGH-3

PROJECT NO  
3753  
DATE  
11/25/1992  
SHEET NO.  
1 OF 1