

Lot 23

Outlot 1

Lot 9

Tax Parcel  
HLG 2600002A

Mound System

Trellis

B.S.B.L. - Building Setback Line  
As shown on the plat of Pebble Beach.

(N89°31'51"W 190.68')  
S89°37'41"E 190.78'

Lot 8

Tax Parcel  
HPE 00031

0.794 Acre  
34,598 Sq.Ft.

House  
W5291

Deck

Screen Porch

Well

Court Lane  
(66' Wide)

# Plat of Survey

of

Lot 8 in Block 2 of Pebble Beach,

a subdivision located in the Northwest 1/4 of Section 25, Town 4 North,  
Range 16 East, Town of LaGrange, Walworth County, Wisconsin.

Surveyed for: **Debra Curcio**  
119 Saddlebrook Drive  
Oakbrook, Illinois. 60521

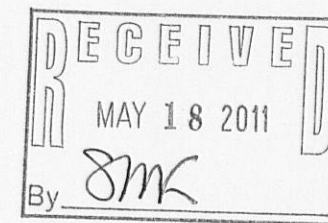
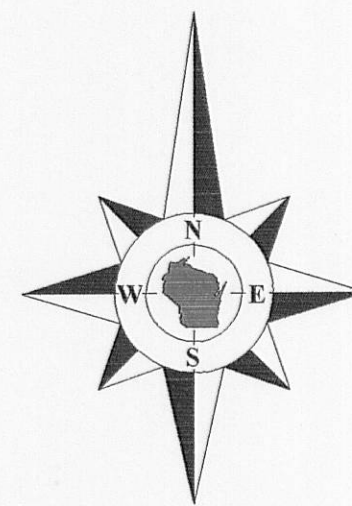

Bearings referenced to the West line of Lot 8  
recorded as North on the plat of Pebble Beach.

Copyright 2010 by Jensen & Olson Land Surveying, LLC.

All rights reserved. No part of this survey plat may be reproduced or transmitted in any form by any means - graphic, electronic, or mechanical, including photocopying, tracing, or information storage and retrieval systems - without permission in writing from Douglas G. Olson, Jensen & Olson Land Surveying, LLC.

I, Douglas G. Olson, Wisconsin Registered Land Surveyor, do hereby certify that this survey was performed by me, or under my direction in full compliance with the owner's/agent's instructions and Chapter A-E 7 of the Wisconsin Administrative Code "Minimum Standards for Property Surveys", and that this map is an accurate representation thereof to the best of my knowledge and belief.

Douglas G. Olson  
Wisconsin Registered Land Surveyor - 2093

## Notes:

- This survey plat is not certified unless signed and sealed in red ink.
- This survey is subject to Wisconsin lien laws. This Plat of Survey is the notice of intent to file lien. Lien waiver required.

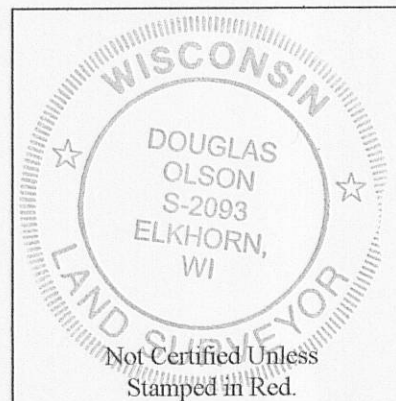

Survey Date: October 20, 2010.  
Revisions:

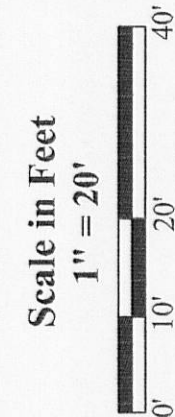

**Jensen & Olson Land Surveying, LLC**

45 South Wisconsin Street \* P.O. Box 322 \* Elkhorn, Wisconsin. 53121  
Telephone: (262) 723-3434 \* Facsimile: (262) 723-8044  
Email: jensen.olson@elknet.net

## Legend

- Found Concrete Monument
- Found Iron Pipe
- Recorded Information
- Utility Box or Pedestal
- Concrete Cover
- Asphalt Surface
- Concrete Surface
- Brick

Sheet 1 of 1 Sheets

Job Reference Number

2010.100

2010.100

HPE -31

416-2533

710-9200