

LOT 2
C.S.M. NO. 627
BULTHUIS PROPERTY

LOT 23
TREIBER PROPERTY

LOT 21
FIGARO PROPERTY

LOT 20
WOODMAN PROPERTY



SCALE - 1"=20'
LEGEND
○ - IRON PIPE FOUND
⊕ - CUT CROSS IN CONCRETE FOUND
() - RECORDED AS

PREPARED BY: ABELL SURVEYING & MAPPING
1140 SEQUOIA STREET
DELAVAN, WI. 53115
414-728-6737

PLAT OF SURVEY OF

LOTS 20-23, BLOCK 3, CARSWELL'S PARK, TOWN 4 NORTH, RANGE 16 EAST, WALWORTH COUNTY, WISCONSIN.

ORDERED BY: GODFREY, PFEIL & NESHEK, S.C.
P.O. BOX 291
ELKHORN, WI. 53121

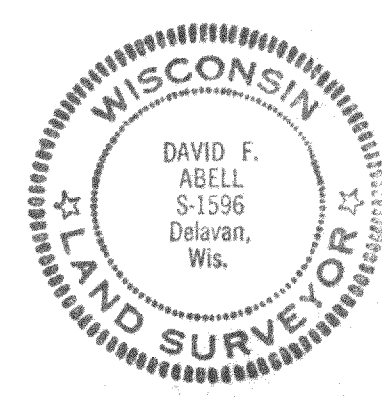
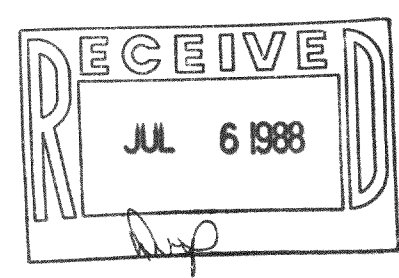

I, DAVID F. ABELL, DO HEREBY CERTIFY THAT I HAVE SURVEYED THE PROPERTY HEREON DESCRIBED ACCORDING TO THE OFFICIAL RECORDS AND THAT THE PLAT HEREON IS A CORRECT REPRESENTATION OF THE PROPERTY LINES TO THE BEST OF MY KNOWLEDGE AND BELIEF.

David F. Abell
DAVID F. ABELL

WISCONSIN REGISTERED LAND SURVEYOR, S-1596

DATE *May 6, 1988*

JOB NUMBER - 87036