

PLAT OF SURVEY

NORTH 1/4 CORNER
SECTION 14-3-18

NORTH LINE SECTION 14-3-18

NORTHEAST CORNER
SECTION 14-3-18

PARCEL "A"

THE NORTH 20 ACRES OF THE NORTHEAST 1/4 OF THE NORTHEAST 1/4 OF SECTION 14, TOWN 3 NORTH, RANGE 18 EAST, TOWN OF SPRING PRAIRIE, WALWORTH COUNTY, WISCONSIN, DESCRIBED AS FOLLOWS:

BEGIN AT A FOUND LIMESTONE MONUMENT AT THE NORTHEAST CORNER OF SAID SECTION 14; THENCE S 0°07'40" W ALONG THE EAST LINE OF THE NORTHEAST 1/4 OF SAID SECTION 14 660.06 FEET TO AN IRON ROD; THENCE N 88°07'31" W PARALLEL TO THE NORTH LINE OF THE NORTHEAST 1/4 OF SAID SECTION 14 1319.90 FEET TO AN IRON ROD ON THE WEST LINE OF THE NORTHEAST 1/4 OF THE NORTHEAST 1/4 OF SAID SECTION 14; THENCE N 0°01'38" E ALONG THE SAID WEST LINE 660.11 FEET TO AN IRON ROD AT THE NORTHWEST CORNER OF THE NORTHEAST 1/4 OF THE NORTHEAST 1/4 OF SAID SECTION 14; THENCE S 88°07'31" E ALONG THE NORTH LINE OF THE NORTHEAST 1/4 OF SAID SECTION 14 1321.06 FEET TO THE POINT OF BEGINNING. SAID PARCEL CONTAINS 20 ACRES OF LAND MORE OR LESS. "THIS LOT LINE ADJUSTMENT BETWEEN ADJOINING LAND OWNERS DOES NOT CREATE ADDITIONAL LOTS AND THE ORIGINAL PARCELS ARE NOT REDUCED BELOW THE MINIMUM SIZE REQUIRED BY THE WALWORTH COUNTY ZONING ORDINANCES."

TOGETHER WITH:

A PERPETUAL EASEMENT FOR INGRESS & EGRESS OVER A 24.75 FEET WIDE STRIP HELD IN TITLE FOR ACCESS TO THE NORTHEAST 1/4 OF THE NORTHEAST 1/4, AS RECORDED IN VOLUME 86, PAGE 488, DATED 12/18/1895 AS SHOWN ON CERTIFIED SURVEY MAP NUMBER 2331, AND THE EAST 66.00 FEET OF CERTIFIED SURVEY MAP NUMBER 2331 AS SHOWN ON CERTIFIED SURVEY MAP NUMBER 2331 AND THE EAST 66.00 FEET OF PARCEL "C".

PARCEL "B"

A PARCEL OF LAND LOCATED IN PART OF THE NORTHEAST 1/4 OF THE NORTHEAST 1/4 OF SECTION 14, TOWN 3 NORTH, RANGE 18 EAST, TOWN OF SPRING PRAIRIE, WALWORTH COUNTY, WISCONSIN, DESCRIBED AS FOLLOWS:

COMMENCE AT A FOUND LIMESTONE MONUMENT AT THE NORTHEAST CORNER OF SAID SECTION 14; THENCE S 0°07'40" W ALONG THE EAST LINE OF THE NORTHEAST 1/4 OF SAID SECTION 14 660.06 FEET TO AN IRON ROD; THENCE N 88°07'31" W PARALLEL TO THE NORTH LINE OF THE NORTHEAST 1/4 OF SAID SECTION 14 968.59 FEET TO AN IRON ROD AND THE POINT OF BEGINNING; THENCE CONTINUE N 88°07'31" W 351.31 FEET TO AN IRON ROD ON THE WEST LINE OF THE NORTHEAST 1/4 OF THE NORTHEAST 1/4 OF SAID SECTION 14; THENCE S 0°01'38" W ALONG THE SAID WEST LINE 672.22 FEET TO AN IRON PIPE AT THE SOUTHWEST CORNER OF THE NORTHEAST 1/4 OF THE NORTHEAST 1/4 OF SAID SECTION 14 AS OCCUPIED; THENCE S 85°22'35" E ALONG THE SOUTH LINE OF THE NORTHEAST 1/4 OF THE NORTHEAST 1/4 OF SAID SECTION 14 AS OCCUPIED 544.18 FEET TO AN IRON ROD AT THE SOUTHWEST CORNER OF CERTIFIED SURVEY MAP NUMBER 2331; THENCE N 15°09'51" W 730.01 FEET TO THE POINT OF BEGINNING. SAID PARCEL CONTAINS 7 ACRES OF LAND MORE OR LESS. "THIS LOT LINE ADJUSTMENT BETWEEN ADJOINING LAND OWNERS DOES NOT CREATE ADDITIONAL LOTS AND THE ORIGINAL PARCELS ARE NOT REDUCED BELOW THE MINIMUM SIZE REQUIRED BY THE WALWORTH COUNTY ZONING ORDINANCES."

PARCEL "C"

A PARCEL OF LAND LOCATED IN PART OF THE NORTHEAST 1/4 OF THE NORTHEAST 1/4 OF SECTION 14, TOWN 3 NORTH, RANGE 18 EAST, TOWN OF SPRING PRAIRIE, WALWORTH COUNTY, WISCONSIN, DESCRIBED AS FOLLOWS:

COMMENCE AT A FOUND LIMESTONE MONUMENT AT THE NORTHEAST CORNER OF SAID SECTION 14; THENCE S 0°07'40" W ALONG THE EAST LINE OF THE NORTHEAST 1/4 OF SAID SECTION 14 660.06 FEET TO AN IRON ROD AND THE POINT OF BEGINNING; THENCE CONTINUE S 0°07'40" E ALONG THE EAST LINE OF SAID SECTION 14 219.12 FEET TO AN IRON ROD AT THE NORTHEAST CORNER OF CERTIFIED SURVEY MAP NUMBER 2331; THENCE N 85°22'35" W ALONG THE NORTH LINE OF SAID CERTIFIED SURVEY MAP 608.28 FEET TO AN IRON ROD; THENCE S 44°41'53" W ALONG THE NORTHWEST LINE OF SAID CERTIFIED SURVEY MAP 200.00 FEET TO AN IRON ROD; THENCE S 4°42'00" W ALONG THE WEST LINE OF SAID CERTIFIED SURVEY MAP 361.86 FEET TO AN IRON ROD AT THE SOUTHWEST CORNER OF SAID CERTIFIED SURVEY MAP; THENCE N 15°09'51" W 730.01 FEET TO AN IRON ROD; THENCE S 88°07'31" E PARALLEL TO THE NORTH LINE OF THE NORTHEAST 1/4 SAID SECTION 14 968.59 FEET TO THE POINT OF BEGINNING. SAID PARCEL CONTAINS 5.6 ACRES OF LAND MORE OR LESS. "THIS LOT LINE ADJUSTMENT BETWEEN ADJOINING LAND OWNERS DOES NOT CREATE ADDITIONAL LOTS AND THE ORIGINAL PARCELS ARE NOT REDUCED BELOW THE MINIMUM SIZE REQUIRED BY THE WALWORTH COUNTY ZONING ORDINANCES."

TOGETHER WITH:

A PERPETUAL EASEMENT FOR INGRESS & EGRESS OVER THE EAST 66.00 FEET OF THE ABOVE DESCRIBED PARCEL FOR ACCESS TO THE NORTH 20 ACRES OF THE NORTHEAST 1/4 OF THE NORTHEAST 1/4 OF SECTION 14, TOWN 3 NORTH, RANGE 18 EAST, TOWN OF SPRING PRAIRIE, WALWORTH COUNTY, WISCONSIN.

WEST 1/4 CORNER
SECTION 14-3-18

SOUTH 1/4 CORNER
SECTION 14-3-18

TO TAX KEY INDEX NUMBER SP-11-6

PARCEL "A"

20 ACRES

VACANT LAND

TO TAX KEY INDEX NUMBER SP-14-2

PARCEL "B"

7 ACRES

VACANT LAND

TO CERTIFIED SURVEY MAP NUMBER 2331

PARCEL "C"

5.6 ACRES

VACANT LAND

CERTIFIED SURVEY
MAP NUMBER 2331

NOTES

- 1) THE EAST LINE OF THE NORTHEAST 1/4 OF SECTION 14-3-18 WAS ASSUMED TO BEAR S 0°07'40" E AS SHOWN ON CERTIFIED SURVEY MAP NUMBER 2331.
- 2) THE POND SHOWN ON THIS PLAT WAS DIGITIZED FROM THE WALWORTH COUNTY ZONING DISTRICT MAP NUMBER 6, ENCOMPASSING THE U.S. PUBLIC LAND SURVEY OF SECTIONS 13, 14, 23, AND 24, TOWNSHIP 3 NORTH, RANGE 18 EAST, TOWN OF SPRING PRAIRIE, WISCONSIN, DATE OF PHOTOGRAPHY: MARCH 1990. NO ACTUAL FIELD LOCATION WAS DONE.

Owner: Dan Finke
Post Office Box 30
Lyons, Wisconsin 53148

Legend

- FOUND IRON PIPE
- FOUND IRON ROD
- FOUND BRASS CAPPED MONUMENT
- FOUND CONCRETE MONUMENT
- CHISEL CUT IN CONCRETE
- SET IRON ROD, 24" LONG, WEIGHING 1.5 LBS., LINEAL FT. 1" DIA.
- SET IRON ROD, 30" LONG, WEIGHING 4.5 LBS., LINEAL FT. 1 1/16" DIA.
- RECORDED AS DIMENSION
- EXISTING FENCE
- FOUND LIMESTONE MONUMENT

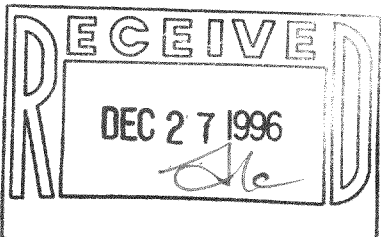

SCALE: 1"= 80 FEET

I hereby certify that the above described property has been surveyed by me in under my direction and that the above map is a true representation thereof and show the size and location of the property, its exterior boundaries, the location of all visible structures and dimensions of all principal buildings thereon, boundary lines, adjacent easements, roadways and visible encroachments, if any.

This survey is made for the use of the present owners of the property, and also those who purchase, mortgage, or guarantee the title thereto within one year from date hereof.

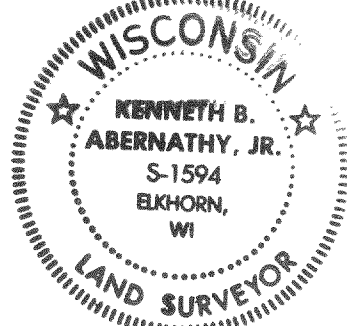

KENNETH B. ABERNATHY, JR.
WISCONSIN REGISTERED LAND SURVEYOR,
S-1594
REVISED DECEMBER 11, 1996
Date: NOVEMBER 21, 1996 Job No. 1996.1107