

## of

a subdivision recorded March 18, 2005 in Cab. D of Plats of Walworth County on Slide 4 as Document Number 633984 and located in the Northeast 1/4 of the Southwest 1/4 of Section 14, Town 3 North, Range 17 East, Town of LaFayette, Walworth County, Wisconsin.

Outlot 1

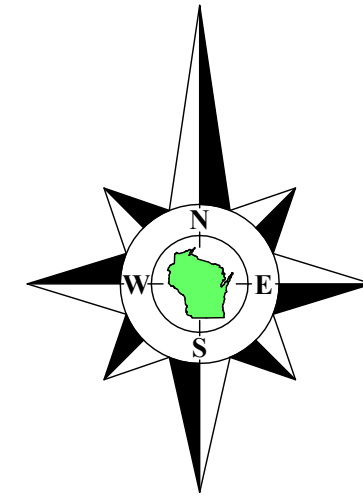

Coordinates are referenced to the Wisconsin State Plane Coordinate System, South Zone, (NAD-27).

Revisions:

Scale in Feet  
1" = 20'



A horizontal scale bar with alternating black and white segments. The segments are labeled 0', 10', 20', 40', and 60' at the right end. The bar is divided into 12 equal segments, each representing 5 feet.

45 South Wisconsin Street | P.O. Box 322  
Elkhorn, Wisconsin. 53121  
Telephone: (262) 723-3434  
Facsimile: (262) 723-8044  
Email: [doug@olsonsurveying.com](mailto:doug@olsonsurveying.com)  
Website: [www.olsonsurveying.com](http://www.olsonsurveying.com)

**OLSON**  
LAND SURVEYING, LLC  
Rural | Residential | Commercial

☐ Found County Section Corner  
☐ Found Iron Pipe, 1-3/16" dia.  
☐ Sound Iron Rod, 1-3/16" dia.  
☐ Set Iron Pipe, 1" dia.  
☐ ( ) Recorded Information  
☒ Utility Box or Pedestal  
☐ Asphalt Surface  
☒ Soil Boring

N	North
S	South
E	East
W	West
°	Degrees
'	Minutes
"	Seconds
	In Distances
	Feet
"	Inches

**Sheet 1 of 1 Sheets**

---

Drawing Name:

---

**Job Reference Number**

**2024.098**

---

2024.098

recorded as(N79°06'13"E 285.01')  
N79°13'17"E 285.04'

**60' Rearyard Setback**  
As shown on the plat of Sugar Creek Preserve.

Lot 40

0  
Recorded as (N37°37'20"W 257°30'  
N37°30'53"W 257°30'

M o w n      L a w n

**Primary Environmental Corridor Line**  
As shown on the plat of Sugar Creek Preserve

Edge of Woods  
Edge of Grass

Edge of Woods  
Edge of Grass

25' Streetyard Setback  
As shown on the plat of Sugar Creek Preserve.

(4.17')  
4.18'  
S89°27'05"W  
(S88°54'26"W)

Utility Easement  
of Sugar Creek Preserve.  
Chords=216.00', Chord=S70°44'40"  
Arc=137.66'  
(137.71')

**Preserve Drive** (66' Wide)

## Mailboxes

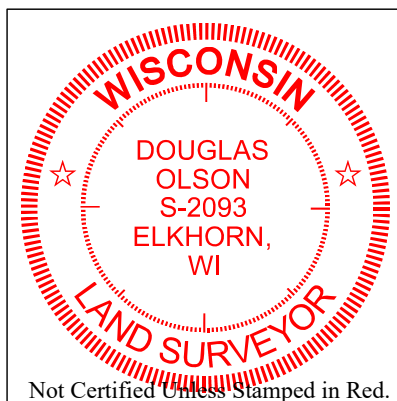

- 1) This Plat of Survey is not certified unless signed and sealed in red ink.
- 2) This survey is subject to Wisconsin lien laws. This Plat of Survey is the notice of intent to file lien. Lien waiver required.
- 3) The Survey Date shown on this Plat of Survey is the completion date of the field work.

All rights reserved. No part of this survey plat may be reproduced or transmitted in any form by any means - graphic, electronic, or mechanical, including photocopying, tracing, or information storage and retrieval systems - without permission in writing from Douglas G. Olson, Olson Land Surveying, LLC.

This survey is made for the exclusive use of the present owners of the property, and also those who purchase, mortgage or guarantee title thereto, within one year from the date hereof.

Douglas G. Olson  
Wisconsin Professional Land Surveyor - 2093