

Plat of Survey

of

Lot 53 of Baywood Estates 1st Addition,

recorded December 28, 1971 in Vol. 17 of Plats of Walworth County on Page 1 as Document Number 644844 and located in the Northwest 1/4 and the Northeast 1/4 of the Northwest 1/4 of Section 1, Town 3 North, Range 16 East, Town of Sugar Creek, Walworth County, Wisconsin.

Surveyed for: **Charles Wood**
W5213 Lakewood Circle
Elkhorn, Wisconsin. 53121

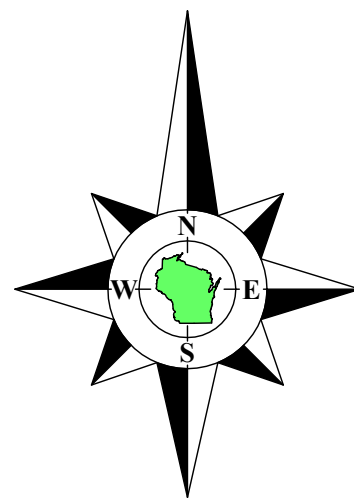

Bearings referenced to the West line of Lakewood Circle, recorded as N30°13'W on the plat of Baywood Estates 1st Addition, a rotation of 2°06'42" from the Wisconsin State Plane Coordinate System, South Zone, (NAD-27).
Coordinates are referenced to the Wisconsin State Plane Coordinate System, South Zone, (NAD-27).

North 1/4 Corner
Section 1-3-16
N. 279,178.07
E. 2,388,412.76

Plantation Road
(66' Wide)

Overhead Wires

Culvert

recorded as (N62°36'E 58.37')
N62°36'00"E 58.37'

recorded as (N56°56'E 45.00')
N57°03'05"E 45.00'

Found Rod 0.74'
N28°15'15"W of
corner - owner
stated soil tester
moved rod - RESET.

1" dia. pipe
in concrete

Foundation

Well

Lot 54

recorded as (N30°13'W 200.00')
N30°13'25"W 200.19'

Lot 53
Tax Parcel
GBEA 00030
0.513 Acre
22,340 Sq.Ft.

recorded as (S30°13'E 230.00')
S30°13'00"E 230.11'

Lakewood Circle
(66' Wide)

Driveway

Culvert

1" dia.

recorded as (S76°19'W 107.69')
S76°19'00"W 107.69'

Found pipe leaning
is 0.41' N53°34'28"E
of corner - RESET.

Deck

Screen
Porch

Lot 64

recorded as (N30°13'W 378.89')
N30°13'00"W 378.06'
(147.95')
(147.95')

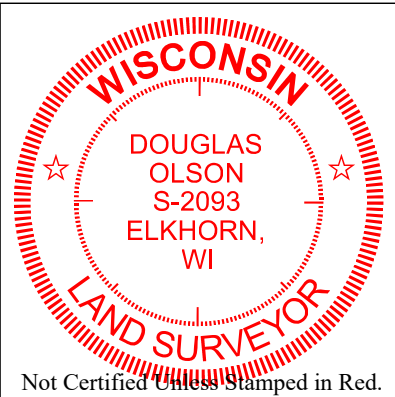

Notes:

- This Plat of Survey is not certified unless signed and sealed in red ink.
- This survey is subject to Wisconsin lien laws. This Plat of Survey is the notice of intent to file lien. Lien waiver required.
- The Survey Date shown on this Plat of Survey is the completion date of the field work.

Copyright ©2024 by Olson Land Surveying, LLC.

All rights reserved. No part of this survey plat may be reproduced or transmitted in any form by any means - graphic, electronic, or mechanical, including photocopying, tracing, or information storage and retrieval systems - without permission in writing from Douglas G. Olson, Olson Land Surveying, LLC.

I hereby certify that I have surveyed the above described property in compliance with Chapter A-E 7 of the Wisconsin Administrative Code and that the map hereon is correct to the best of my professional knowledge and belief and shows the size and location of the property, its exterior boundaries, the location and dimensions of all visible structures thereon, boundary fences, apparent easements and roadways and visible encroachments, if any.

This survey is made for the exclusive use of the present owners of the property, and also those who purchase, mortgage or guarantee title thereto, within one year from the date hereof.

Douglas G. Olson
Wisconsin Professional Land Surveyor - 2093

Sheet 1 of 1 Sheets

Drawing Name:

Job Reference Number
2024.069

Legend of Symbols & Abbreviations

- Found County Section Corner
- Found Iron Pipe
- Found Iron Rod
- Set Iron Pipe, 1" dia.
- Recorded Information
- Utility Pole
- Utility Pedestal
- Septic Vent
- Asphalt Surface
- Gravel Surface

N North
S South
E East
W West
In Bearings
° Degrees
' Minutes
" Seconds
In Distances
' Feet
" Inches



45 South Wisconsin Street | P.O. Box 322
Elkhorn, Wisconsin. 53121
Telephone: (262) 723-3434
Facsimile: (262) 723-8044
Email: doug@olsonsurveying.com
Website: www.olsonsurveying.com

Scale in Feet
1" = 20'



Survey Date: July 11, 2024.
Revisions:

2024.069