

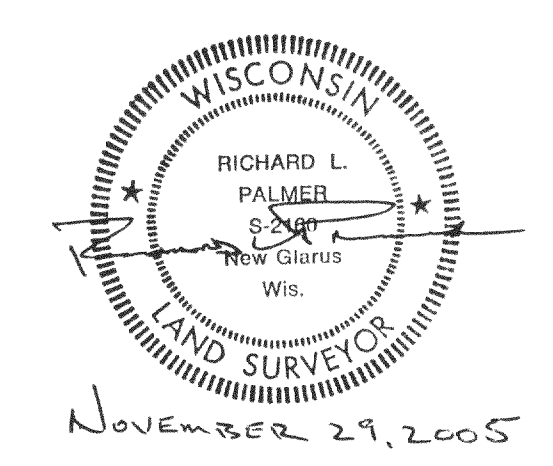

Description of Parcel A:
 All of Lots 39 - 48, Block A, North Lake Beach, Tract No. 3, lying in part of the Southeast 1/4 of the Southeast 1/4 of Section 05, Township 03 North, Range 16 East, Town of Sugar Creek, Walworth County, Wisconsin.
 Said parcel contains 40,375 square feet more or less to the waters edge of North Lake.

Description of Parcel B:
 All of Lots 1 - 7, Block 5, North Lake Beach, Tract No. 3, lying in part of the Southeast 1/4 of the Southeast 1/4 of Section 05, Township 03 North, Range 16 East, Town of Sugar Creek, Walworth County, Wisconsin.
 Said parcel contains 18,453 square feet.

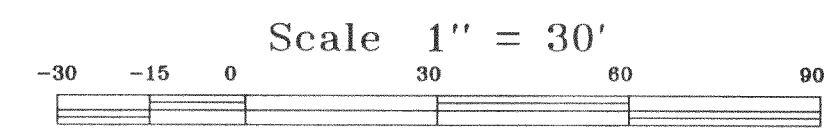

Survey Plat

LEGEND:
 1" = 30' feet
 ● 1.5" O.D. IRON STAKE FOUND
 ○ 1" O.D. IRON PIPE PLACED
 × 3/4" REBAR FOUND
 ⊙ 2" I.D. IRON PIPE FOUND
 () FENCE LINE
 RECORDED AS
 Surveyed by RP, JMP, JRS
 Drawn by RP
 Traced by hp 1055CM
 Approved by KLC
 Field Book 913, Pg. 78
 Date of Survey Nov 17, 2005
 Dir cont /data2/walworth/sugarcreek
 File Name 15424L
 Data Level PLAT

Royal Oak Engineering, Inc.
 5610 Medical Circle, Suite 6, Madison, WI, 53719
 Phone: (608) 274-0500 Fax: (608) 274-4530

SURVEYED FOR Mr. Chester Palmer
 W6562 Barkers Road
 Elkhorn, Wisconsin 53121

DESCRIPTION-LOCATION
 Lots 39-48, Block A and Lots 1-7, Block 5, North Lake Beach, Tract No. 3, lying in part of the Southeast 1/4 of the Southeast 1/4 of Section 05, Township 03 North, Range 16 East, Town of Sugar Creek, Walworth County, Wisconsin.
SURVEYOR'S CERTIFICATE
 I, Richard L. Palmer, Registered Professional Land Surveyor No. S-2160 of the State of Wisconsin, do hereby certify that this survey is in compliance with A-E 7 of the Wisconsin Administrative Code.
 I further certify that the lands described hereon were surveyed and mapped under my direction, and this map is a correct representation of the property described and pictured hereon in accordance with the information.

MAP NO. 15424 - L

GNLB3-308 GNLB3-310 GNLB3-312
 GNLB3-309 GNLB3-311 GNLB3-316 GNLB3-317

316-18a1