

Whitewater
Lake



Property Exhibit

of

A portion of Lot 3 in Block 3 of Chapel Hills Subdivision,

located in the Northeast 1/4 of Section 3, Town 3 North, Range
15 East, Town of Richmond, Walworth County, Wisconsin.

Surveyed for:

Phil James

N7273 Chapel Drive
Whitewater, Wisconsin. 53190

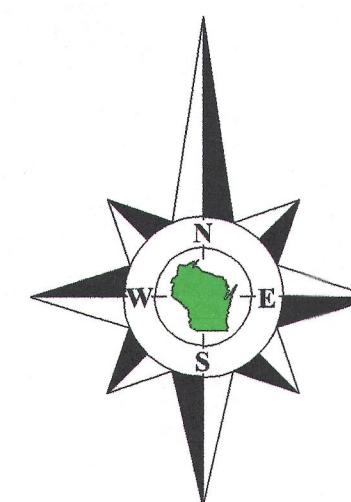

Bearings reference to the plat
of Chapel Hills Subdivision.

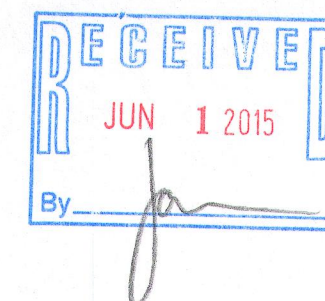
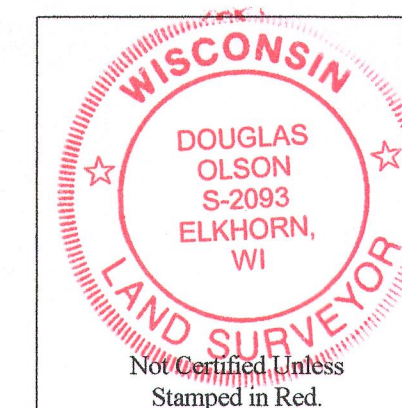

Notes:

- 1) This survey plat is not certified unless signed and sealed in red ink.
- 2) This survey is subject to Wisconsin lien laws. This Plat of Survey is the notice of intent to file lien. Lien waiver required.

Copyright 2014 by Jensen & Olson Land Surveying, LLC.

All rights reserved. No part of this survey plat may be reproduced or transmitted in any form by any means - graphic, electronic, or mechanical, including photocopying, tracing, or information storage and retrieval systems - without permission in writing from Douglas G. Olson, Jensen & Olson Land Surveying, LLC.

I, Douglas G. Olson, Wisconsin Registered Land Surveyor, do hereby certify that this survey was performed by me, or under my direction in full compliance with the owner's/agent's instructions and Chapter A-E 7 of the Wisconsin Administrative Code "Minimum Standards for Property Surveys"; and that this map is an accurate representation thereof to the best of my knowledge and belief.

Douglas G. Olson
Wisconsin Registered Land Surveyor - 2093

Survey Date: July 1, 2014.
Revisions: No. 1 - Proposed Addition
No. 2 - Foundation & Sonotubes

Scale in Feet
1" = 20'
0' 10' 20' 40'

Jensen & Olson Land Surveying, LLC
45 South Wisconsin Street * P.O. Box 322 * Elkhorn, Wisconsin. 53121
Telephone: (262) 723-3434 * Facsimile: (262) 723-8044
Email: jensen.olson@elknet.net

Legend
Found Iron Pipe
Recorded Information
Utility Pole
Utility Pedestal
Concrete Cover
Asphalt Surface
Concrete Surface
Brick Pavers or Patio Blocks

Sheet 1 of 1 Sheets
Drawing Name: Gm 15c-2014064-2014064(Exhibit)as
Job Reference Number
2014.064

2014.064

CCH-7A 315-1229