

ABERNATHY and ASSOCIATES

Kenneth B. Abernathy Jr.

Wisconsin Registered Land Surveyor S-1594

Rt. 3, Box 273
Elkhorn, Wisconsin 53121
Phone: (414) 723-4260 (office)
(414) 723-4813 (residence)

PLAT OF SURVEY

LOT 1 OF HEGEMAN'S
SUBDIVISION LOCATED IN
THE SOUTHWEST 1/4 OF
SECTION 10, TOWN 2 NORTH,
RANGE 18 EAST, TOWN OF
LYONS, WALWORTH COUNTY,
WISCONSIN.

ORDERED BY: BEAR REALTY
425 MILWAUKEE AVE.
BURLINGTON, WI. 53105

MILL STREET
66' WIDE

N 8°57'39" E 115.69'

20' WIDE UTILITY EASEMENT

CLEARWATER COURT
66' WIDE

N 89°01'00" E 116.35'

CONCRETE DRIVEWAY

UTILITY PEDESTAL

47.2'

16.9'

13.8'

12.1'

EXISTING RESIDENCE

24.2'

27.8'

7'

1.2'

35'

28'

1.5'

30.5'

10.9'

LOT 1
15,009 S.F.

LOT 2

S 5°14'21" W 136.07'

6' WIDE UTILITY EASEMENT

6' WIDE UTILITY EASEMENT

WELL

UTILITY PEDESTALS

N 81°02'19" W 129.44'

LOT 1 C.S.M. #2134

LOT 3



SCALE 1" = 20 FEET

Legend

- ⌵ FOUND IRON PIPE
- FOUND IRON ROD
- FOUND BRASS CAPPED MONUMENT
- FOUND CONCRETE MONUMENT
- + CHISEL CUT IN CONCRETE
- SET IRON ROD, 24" LONG, WEIGHING 1.5 LBS./LINEAL FT., 3/8" DIA.
- SET IRON ROD, 30" LONG, WEIGHING 4.5 LBS./LINEAL FT., 1-11/16" DIA.
- (XX) RECORDED AS DIMENSION
- - - - - EXISTING FENCE

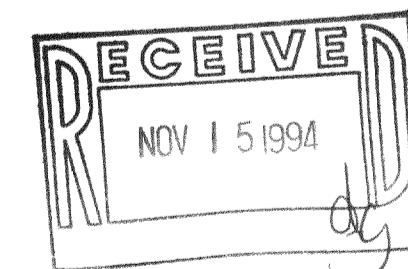

SCALE: 1" = 20 FEET

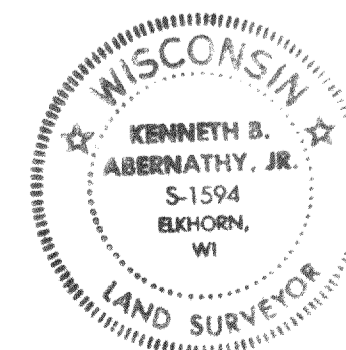

"I hereby certify that I have surveyed the above described property and that the above map is a true representation thereof and shows the size and location of the property, its exterior boundaries, the location of all visible structures and dimensions of all principal buildings thereon, boundary fences, apparent easements, roadways and visible encroachments, if any."
"This survey is made for the use of the present owners of the property, and also those who purchase, mortgage, or guarantee the title thereto within one year from date hereof."

Kenneth B. Abernathy, Jr.
KENNETH B. ABERNATHY, JR.
WISCONSIN REGISTERED LAND SURVEYOR,
S-1594

Date: 6-25-94 Job No. 94.623

NHE-1

218-7916