

PLAT OF SURVEY – TITLE SURVEY UNIT 3-40 OF GENEVA NATIONAL CONDOMINIUM NO. 3

LOCATED IN PART OF THE NW 1/4 OF THE SE 1/4 OF SECTION 30,
TOWN 2 NORTH, RANGE 17 EAST, WALWORTH COUNTY, WISCONSIN



Unit 3-40, together with said unit's undivided appurtenant interest in the common elements (and the exclusive use of the limited common elements appurtenant to said unit) all in Geneva National Condominium No. 3, a condominium declared and existing under and by virtue of the Condominium Ownership Act of the State of Wisconsin and recorded by a Declaration as such condominium in the Office of the Register of Deeds for Walworth County, Wisconsin, on June 26, 1991 in Volume 524, of Pages 855-907, as Document No. 213817, and any amendments and/or corrections thereto and by a Condominium Plat and any amendments and/or corrections thereto. Said condominium being located in the Town of Geneva, County of Walworth, State of Wisconsin on the real estate described in said Declaration and incorporated herein by this reference thereto.

Tax Key No. JGN 300040

Address: 1305 Saratoga Lane, Unit 3-40, Lake Geneva, WI 53147

LEGAL DESCRIPTION OF RECORD PER CHICAGO TITLE INSURANCE COMPANY,
COMMITMENT NUMBER: WA-24789

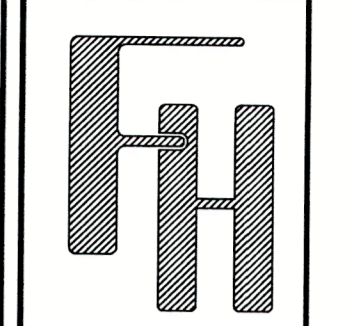
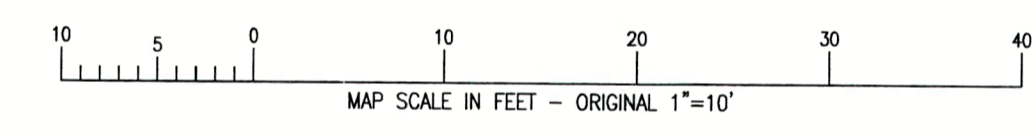
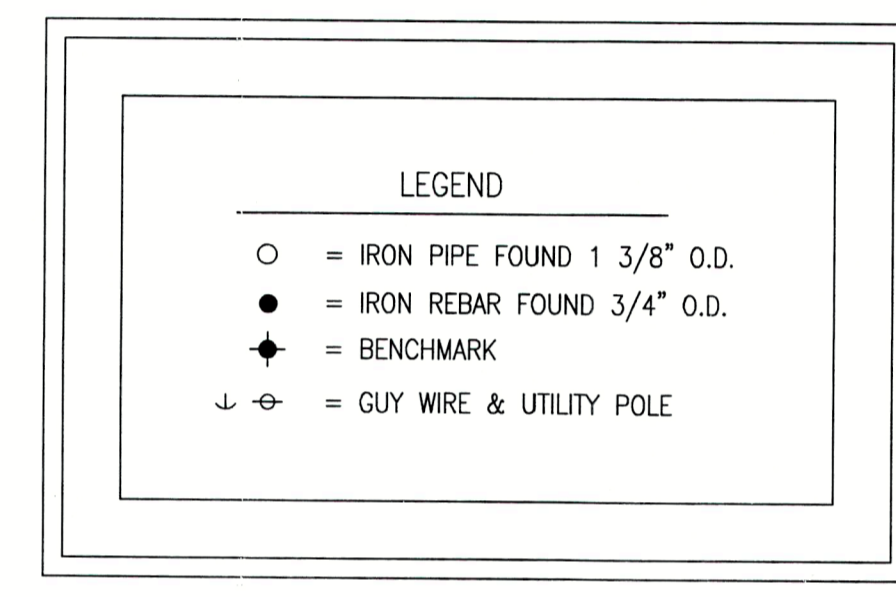
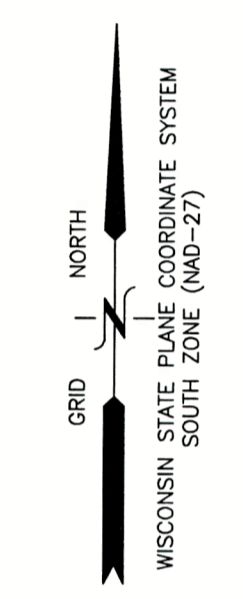

UNIT 3-40
TITLE SURVEY
1305 SARATOGA LANE, LAKE GENEVA, WISCONSIN

- WORK ORDERED BY -
COMPASS REALTY
101 GENEVA NATIONAL AVE. S.
LAKE GENEVA, WI 53147

FARRIS, HANSEN & ASSOCIATES, INC.
ENGINEERING - ARCHITECTURE - SURVEYING
7 RIDGWAY COURT P.O. BOX 437
ELKHORN, WISCONSIN 53121
OFFICE: (262) 723-2098 FAX: (262) 723-5886

REVISIONS
09/25/2018 - SB ADVANCEMENT PER G.N. COMMENTS
03/23/2026 - KK Update and title survey
04/07/2026 Add Pool and misc landscape features

NOTE: COPIES OF THIS MAP TO WHICH THE FOLLOWING CERTIFICATE WILL APPLY SHOW THE SURVEYOR'S ORIGINAL SEAL AND SIGNATURE IN RED INK. COPIES BY ANY OTHER MEANS MAY HAVE ALTERATIONS WHICH DO NOT REPRESENT THE SURVEYOR'S WORK PRODUCT.

I HEREBY CERTIFY THAT THE ABOVE DESCRIBED PROPERTY HAS BEEN SURVEYED UNDER MY DIRECTION AND THAT THE ABOVE MAP IS A TRUE REPRESENTATION THEREOF AND SHOWS THE SIZE AND LOCATION OF THE PROPERTY, ITS EXTERIOR BOUNDARIES, THE LOCATION OF ALL VISIBLE STRUCTURES, AND DIMENSIONS OF ALL PRINCIPLE BUILDINGS THEREON, BOUNDARY FENCES, APPARENT EASEMENTS, ROADWAYS, AND VISIBLE ENCROACHMENTS, IF ANY. THIS SURVEY IS MADE FOR THE USE OF THE PRESENT OWNERS OF THE PROPERTY, AND ALSO THOSE WHO PURCHASE, MORTGAGE, OR GUARANTEE THE TITLE THERETO WITHIN ONE YEAR FROM THE DATE HEREOF, FIELDWORK COMPLETED 03/20/2026.

DATED: 03/27/2026
Christopher A. Hodges
CHRISTOPHER A. HODGES P.L.S. 2760

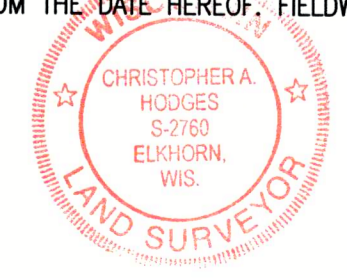

PROJECT NO. 3269-03-40.18
DATE 08/10/2018
SHEET NO. 1 OF 1

X:\Projects\3269\CONDO_03\UNIT_40\3269_03_40_1B\VCAD\3269_03_40_1B_Concept_Plan.dwg

JGN 3-40 217-5821