

PLAT OF SURVEY WITH TOPOGRAPHIC MAPPING

OF LOTS 9925 THRU 9931, BLOCK 181, OF THE FIFTH MAP OF LAKE COMO BEACH,
BEING PART OF THE NW 1/4 OF THE NW 1/4 OF SECTION 28, T. 2 N., R. 17 E.,
OF THE 4TH P.M., TOWN OF GENEVA, WALWORTH COUNTY, WISCONSIN

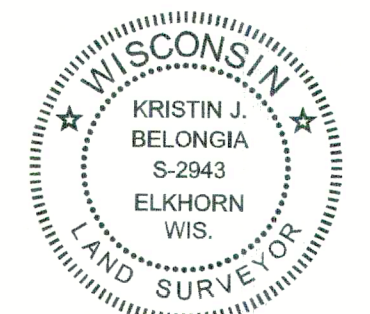

BENCHMARKS				
Point #	Northing (Y)	Easting (X)	Elevation	Description
1010	342492	774413	963.47	BM COTTON_SPINDLE



Kristin J. Belongia
 Kristin J. Belongia, P.L.S.
 Wisconsin Professional Land Surveyor S-2943
 State of Wisconsin } ss
 County of Walworth }
 I hereby certify that I have supervised the survey of the property described above and to the best of my knowledge and belief, the plat drawn hereon complies with Chapter A-E 7 of the State of Wisconsin Administrative Code, Minimum Standards for Property Surveys and correctly represents said survey and its location.
 Given under my hand and seal at Elkhorn, Wisconsin this 12th day of January, 2026
 Last day of field work January 9th, 2026

SURVEY NOTES
 1. SURVEYED PROPERTY SUBJECT TO ANY AND ALL EASEMENTS AND AGREEMENTS RECORDED AND UNRECORDED.
 2. THIS SURVEY IS A RETRACEMENT OF A SURVEY BY TERRY L. VAN ALSTINE, DATED 7-28-23.

MONUMENT KEY
 ● 3/4" Iron Rebar Found
 ○ 1" Iron Pipe Found
 (XXXXXX) Record Information
 ◆ Benchmark

- LEGEND**
- Existing Boundary Line
 - - - Existing Right-of-Way
 - - - Existing Adjacent Property
 - - - Existing Centerline
 - x Existing Fence
 - ⊠ Existing Electric Meter
 - ⊡ Existing Gas Meter
 - ⊢ Existing Water Valve
 - ⊙ Confiferous Tree
 - ⊙ Deciduous Tree
 - ⊙ Existing Spot Elevation
 - █ Existing Asphalt Pavement
 - █ Existing Concrete

Scale: 1" = 10'
 DISTANCE UNITS BASED ON THE UNITED STATES SURVEY FOOT
 BEARINGS BASED ON THE WISCONSIN COORDINATE REFERENCE SYSTEM, WALWORTH ZONE, THE SOUTH LINE OF LOT 9925 BEARING N 89°38'14" W
 VERTICAL DATUM BASED ON NAVD-88 (2012)
 GEOID 18 WISCONSIN
 STARTING BENCHMARK:
 NGS MONUMENT PID: DQ4987
 PUBLISHED ELEVATION: 1,048.3'

ORDER NO: 35799
 FIELD CREW: BMR
 DRAWN BY: BMR
 SHEET 1 OF 1

FOR THE EXCLUSIVE USE OF:
 Ryan Mackay c/o Mackay Builders, LLC
 187 Conference Point Road
 Williams Bay, WI 53191

PLAT OF SURVEY WITH TOPOGRAPHIC MAPPING
 FOR
 N3224 SATINWOOD ROAD
 LAKE GENEVA, WISCONSIN

Batterman
 engineers surveyors planners
 BELOIT | ELKHORN | JANESVILLE
 2857 S. Bartells Dr., Beloit, WI 53511
 608.365.4464 | www.rhbatterman.com

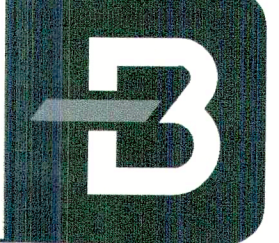

JLCB-2142 27-5303