

FARRIS, HANSEN & ASSOCIATES, INC.

ENGINEERING — ARCHITECTURE — SURVEYING
7 RIDGWAY COURT — P.O. BOX 437 — ELKHORN, WISCONSIN 53121
PHONE: (262) 723-2098 FAX: (262) 723-5886

PLAT OF SURVEY

LOTS 5 AND 6 OF BLOCK 2 OF PLAT OF
FRANK JANUTKAS LAKE VIEW SUBDIVISION.
LOCATED IN THE SW 1/4 OF THE NW 1/4 OF
SECTION 31, TOWN 2 NORTH, RANGE 17 EAST,
WALWORTH COUNTY, WISCONSIN; EXCEPTING
THEREFROM LANDS CONVEYED TO THE STATE OF
WISCONSIN ON DOCUMENT NO. 564907.

ASSIGNED SOUTH LINE WHITE OAK STREET
N 90°00'00" E

— WORK ORDERED BY —
SHIRLEY GRENON TRUST
C/O KEEFE REAL ESTATE
LAKE GENEVA, WI.

LEGEND

- = FOUND IRON PIPE STAKE
- = FOUND IRON REBAR STAKE
- △ = FOUND PK NAIL
- (XXX) = RECORDED AS

AREA = 21,000 S.F. 0.48 AC.

NOTE: COPIES OF THIS MAP TO WHICH THE FOLLOWING CERTIFICATE WILL APPLY SHOW
THE SURVEYOR'S ORIGINAL SEAL AND SIGNATURE IN RED INK. COPIES BY ANY OTHER
MEANS MAY HAVE ALTERATIONS WHICH DO NOT REPRESENT THE SURVEYOR'S WORK
PRODUCT.

I HEREBY CERTIFY THAT THE ABOVE DESCRIBED PROPERTY HAS BEEN SURVEYED UNDER
MY DIRECTION AND THAT THE ABOVE MAP IS A TRUE REPRESENTATION THEREOF AND
SHOWS THE SIZE AND LOCATION OF THE PROPERTY, ITS EXTERIOR BOUNDARIES, THE
LOCATION OF ALL VISIBLE STRUCTURES, AND DIMENSIONS OF ALL PRINCIPLE
BUILDINGS THEREON, BOUNDARY FENCES, APPARENT EASEMENTS, ROADWAYS, AND
VISIBLE ENCROACHMENTS, IF ANY. THIS SURVEY IS MADE FOR THE USE OF THE
PRESENT OWNERS OF THE PROPERTY, AND ALSO THOSE WHO PURCHASE, MORTGAGE, OR
GUARANTEE THE TITLE THERETO WITHIN ONE YEAR FROM THE DATE HEREOF.

DATED: MAY 1, 2013

PETER S. GORDON

STATE TRUNK HIGHWAY "67"

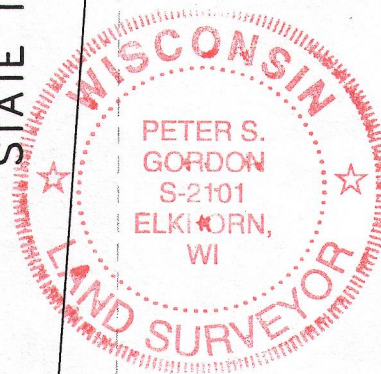

LANDS DEDICATED TO THE PUBLIC
ON DOC. NO. 564907

LOT 6

LOT 5

⊕ OLD CONCRETE LID

WHITE OAK STREET

(40' WIDE ROW)

N 90°00'00" E
99.69' (100')

25' BUILDING
SETBACK
PER ORIGINAL
SUB. PLAT

COVERED ENTRY

STOOP

GAS METER

EL. METER

EXISTING
RESIDENCE

ELEVATED
DECK

AC UNIT

ALUMINUM
SHED

EXISTING
GARAGE

OLD WOOD SHED

EXISTING
BUILDING



PROJECT: 8785
DATE: 05-01-2013
SHEET 1 OF 1

MAP SCALE IN FEET ORIGINAL 1" = 20'

MAY 06 2013

JLAV-10
JLAV-11

217-3858

X:\Projects\8785\docd\survey 5/6/2013