

PLAT OF SURVEY

UNIT 25-01 OF GENEVA NATIONAL CONDOMINIUM NO. 25, LOCATED IN THE SW 1/4 OF THE SE 1/4 AND SE 1/4 OF THE SW 1/4 OF SECTION 29, TOWN 2 NORTH, RANGE 17 EAST, WALWORTH COUNTY, WISCONSIN.

EXISTING TOP OF FOUNDATION = 101.6'
PROPOSED TOP OF GARAGE FLOOR = 100.5'
PROPOSED FINAL YARD GRADE = 100.00'

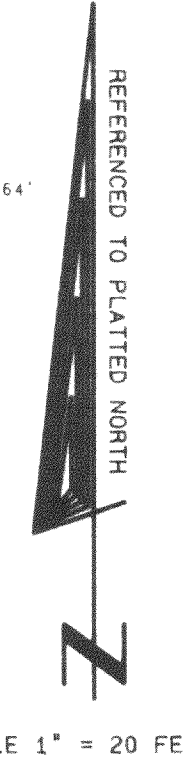
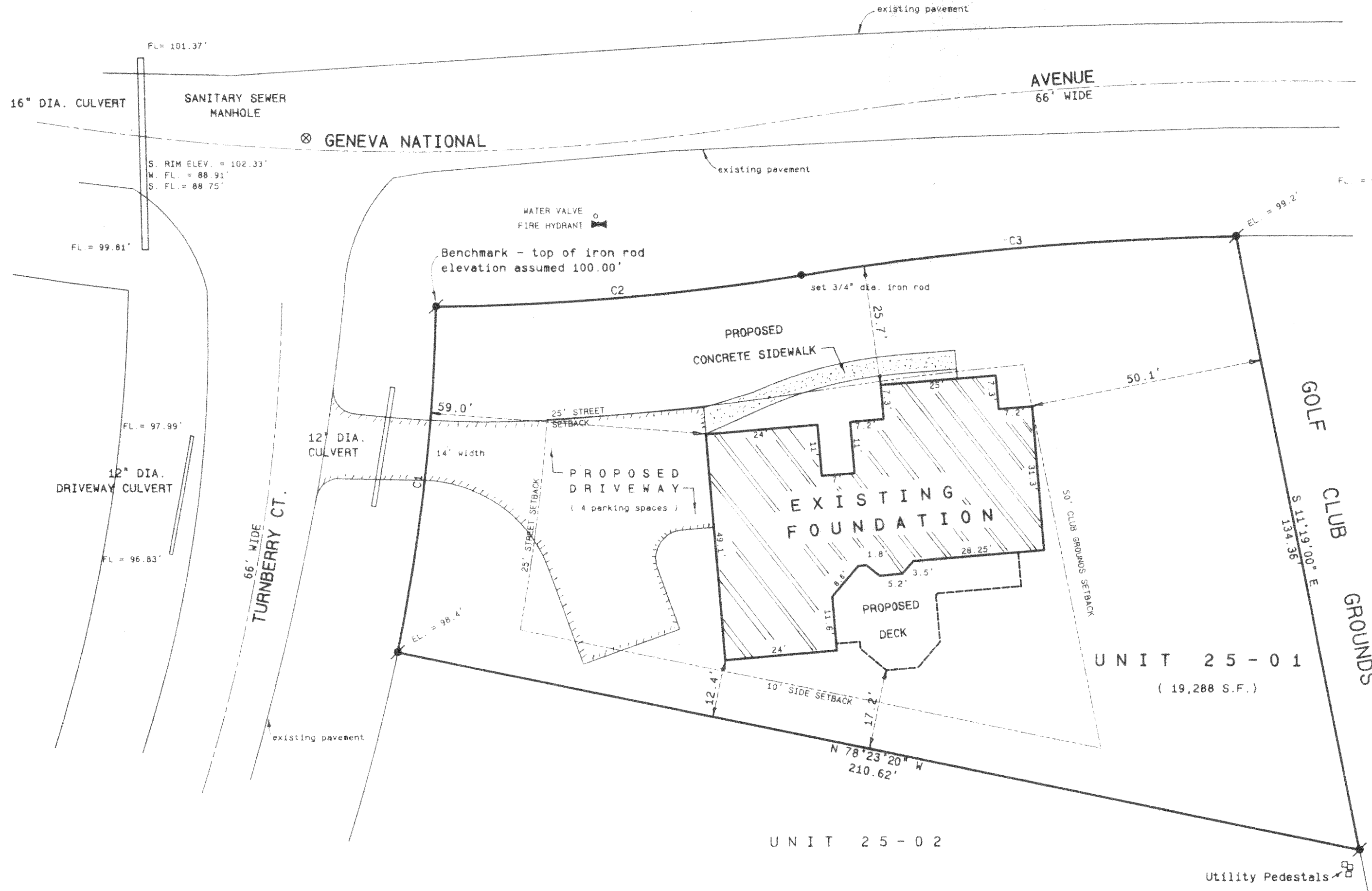

- Legend**
- FOUND IRON PIPE
 - FOUND IRON ROD
 - FOUND BRASS CAPPED MONUMENT
 - ⊗ FOUND CONCRETE MONUMENT
 - + CHISEL CUT IN CONCRETE
 - SET IRON ROD, 24" LONG, WEIGHING 1.5 LBS. LINEAL FT., 3/4" DIA.
 - SET IRON ROD, 30" LONG, WEIGHING 4.5 LBS. LINEAL FT., 1-11/16" DIA.
 - (XX) RECORDED AS DIMENSION
 - - - - - EXISTING FENCE

ORDERED BY: EMERALD BUILDERS
P.O. BOX 487
WILLIAMS BAY, WI 53191

CLIENT REFERENCE: RICHARD A STROM

CURVE	ARC	DELTA	RADIUS	CHORD LENGTH	CHORD BEARING
C1	75.00	10°31'56"	408.00	74.89	N 6°20'42" E
C2	78.64	8°27'11"	533.00	78.56	N 85°08'21" E
C3	93.83	8°03'36"	667.00	93.75	N 84°56'33" E

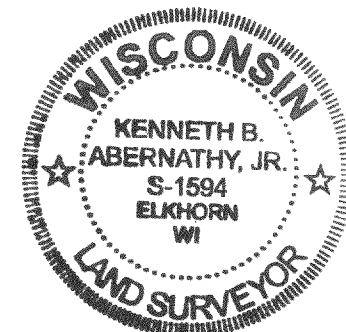
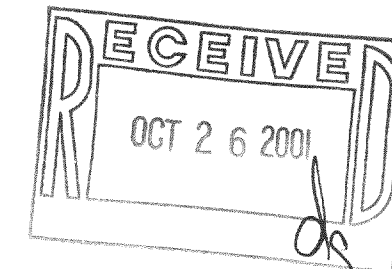

SCALE: 1" = 20 FEET

REVISED 5/02/01 ADDITIONAL INFORMATION
REVISED 6/24/01 NEW RESIDENCE PLAN
REVISED 10/11/01 FOUNDATION "AS BUILT"

I hereby certify that the above described property has been surveyed by me or under my direction and that the above map is a true representation thereof and shows the size and location of the property, its exterior boundaries, the location of all visible structures and dimensions of all principal buildings thereon, boundary fences, adjacent easements, roadways and visible encroachments, if any.
This survey is made for the use of the present owners of the property, and also those who purchase, mortgage, or guarantee the title thereto within one year from date hereof.

Kenneth B. Abernathy, Jr.
KENNETH B. ABERNATHY, JR.
WISCONSIN REGISTERED LAND SURVEYOR,
S-1594

Date: APRIL 3, 2001 Job No. 01305

560 25-11

217-2197