

PLAT OF SURVEY

UNIT 3-39
GENEVA NATIONAL CONDOMINIUM
NO. 3
LOCATED IN TOWN 2 NORTH, RANGE 17 EAST
WALWORTH COUNTY, WISCONSIN

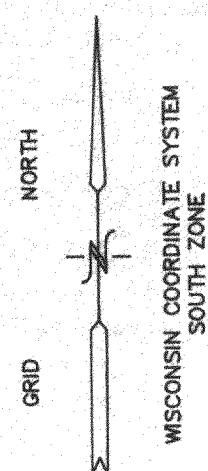

SET THIS "X" ON
UTIL. BOX

SARATOGA LANE
66' PRIVATE ROADWAY

UNIT 3-40

UNIT 3-35

UNIT 3-36

UNIT 3-37

UNIT 3-38

UNIT 3-39
17,013 S.F.

- LEGEND
- = FOUND IRON REBAR STAKE
 - = SET STEEL PIN W/CAP
 - (xxx) = RECORDED AS

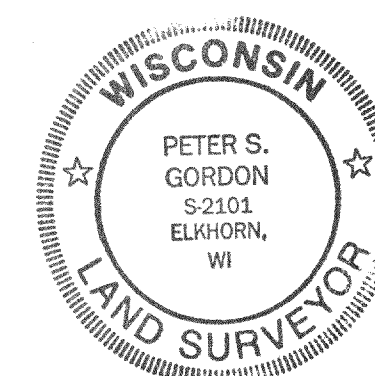

NOTE: COPIES OF THIS MAP TO WHICH THE FOLLOWING CERTIFICATE WILL APPLY ARE BLUE LINE PRINTS SHOWING SURVEYOR'S ORIGINAL SEAL AND SIGNATURE IN BLACK INK. COPIES BY ANY OTHER MEANS MAY HAVE ALTERATIONS WHICH DO NOT REPRESENT THE SURVEYOR'S WORK PRODUCT.

I HEREBY CERTIFY THAT THE ABOVE DESCRIBED PROPERTY HAS BEEN SURVEYED UNDER MY DIRECTION AND THAT THE ABOVE MAP IS A TRUE REPRESENTATION THEREOF AND SHOWS THE SIZE AND LOCATION OF THE PROPERTY AND ITS EXTERIOR BOUNDARIES. THIS SURVEY IS MADE FOR THE USE OF THE PRESENT OWNERS OF THE PROPERTY, AND ALSO THOSE WHO PURCHASE, MORTGAGE, OR GUARANTEE THE TITLE THERETO WITHIN ONE YEAR FROM THE DATE HEREOF.

DATED: 6-9-97

Peter S. Gordon
PETER S. GORDON R.L.S. 2101

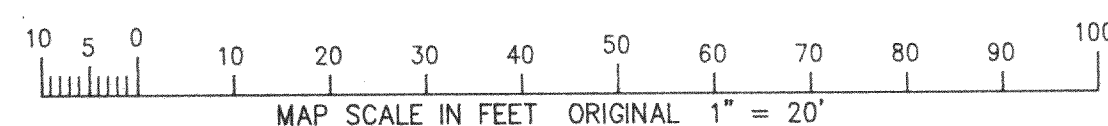
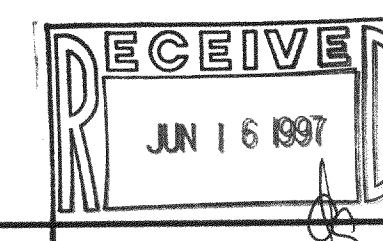

WORK ORDERED BY
KEEFE REAL ESTATE, INC.
704 MAIN STREET
LAKE GENEVA, WI 53147

FARRIS, HANSEN & ASSOCIATES, INC.
Engineering, Architecture, Surveying
7 Ridgeway Court P.O. Box 437
ELKHORN, WISCONSIN 53121
Office: (414) 723-2098
Fax: (414) 723-5886

REVISIONS

PROJECT NO.
3269.3-39
DATE:
5/9/97
SHEET NO.
1 OF 1