

Delavan

Lake

Plat of Survey

of

Lot 12 of Lakewood Estates,

a subdivision located in the Northeast 1/4, Southeast 1/4, Southwest 1/4
& Northwest 1/4 of the Southwest 1/4 of Section 21, Town 2 North, Range
16 East, Town of Delavan, Walworth County, Wisconsin.

Surveyed for: **Keefe Real Estate, Inc.**

416 Bauer Parkway
Delavan, Wisconsin. 53115

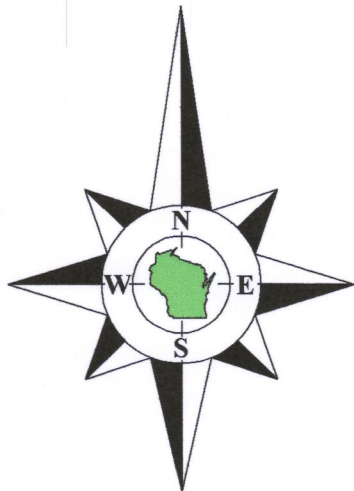

Bearings reference to the meander line of
Delavan Lake recorded as N61°49'40"E
on the plat of Lakewood Estates.

Lot 11

Lot 12 Tax Parcel FLE 00012

0.724 Acre
31,517 Sq.Ft.

House
No. 1928

Lot 13

Notes:

A) This dashed line is the meander line of Delavan Lake and is also
labelled "Building Line" on the plat of Lakewood Estates. The
extension of the screen porch on this lot over the line has been
approved by the Town of Delavan & the Lakewood Estates Association.

Copyright© 2017 by Olson Land Surveying, LLC.

All rights reserved. No part of this survey plat may be reproduced or transmitted in
any form by any means - graphic, electronic, or mechanical, including photocopying,
tracing, or information storage and retrieval systems - without permission in writing
from Douglas G. Olson, Olson Land Surveying, LLC.

I hereby certify that I have surveyed the above described property in compliance
with Chapter A-E 7 of the Wisconsin Administrative Code and that the map hereon is
correct to the best of my professional knowledge and belief and shows the size and
location of the property, its exterior boundaries, the location and dimensions of all
visible structures thereon, boundary fences, apparent easements and roadways and
visible encroachments, if any.

This survey is made for the exclusive use of the present owners of the property,
and also those who purchase, mortgage or guarantee title thereto, within one year from
the date hereof.

Douglas G. Olson
Wisconsin Professional Land Surveyor - 2093

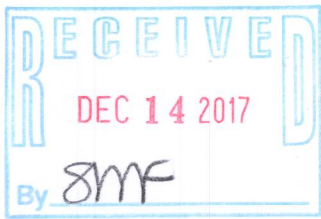

Notes:

- 1) This Plat of Survey is not certified unless
signed and sealed in red ink.
- 2) This survey is subject to Wisconsin lien laws.
This Plat of Survey is the notice of intent
to file lien. Lien waiver required.
- 3) The Survey Date shown on this Plat of Survey
is the completion date of the field work.

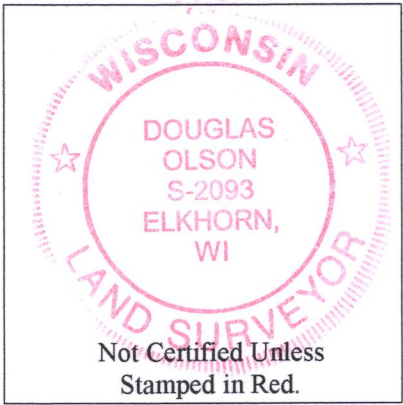

Sheet 1 of 1 Sheets

Drawing Name:

Job Reference Number
2017.101

Legend of Symbols & Abbreviations

- Found Concrete Monument
- Found Iron Pipe
- Recorded Information
- Utility Pedestal
- Manhole
- Lamp
- Asphalt Surface
- Concrete Surface
- Stone Patio

- N North
- S South
- E East
- W West
- In Bearings
- ° Degrees
- ' Minutes
- " Seconds
- In Distances
- Feet
- Inches



45 South Wisconsin Street | P.O. Box 322
Elkhorn, Wisconsin. 53121
Telephone: (262) 723-3434
Facsimile: (262) 723-8044
Email: doug@olsonsurveying.com
Website: www.olsonsurveying.com

Scale in Feet
1" = 20'

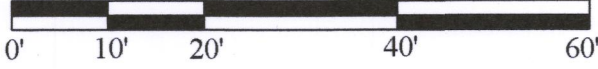

Survey Date: September 12, 2017.

Revisions:

2017.101

FLE-12

216-5443