

Bearings reference to the Wisconsin State Plane Coordinate System, South Zone.

Plat of Survey

of

Lot 4 in Block N of Delavan Lake Assembly Grounds,

a subdivision located in the Southeast 1/4 of Section 21, Town 2 North,
Range 16 East, Town of Delavan, Walworth County, Wisconsin.

Surveyed for: **Cook Contruction & Design, LLC**
1407 Racine Street - Suite C
Delavan, Wisconsin. 53115

Notes:

Curved street lines are not adequately dimensioned on the plat of Delavan Lake Assembly Grounds. Lines are shown as scaled from the recorded plat.

Survey Date: August 17, 2012.
Revisions: No. 1 - Proposed 2nd Floor Addition

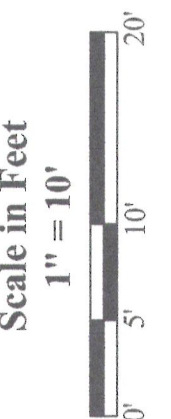

Jensen & Olson Land Surveying, LLC

45 South Wisconsin Street * P.O. Box 322 * Elkhorn, Wisconsin. 53121
Telephone: (262) 723-3434 * Facsimile: (262) 723-8044
Email: jensen.olson@elknet.net

Legend
Found County Section Corner
Found Iron Rod
Found Railroad Spike
Found P.K. Nail
Recorded Information
Utility Pole
Asphalt Surface
Concrete Surface
Gas Meter
Lamp
Gravel

Sheet 1 of 1 Sheets
Drawing Name: Carl (6-2012097-2012097) Plat.sgi
Job Reference Number
2012.097

2012.097

Center 1/4 Corner
Section 21-2-16.
N. 228,547.68
E. 2,374,253.11

Lot 2

Lot 16

(N88°41'12"E 1199.33') State Plane
N88°41'12"E 1199.46'
North line of the Southeast 1/4 of Section 21-2-15.

Meander Corner
Section 21-2-16.
(N. 228,575.17)
(E. 2,375,452.09)

Lot 3 House

Lot 4
Tax Parcel
FDLA 00134
0.056 Acre
2,424 Sq.Ft.

Deck

House
No. 1108

Proposed
2nd Floor
Addition

Sioux Avenue
(Lowell Avenue)
N81°53'40"W 30.21'
(15' Wide)

Lot 5

Lot 14

Lot 15

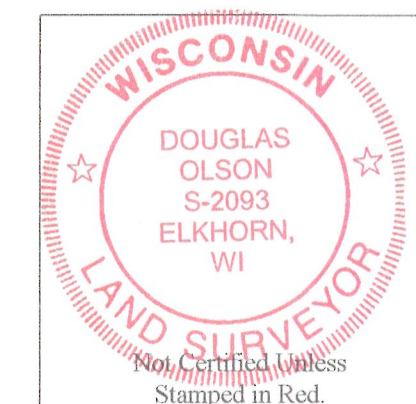

Notes:

- 1) This survey plat is not certified unless signed and sealed in red ink.
- 2) This survey is subject to Wisconsin lien laws. This Plat of Survey is the notice of intent to file lien. Lien waiver required.

Copyright 2012 by Jensen & Olson Land Surveying, LLC.

All rights reserved. No part of this survey plat may be reproduced or transmitted in any form by any means - graphic, electronic, or mechanical, including photocopying, tracing, or information storage and retrieval systems - without permission in writing from Douglas G. Olson, Jensen & Olson Land Surveying, LLC.

I, Douglas G. Olson, Wisconsin Registered Land Surveyor, do hereby certify that this survey was performed by me, or under my direction in full compliance with the owner's/agent's instructions and Chapter A-E 7 of the Wisconsin Administrative Code "Minimum Standards for Property Surveys"; and that this map is an accurate representation thereof to the best of my knowledge and belief.

Douglas G. Olson
Wisconsin Registered Land Surveyor - 2093

FDLA-134

216-4980