

1140 SEQUOIA STREET • DELAVAN, WISCONSIN 53115
262-728-6737

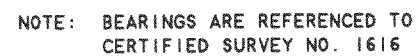

SCALE 1" = 30'

LEGEND

- - IRON PIPE FOUND
 △ - UTILITY POLE
 □ - UTILITY PED
 ———— - OVERHEAD UTILITY LINES
 —XX—XX— - WIRE FENCE
 —X—X— - WOOD BOARD FENCE
 —XX—XX— - WOOD RAIL FENCE
 () - RECORDED AS

LOT 2, CERTIFIED SURVEY NO. 1616, LOCATED IN THE
NORTHEAST 1/4 OF SECTION 28, T2N,R16E, WALWORTH
COUNTY, WISCONSIN.

I HEREBY CERTIFY THAT I HAVE SURVEYED THE ABOVE DESCRIBED PROPERTY AND THAT THE ABOVE MAP IS A TRUE REPRESENTATION THEREOF AND SHOWS THE SIZE AND LOCATION OF THE PROPERTY, ITS EXTERIOR BOUNDARIES, THE LOCATION OF ALL VISIBLE STRUCTURES AND DIMENSIONS OF ALL PRINCIPAL BUILDINGS THEREON, BOUNDARY FENCES, APPARENT EASEMENTS, ROADWAYS AND VISIBLE ENCROACHMENTS, IF ANY, TO THE BEST OF MY KNOWLEDGE AND BELIEF.

THIS SURVEY IS MADE FOR THE USE OF THE PRESENT OWNERS OF THE PROPERTY, AND ALSO THOSE WHO PURCHASE, MORTGAGE, OR GUARANTEE THE TITLE THERETO WITHIN ONE (1) YEAR FROM DATE HEREON.

Daniel F. Phil

DAVID F. ABELL
WISCONSIN REGISTERED LAND SURVEYOR, S-1596

July 7, 2005

DATE 1/17/80 JOB NUMBER - 05080
NOTE: THIS IS NOT A CERTIFIED COPY UNLESS SEALED.

ORDERED BY: BRIAN SCHUK
WASSEL LAW OFFICE
1034 ANN STREET
DELAVER, WI 53115

REVISÉ: OCTOBER 14, 2005

FA1616-2

216 - 4131