

3/9/2005 X:\Projects\4788\accd\LOT_2

LINE	BEARING	DISTANCE
L1	S 65°09'22" W	72.24'

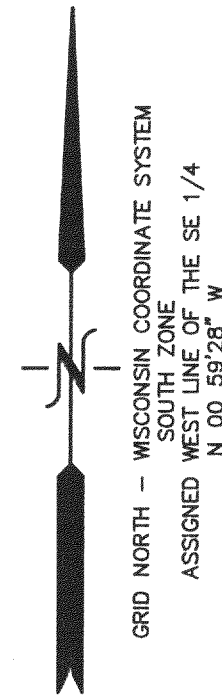
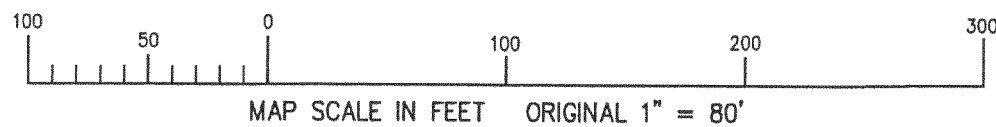

LOT 1 OF C.S.M. 3398

N 31°46'36" E
653.00'

LOT 2
393,090 S.F.
9.02 AC.

WETLAND PRESERVATION &
NATURAL PROTECTION EASEMENT AREA

N 38°59'50" E 597.15'
467.85'

LIMITED BUILDING
SITE

SOIL
BORINGS

AS BUILT
RESIDENCE

LOT 3 OF C.S.M. 3398

N 61°05'02" W
653.41'

LOT 4 OF C.S.M. 3398

N 00°51'19" E
427.23'

66' WIDE ACCESS & UTILITY
EASEMENT FOR LOTS 2 & 3

STATE TRUNK HIGHWAY "11"
100' WIDE R.O.W.

PLAT OF SURVEY PERMIT PLAT

LOT 2 OF C.S.M. 3398

LOCATED IN PART OF THE NW 1/4 AND SW 1/4 OF THE SE 1/4 OF
SECTION 3, TOWN 2 NORTH, RANGE 16 EAST, WALWORTH COUNTY, WISCONSIN

LEGEND
● = FOUND IRON REBAR STAKE
(XXX) = RECORDED AS

NOTE: COPIES OF THIS MAP TO WHICH THE FOLLOWING CERTIFICATE
WILL APPLY SHOW THE SURVEYOR'S ORIGINAL SEAL AND SIGNATURE
IN RED INK. COPIES BY ANY OTHER MEANS MAY HAVE ALTERATIONS
WHICH DO NOT REPRESENT THE SURVEYOR'S WORK PRODUCT.

I HEREBY CERTIFY THAT THE ABOVE DESCRIBED PROPERTY HAS BEEN
SURVEYED UNDER MY DIRECTION AND THAT THE ABOVE MAP IS A TRUE
REPRESENTATION THEREOF AND SHOWS THE SIZE AND LOCATION OF
THE PROPERTY AND ITS EXTERIOR BOUNDARIES. THIS SURVEY IS
MADE FOR THE USE OF THE PRESENT OWNERS OF THE PROPERTY, AND
ALSO THOSE WHO PURCHASE, MORTGAGE, OR GUARANTEE THE TITLE
THERE TO WITHIN ONE YEAR FROM THE DATE HEREOF.

DATED: AUGUST 31, 2004

REVISED 03-09-2005
TO SHOW SIZE & LOCATION OF
AS BUILT RESIDENCE

PETER S. GORDON R.L.S. 2101

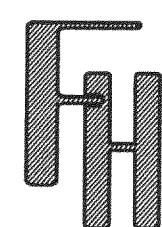

WORK ORDERED BY -
KEN RYER - KIR BUILDERS
N1495 RYER COURT
WALWORTH, WI 53184
JASON & RACHEL HICKS RESIDENCE

FARRIS, HANSEN & ASSOCIATES, INC.
ENGINEERING - ARCHITECTURE - SURVEYING
7 RIDGWAY COURT P.O. BOX 437
ELKHORN, WISCONSIN 53121
OFFICE: (262) 723-2098 FAX: (262) 723-5886

REVISIONS

PROJECT NO.
4788_02
DATE:
08/31/04
SHEET NO.
1 OF 1

216-3979

FA 3398-2