

PLAT OF SURVEY

Parcel "A"

Legal Description
Volume 25, Page 445
Document Number 622990

More particularly described as follows:

A parcel of land located in part of the Northwest 1/4 of the Southwest 1/4 of Section 9, Town 2 North, Range 16 East, Town of Delavan, County of Walworth, State of Wisconsin, described as follows:

Begin at a Found Brass Capped Walworth County Monument at the West 1/4 Corner of said Section 9; thence N 88°20'14" E along the East-West 1/4 Line of said Section 9 1317.11 feet to the North-South 1/8 Line of Southwest 1/4 of Section 9; thence S 1°40'07" E along said North-South 1/8 Line 737.88 feet to the point of beginning; thence continue S 1°40'07" E 255.50 feet to an Iron Rod on the Northwestern Right-of-way Line of State Trunk Highway "11"; thence S 55°09'22" W along said Right-of-way Line 559.28 feet to an Iron Rod; thence N 34°37'17" W 220.44 feet to a Found Iron Pipe; thence N 55°32'45" E 472.63 feet to a Found Iron Pipe; thence S 0°23'25" E 216.64 feet to a Found Iron Pipe; thence N 56°33'51" E 28.41 feet to a Found Iron Pipe; thence S 12°09'40" E 32.17 feet to a Found Iron Pipe; thence N 57°07'07" E 198.76 feet to the point of beginning. Said parcel contains 5.47 Acres of land more or less.

Owner: Delores M. Isola

Legal Description
Volume 634, Page 553

Parcel "A"

Owners: Marilyn L. Jacobsen
Ralph E. Ragland
Marjorie C. Buck
Alice C. Bergeron

Parcel "B"
(Exception)

Owners: Gerald F. & Lois F. Griffin

1.12 Acres ±

Parcel "B"

Legal Description
Volume 72, Page 731
Document Number 651579

More particularly described as follows:

A parcel of land located in part of the Northwest 1/4 of the Southwest 1/4 of Section 9, Town 2 North, Range 16 East, Town of Delavan, County of Walworth, State of Wisconsin, described as follows:

Begin at a Found Brass Capped Walworth County Monument at the West 1/4 Corner of said Section 9; thence N 88°20'14" E along the East-West 1/4 Line of said Section 9 1317.11 feet to the North-South 1/8 Line of Southwest 1/4 of Section 9; thence S 1°40'07" E along said North-South 1/8 Line 481.91 feet to an Iron Rod and the point of beginning; thence continue S 1°40'07" E 255.97 feet to a point in the base of a tree; thence S 57°07'07" W 198.76 feet to a Found Iron Pipe; thence N 12°09'40" W 32.17 feet to a Found Iron Pipe; thence S 56°33'51" W 28.41 feet to a Found Iron Pipe; thence N 0°23'25" W 216.64 feet to a Found Iron Pipe; thence N 55°32'45" E 232.15 feet to the point of beginning. Said parcel contains 1.12 Acres of land more or less.

NOTE

Horizontal Datum is based on the Wisconsin State Plane Coordinate System Grid, South Zone, and all bearings are referred to Grid North.

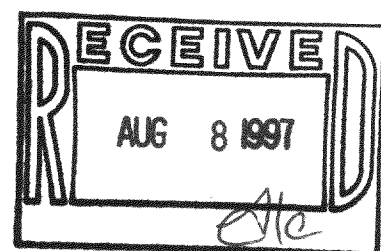

Legend

- FOUND IRON PIPE
- FOUND IRON ROD
- FOUND BRASS CAPPED MONUMENT
- FOUND CONCRETE MONUMENT
- CHISEL CUT IN CONCRETE
- SET IRON ROD, 24" LONG, WEIGHING 1.5 LBS./LINEAL FT., 3/4" DIA.
- SET IRON ROD, 36" LONG, WEIGHING 4.5 LBS./LINEAL FT., 1-1/16" DIA.
- RECORDED AS DIMENSION
- EXISTING FENCE

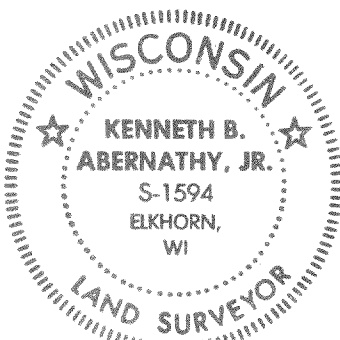

SCALE: 1" = 50 FEET

I hereby certify that the above described property has been surveyed by me or under my direction and that the above map is a true representation thereof and shows the size and location of the property, its exterior boundaries, the location of all visible structures and dimensions of all principal buildings thereon, boundary fences, apparent easements, roadways and visible encroachments, if any.

This survey is made for the use of the present owners of the property, and also those who purchase, mortgage, or guarantee the title thereto, within one year from date hereof.

Kenneth B. Abernathy, Jr.
WISCONSIN REGISTERED LAND SURVEYOR,
S-1594

Date: July 28, 1997 Job No. 1997.302

FD-9-SB
FD-9-SA
216-2513